



SKT40G



SKT60G



SKT80G

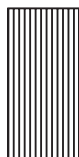

SKT40GR

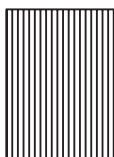

SKT60GR

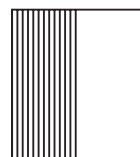

SKT80GLR

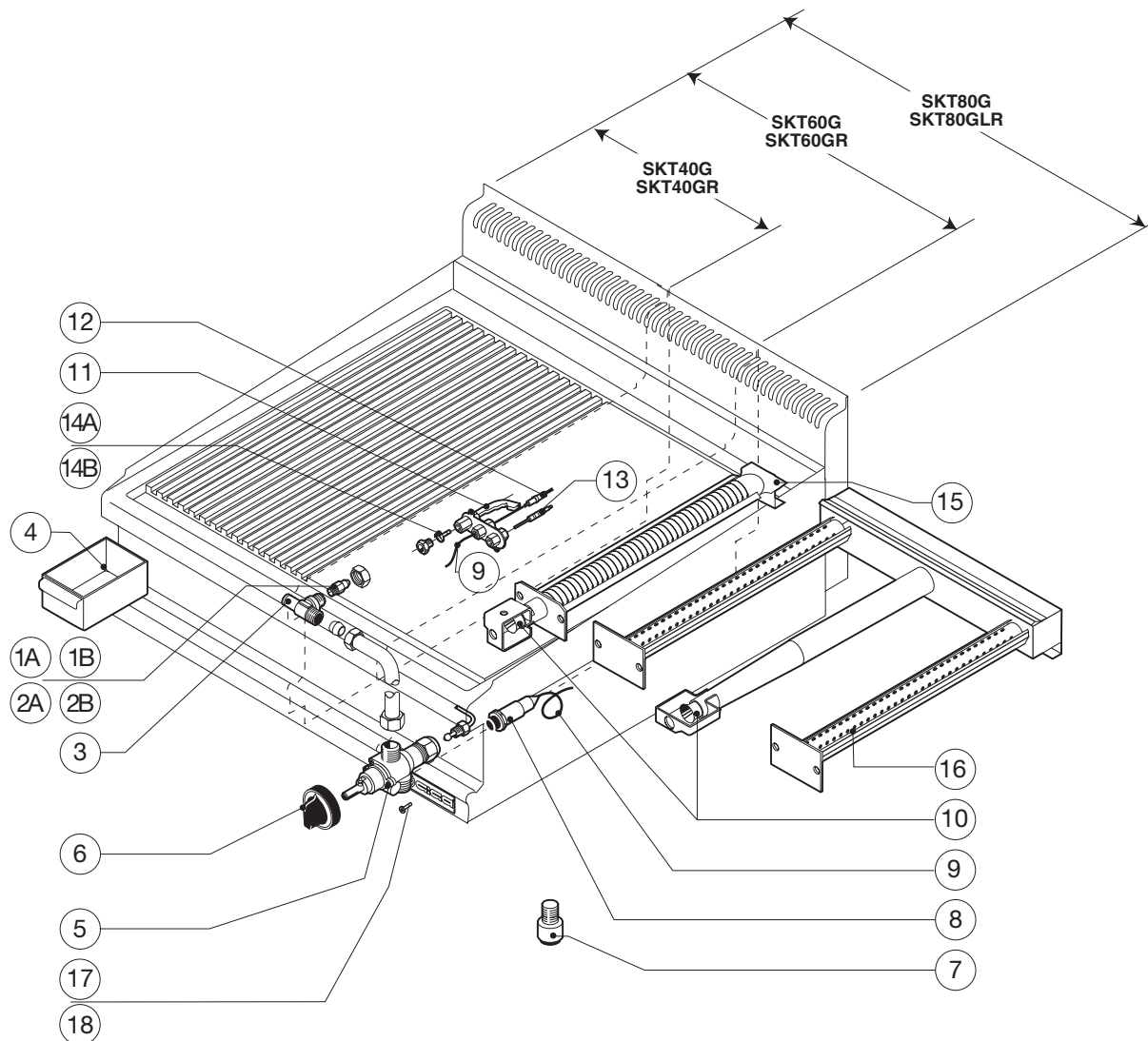

A = GPL / LP gas / Gaz liquide / Flüssiggas (2H)
 B = Gas metano / Natural gas / Gaz naturel / Erdgas (3+)

| Pezzi/Pieces Pieces/Anzahl | | | Pos. | Validità dalla matricola Validity from serial number Validité du numéro matricule Gültigkeit ab der (Seriennummer) | Validità alla matricola Validity up to serial number Validité au numéro matricule Gültigkeit bis zur (Seriennummer) | Codice Code Artikel Nummer | Descrizione | Description | Description | Beschreibung |
|-------------------------------|-------------------|--------------------|------|---|--|-------------------------------------|-------------------------|----------------------------|-----------------------------|---------------------------|
| SKT40G SKT40GR | SKT60G SKT60GR | SKT80G SKT80GLR | | | | | | | | |
| 1 | | 2 | 1A | | | X34000 | Iniettore GPL | LPG injector | Injecteur GPL | Gasdüse GPL |
| 1 | | 2 | 1B | | | X35200 | Iniettore metano | Natural gas injector | Injecteur methane | Gasdüse methan |
| | 1 | | 2A | | | X34700 | Iniettore GPL | LPG injector | Injecteur GPL | Gasdüse GPL |
| | 1 | | 2B | | | X36000 | Iniettore metano | Natural gas injector | Injecteur methane | Gasdüse methan |
| 1 | 1 | 2 | 3 | | | 0000X16100 | Porta iniettore | Injector-holder | Porte-injecteur | Düsenträger |
| 1 | 1 | 1 | 4 | | | B12100 | Cassetto raccogliughi | Deep fat tray | Tiroir de recueil des jus | Fettauffangwanne |
| 1 | | 2 | 5 | | | X08100 | Rubinetto fuoco | Gas ring cock | Robinet feu | Gashan kochstelle |
| 1 | 1 | 2 | 6 | | | 0000Y65103 | Manopola per fuoco | Gas ring knob | Cle de commande pour feu | Drehknopf für kochstelle |
| 4 | 4 | 4 | 7 | | | M06400 | Piedino | Foot | Pied | Fuss |
| 1 | 1 | 2 | 8 | | | M02100 | Piezo elettrico | Piezo-electric ignition | Piezo électrique | Piezoelektrischer Zünder |
| 1 | 1 | 2 | 9 | | | X40100 | Cavo A.T. L. 400 | H.T. Cable l. 400 | Cable H.T. L. 400 | Hochspannungsk. Länge 400 |
| 1 | 1 | 2 | 10 | | | X20200 | Boccola registro aria | Air-regulation bush | Douille de réglage de l'air | Luftreglerbuchse |
| 1 | 1 | 2 | 11 | | | X13000 | Pilota | Pilot | Veilleuse d'allumage | Zündflammenbrenner |
| 1 | 1 | 2 | 12 | | | X13001 | Candeletta | Ignition plug | Bougie | Glühkerze |
| 1 | 1 | 2 | 13 | | | X14200 | Termocoppia | Thermocouple | Thermocouple | Thermoelement |
| 1 | 1 | 2 | 14A | | | X30000 | Iniettore pilota GPL | LPG pilot injector | Injecteur pilote GPL | Pilotdüse GPL |
| 1 | 1 | 2 | 14B | | | X30100 | Iniettore pilota metano | Natural gas pilot injector | Injecteur pilote methane | Pilotdüse methan |
| 1 | | 2 | 15 | | | X20000 | Bruciatore | Burner | Bruleur | Brenner |
| | 1 | | 16 | | | X20100 | Bruciatore | Burner | Bruleur | Brenner |
| 1 | | 2 | 17 | | | X10600 | By Pass 0,90 | By Pass 0,90 | By Pass 0,90 | By Pass 0,90 |
| | 1 | | 18 | | | X09700 | By Pass 0,70 | By Pass 0,70 | By Pass 0,70 | By Pass 0,70 |