

E1808 DEEP FAT FRYER

FRYER FITMENTS

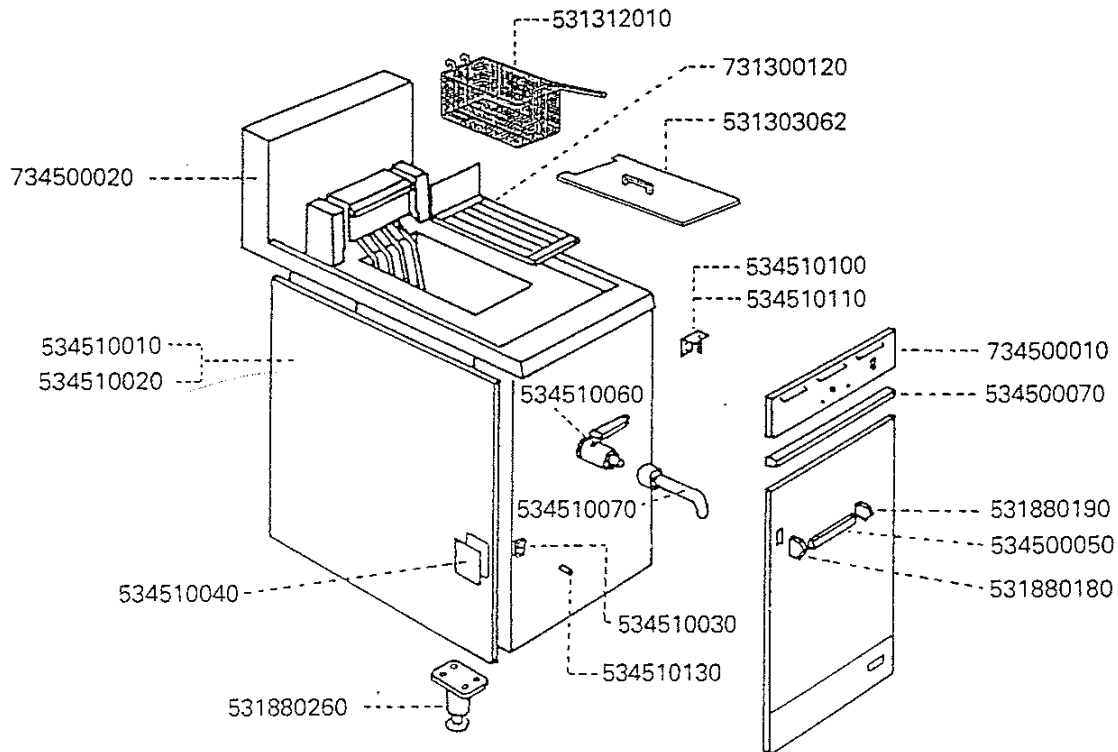

Code	No.	Description
D10	531303062	Dust Cover c/w Handle
E10	531312010	Chip Basket
B05	531313050	Dust Cover Handle
B05	531880180	Door Handle Bracket and Gasket (L.H.)
B05	531880190	Door Handle Bracket and Gasket (R.H.)
C09	531880260	Foot Assembly
M02	734500020	Hob and Pan
H09	534500040	Complete Door (Not Illustrated)
C08	534500050	Door Handle Bar
D05	734500010	Control Panel
D11	534500070	Front Trim
D12	731300120	Element Guard
F08	534510010	Outer Side Panel (L.H.)
F09	534510020	Outer Side Panel (R.H.)
B07	534510030	Door Catch
C05	534510040	Blanking Plate
E05	534510060	Drain Cock
C12	534510070	Drain Tube
C01	534510100	Door Top Hinge
C01	534510110	Door Bottom Hinge
B01	534510130	Door Keeper Stud

Sheet Reference Number

E1808/0192/001

**Falcon Catering
Equipment**
Commercial and institutional
catering equipment



Falcon Catering Equipment is a
business name of
Glynwed Consumer & Building Products Ltd
a member of the
Glynwed International plc
group of companies

E1808 DEEP FAT FRYER

FRYER CONTROLS

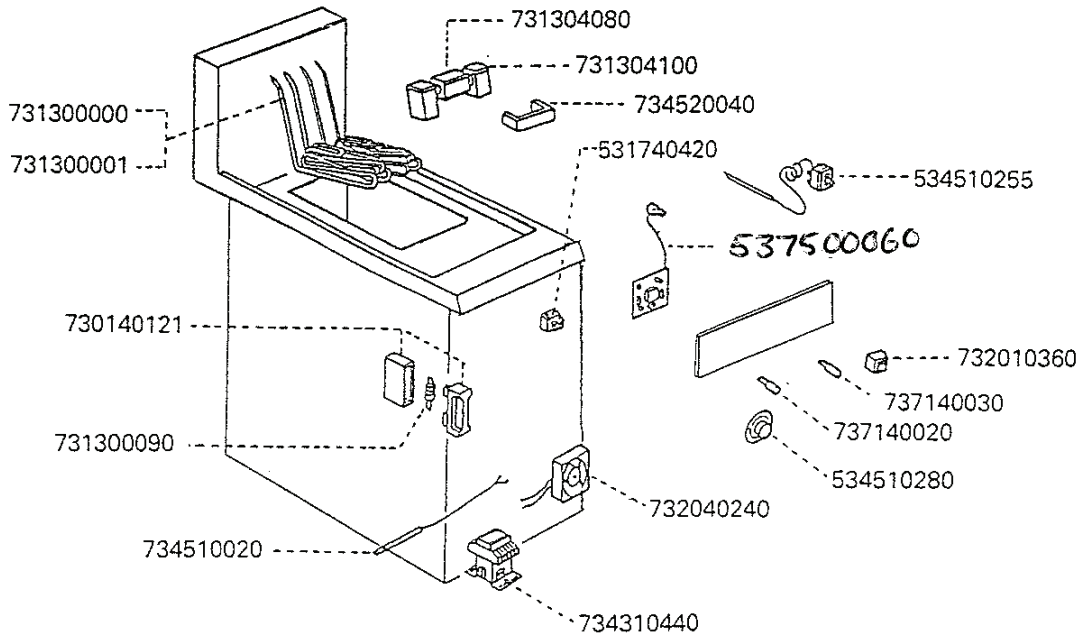

Code	No.	Description
G11	731300000	Element — 240V
G11	731300001	Element — 220V
J04	731300010	Set of Elements (2 per set) — 240V
J04	730130011	Set of Elements (2 per set) — 220V
G08	734310440	Contactors
B01	731300090	Fuse Link — 30A
C12	730140121	Fuse Carrier and Base — 20A
E01	734510020	Thermocouple
K11	537500060	Operating Thermostat <i>ASSY c/w pot PRE & POST EN203.</i>
G06	534510255	Safety Thermostat
B06	534510280	Control Knob
C02	732010360	On/Off Switch
G06	732040240	Fan
B07	531740420	Terminal Block
B07	737140020	Indicator Neon (Amber)
B07	737140030	Indicator Neon (Red)
G01	731304080	Element Box c/w Lid
E12	731304100	Support Box c/w Lid
B10	734520040	Basket Hanging Rail
D02	734500030	Microswitch (Not Illustrated) <i>a/s = 734520070</i>

Sheet Reference Number

E1808/0192/002

**Falcon Catering
Equipment**
Commercial and institutional
catering equipment



Falcon Catering Equipment is a
business name of
Glywedd Consumer & Building Products Ltd
a member of the
Glywedd International plc
group of companies