

KMG / 50

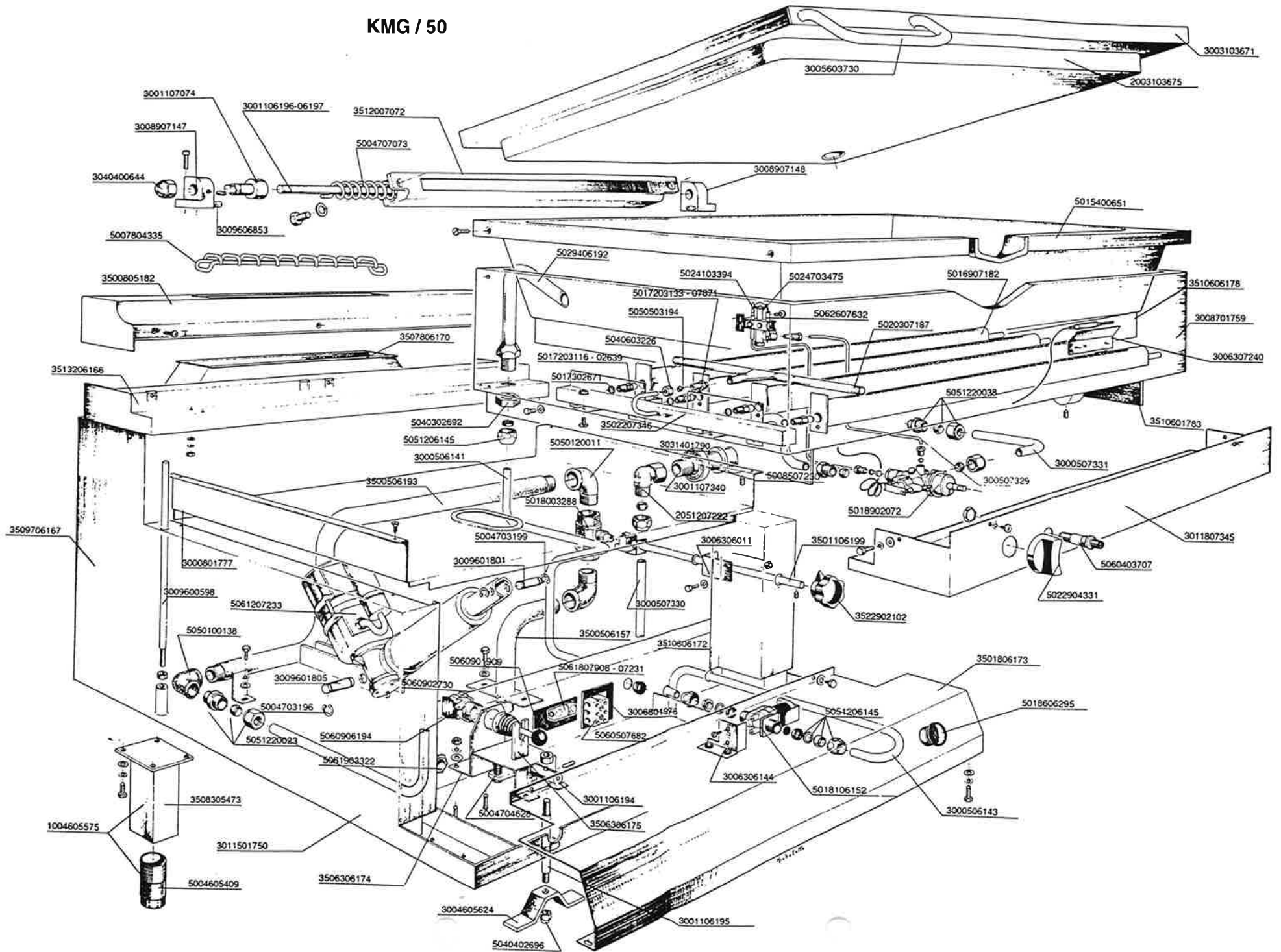

| | ERSATZTEILLISTE | LISTA PARTICOLARI | LIST OF PARTS | LIST DES COMPOSANTS | 26.C7.91 |
|------------|-----------------------------|-----------------------------|-----------------------------|----------------------------|----------------|
| | GAS-KIPPBRATPFANNE | BRASIERA ROV. GAS | GAS TILT. BRAISING PAN | SAUTEUSE BASC.GAZ | KMG/50 PAG. 1 |
| COD. | BESCHREIBUNG | DESCRIZIONE | DESCRIPTION | DESCRIPTION | QUANT. |
| 2003103675 | GEGENDECKEL | CONTROCOPERCHIO | COUNTER-COVER | COUVERCLE INTERNE | KB/50 1 |
| 2051207222 | WINKEL-GELENK 1/2">16 | RACCORDO GOMITO GIREV. | ELBOW FITTING GIREV.1/2">16 | RACCORD COUDE PIVOTAN. | KB/90 1 |
| 3000500612 | ROHR KLETTERFLAMME | CONDOTTA RAMPA ACC. | LIGHTING RAMP DUCT | CONDUITE PONT ALLU. | KMC/50 1 |
| 3000506141 | ROHR WASSEREINL. | TUBO ACQUA | WATER PIPE | TUYAU EAU | KB/50 1 |
| 3000506143 | ROHR WASSERANSCHL. | UBO ATTACCO ACQUA | WATER CONNECT.PIPE | TUYAU ARRIVEE EAU | KB/50 1 |
| 3000507079 | ROHR DISTANZ DECKEL | TUBO DISTANZ.COPER. | COVER SPACER TUBE | TUYAU ENTRETOI.CO.U. | KB/50/90 1 |
| 3000507329 | ROHR ZÜNDBRENNER | TUBO PILOTA | PILOT PIPE | TUYAU VEILLEUSE | KMG/50 1 |
| 3000507330 | ROHR DREHGELENK | TUBO RACCORDO GIR. | PIPE FITTG. SWIVEL | TUYAU RACCORD PIV. | KMG/50 1 |
| 3000507331 | ROHR VERBINDUNG | TUBO RACCORDO VALV. | VALVE PIPE FITTING | TUYAU RACCORD SOUP. | KMG/50 1 |
| 3000801773 | ABDECKUNG WANNE U. | COPERTURA VASCA INF. | COVER BOTTOM PAN | COUVERTURE CUVE INF. | KB/50 1 |
| 3000801777 | ABDECKUNG MOTOR O. | CRUSCOTTO MOTORE | MOTOR PANEL | TABLEAU MOTEUR | KB/50 1 |
| 3000804292 | ABDECKUNG SEITE L. | CRUSCOTTO LATER.S. | PANEL LH SIDE | TABLEAU COTE GCHE | G/85 1 |
| 3000806186 | ABDECKUNG VORNE | ISOLAZIONE ANTER. | INSULATION FRONT | ISOLATION AVANT | KMG/50 1 |
| 3000807339 | ABDECKUNG GASVENTIL | CRUSCOTTO VALVOLA | PANEL VALVE | TABLEAU SOUPAPE | KMG/50 1 |
| 3000808271 | ABDECKUNG SEITE R. | CRUSCOTTO LATER.D. | PANEL RH SIDE | TABLEAU COTE DROIT | G/85 1 |
| 3001006466 | ANSCHLAG WELLE | ARRESTO ASSE | SHAFT STOP | ARRET AXE | G/85 1 |
| 3001106194 | WELLE PEDAL | ASSE PEDALE | PEDAL SHAFT | AXE PEDALE | KB/50 1 |
| 3001106195 | HALTER PEDAL | SUPPORTO PEDALE | PEDAL SUPPORT | SUPPORT PEDALE | KB/50 1 |
| 3001106196 | WELLE FEDER L. | ASSE MOLLA SINISTR. | SHAFT LH SPRING | AXE RESSORT GAUCHE | KB/50/90 1 |
| 3001106197 | WELLE FEDER R. | ASSE MOLLA DESTRA | SHAFT RH SPRING | AXE RESSORT DROIT | KB/50/90 1 |
| 3001107074 | WELLE DECKELHUB | ASSE ALZACOPERCHIO | SHAFT COVER LIFT | AXE LEVE COUVERCLE | KB/50/90 1 |
| 3001107340 | WELLE KIPPUNG | ASSE RIBALTAMENTO | SHAFT TILTING | AXE BASCULEMENT | KMG/50 1 |
| 3001601751 | BODEN | FONDO | BOTTOM | FOND | KB/50 1 |
| 3001801758 | BLENDE ANSCHLUSS | PANNELLO ALLACCIAM. | CONNECTION PANEL | PANNEAU BRANCHEMEN. | KB/50 1 |
| 3003006177 | DISTANZSTÜCK TP.H. | DISTANZIALE PIANO | HOB SPACER | ENTRETOISE PLAN | KB/50 1 |
| 3003103671 | DECKEL DOPPELWAND. | COPERCHIO DOPPIO | DOUBLE COVER | COUVERCLE DOUBLE | KB/50 1 |
| 3004605432 | FUSS VIERKANTROHR | PIEDINO ESTERNO | FOOT EXTERNAL | PIED EXTERNE | G/85 4 |
| 3004605624 | PEDAL | PEDALE | PEDAL | PEDALE | KB/50 1 |
| 3005603730 | GRIFF DECKEL | MANIGLIA COPERCH. | COVER HANDLE | POIGNEE COUVERCL. | KB/50-KBH/70 1 |
| 3006306011 | HALTER WELLE | SUPPORTO ASSE | SHAFT SUPPORT | SUPPORT AXE | KMG/50 1 |
| 3006306144 | HALTER ELT.VENTIL | SUPPORTO EL.VALVOL. | SOL. VALVE SUPPORT | SUPPORT SOUPA.ELEC. | KB/50 1 |
| 3006306184 | HALTER BRENNER | SUPPORTO BRUCIATOR. | BURNER SUPPORT | SUPPORT BRULEUR | KMG/50 1 |
| 3006306329 | HALTER ZÜNDBRÜCKE | SUPPORTO ACCENS. | LIGHTING SUPPORT | SUPPORT ALLUMAGE | KMG/50 2 |
| 3006306453 | HALTER HAHN | SUPPORTO RUBINETTO | COCK SUPPORT | SUPPORT ROBINET | G/85 1 |
| 3006307240 | HALTER FÜHLER | SUPPORTO BULBO | PROBE SUPPORT | SUPPORT SONDE | KBG/90 1 |
| 3006701772 | ISOLIERBLECH I. | LAMIERA ISOLANTE INTERNA | INSUL. PLATE INNER | TOLE ISOLANTE INTERNE | KMG/50 1 |
| 3006801975 | ISOLIERPLATTE KLEIN 3-POLIG | ISOLAZIONE PICCOLA A 3 POLI | INSULATION SMALL 3-POLE | PETITE ISOLATION A 3 POLES | 1 |
| 3008306171 | TRÄGER FÜSSE H. | SUPPORTO PIEDI POST. | SUPPORT REAR FEET | SUPPORT PIEDS ARRIE. | KB/50 1 |
| 3008701759 | MANTEL WANNE V. | MANTELLI RIVESTIMENTO ANT. | COVER JACKET FRONT | MANTEAU REVETEMENT AVANT | KMG/50 1 |
| 3008706185 | MANTEL WANNE I. | MANTELLI INTERNO | JACKET INTERNAL | MANTEAU INTERNE | KB/50 1 |
| 3008907147 | LAGER DECKELHUB L. | SUPPORTO CERN.SIN. | HINGE SUPPORT LH | SUPPORT CHARN.GCHE | KB/50/90 1 |
| 3008907148 | LAGER DECKELHUB R. | SUPPORTO CERN.DES. | HINGE SUPPORT RH | SUPPORT CHARN.DRT. | KB/50/90 1 |
| 3009600598 | STIFT ANSCHLAG | PERNO BATTUTA | THRUST PIN | PIVOT BUTEE | KB/50 2 |

| COD. | BESCHREIBUNG | DESCRIZIONE | DESCRIPTION | DESCRIPTION | QUANT. |
|------------|----------------------|------------------------------|-----------------------------|------------------------|--------------|
| 3009601801 | STIFT MOTOR O | PERNO MOTORE SUPERIORE | MOTOR PIN TOP | PIVOT MOTEUR SUPERIEUR | KB/50 1 |
| 3009601805 | STIFT MOTOR U. | PERNO MOTORE INFERIORE | MOTOR PIN BOTTOM | PIVOT MOTEUR INFERIEUR | KB/50 1 |
| 3009606853 | STIFT ANSCHLAG DECK. | PERNO BATTUTA COP. | COVER THRUST PIN | PIVOT BUTEE COUVER. | KB/50/90 2 |
| 3010002581 | REGULIERBLECH LUFT | LAMIERA REGOLAZIONE | ADJUSTMENT PLATE | TOLE REGLAGE | GG 4 |
| 3011501750 | SEITENWAND LINKS | FIANCO SINISTRO | SIDE LH | COTE GAUCHE | KB/50 1 |
| 3011508347 | SEITENWAND RECHTS | FIANCO DESTRO | SIDE RH | COTE DROIT | KB/50 1 |
| 3011807345 | SCHALTBLENDE | PANNELLO COMANDO | CONTROL PANEL | PANNEAU COMMANDE | KMG/50 1 |
| 3014206189 | VERSTÄRKUNG KAMIN | RINFORZO CAMINO | FLUE STIFFENER | RENFORT CHEMINEE | KMG/50 2 |
| 3026606244 | WINKELPROFIL KAMIN | PROFIL O ANG.CAMINO | FLUE ANGLE SECTION | PROFIL ANGLE CHEMI. | KMG/50 1 |
| 3031401790 | RING DISTANZ | RONDELLA | WASHER | RONDELLE | KB/50 2 |
| 3040400644 | MUTTER DECKELHUB | DADO COPERCHIO | NUT COVER | ECROU COUVERCLE | KB/50/90 1 |
| 3500506157 | ROHR GASANSCHLUSS | TUBO ALLACCIAMENTO | CONNECTION PIPE | TUYAU BRANCHEMENT | KMG/50 1 |
| 3500506193 | ROHR GASLEITUNG | TUBO CONDOTTA GAS | GAS SUPPLY PIPE | TUYAU CONDUITE GAZ | KMG/50 1 |
| 3500805182 | ABDECKUNG KAMIN | CRUSCOTTO CAMINO | PANEL FLUE | TABLEAU CHEMINEE | HGE/GPE/80 1 |
| 3500805332 | ABDECKUNG KAMIN N | CRUSCOTTO CAMINO N | FLUE BLANK PANEL | TABLEAU CHEMINEE N | G/80 1 |
| 3501106199 | WELLE HAHN | ASSE RUBINETTO | COCK SHAFT | AXE ROBINET | KMG/50 1 |
| 3501806173 | BLENDE UNTEN VORNE | CRUSCOTTO INF. ANT. | PANEL BOTTOM | TABLEAU INF.AVANT | KB/50 1 |
| 3502207346 | BRENNERRAMPE | RAMPA BRUCIATORI | BURNER BRIDGE | PONT BRULEURS | KMG/50 1 |
| 3506306169 | HALTER KAMIN | SUPPORTO CAMINO | FLUE SUPPORT | SUPPORT CHEMINEE | KMG/50 1 |
| 3506306174 | HALTER SCHALTER | SUPPORTO INTERRU. | SWITCH SUPPORT | SUPPORT INTERRUPT. | KB/50 1 |
| 3506306175 | HALTER PEDAL | SUPPORTO PEDALE | PEDAL SUPPORT | SUPPORT PEDALE | KB/50 1 |
| 3506706182 | ISOLIERBLECH V. | LAMIERA ISOL.ANT. | INSUL. PLATE FRONT | TOLE ISOL. AVANT | KB/50 1 |
| 3507806170 | KAMIN | CAMINO | FLUE | CHEMINEE | KMG/50 1 |
| 3508305473 | TRÄGER FUSS | SUPPORTO PIEDE | FOOT SUPPORT | SUPPORT PIED | G/85 4 |
| 3508706176 | MANTEL WANNE H. | MANTELLO RIVEST.P. | COVER JACKET REAR | MANTEAU REVETEMENT | KMG/50 1 |
| 3509706167 | RÜCKWAND KOLONNE | SCHIENA COLONNA | COLUMN BACK | DOS COLONNE | KMG/50 1 |
| 3509706168 | RÜCKWAND AUSSEN | SCHIENA | BACK | DOS | KB/50 1 |
| 3510601783 | RAHMEN WANNE | TELAIO VASCA | PAN FRAME | CHASSIS CUVE | KB/50 1 |
| 3510606172 | RAHMEN FÜSSE | TELAIO PIEDI | FEET FRAME | CHASSIS PIEDS | KB/50 1 |
| 3510606178 | RAHMEN BRENNER | CORNICE BRUCIATORE | BURNER CORNICE | CADRE BRULEUR | KMG/50/1 1 |
| 3512007072 | SCHARNIER DECKEL | CFRNIERA COPERCHIO | COVER HINGE | CHARNIERE COUVERCL. | KB/50/90 1 |
| 3513206166 | TISCHPLATTE H. | PIANO POSTERIORE | REAR HOB | PLAN ARRIERE | KB/50 1 |
| 3514203674 | VERSTÄRKUNG DECKEL | RINFORZO COPERCHIO | COVER STIFFENER | RENFORT COUVERCLE | KB/50/90 2 |
| 3522902102 | SCHALTKNOPF ABSPER. | MANOPOLA CHIUSURA | STOP COCK | POIGNEE FERMETURE | G/85 1 |
| 5004605409 | FUSS VERSTELLBAR | PIEDINO REGOLABILE | ADJUSTABLE FOOT | PIED REGLABLE | G/85 4 |
| 5004703196 | SICHERUNGSFEDER | ANELLO D'ARRESTO RADIALE | RADIAL STOP RING D=10 | BAGUE D'ARRET RADIALE | D=10 2 |
| 5004703199 | SICHERUNGSFEDER | ANELLO D'ARRESTO RADIALE | RADIAL STOP RING D=8 | BAGUE D'ARRET RADIALE | D=8 2 |
| 5004704628 | FEDER DECKEL | MOLLA COPERCHIO SAL | SPRING COVER | RESSORT COUVERCLE SAL | SAL 2 |
| 5004707073 | FEDER DECKELHUB | MOLLA ALZACOPERCHIO | SPRING COVER LIFT | RESSORT LEVE COUVER. | KB/50/90 1 |
| 5006806307 | ISOLIERUNG GLASWOLLE | PANNELLO ISOLANTE 620x260x25 | INSULATING PANEL 620x260x25 | PANNEAU ISOLANT | 620x260 2 |
| 5006806310 | ISOLIERUNG GLASWOLLE | PANNELLO ISOLANTE 740x240x25 | INSULATING PANEL 740x240x25 | PANNEAU ISOLANT | 740x240 1 |
| 5006806313 | ISOLIERUNG GLASWOLLE | PANNELLO ISOLANTE 750x150x25 | INSULATING PANEL 750x150x25 | PANNEAU ISOLANT | 750x150 1 |
| 5006806317 | ISOLIERUNG GLASWOLLE | PANNELLO ISOLANTE 670x150x25 | INSULATING PANEL 670x150x25 | PANNEAU ISOLANT | 670x150 2 |

0106905911

GAS-KIPPBRÄTTFANNE

BRASIER. . ROV. GAS

GAS TILT. BRAISING PAN

SAUTEUSE BASC.GAZ

KMG/50 PAG. 3

| COD. | BESCHREIBUNG | DESCRIZIONE | DESCRIPTION | DESCRIPTION | QUANT. |
|------------|-------------------------------|-------------------------------|------------------------------|------------------------------|--------------|
| 5007804335 | KAMIN ROST | GRIGLIA CAMINO | FLUE GRILL | GRILLE CHEMINEE | G/85 1 |
| 5008507230 | KUGELLAGER | CUSCINETTO A SFERA 25x52x15 | BALL BEARING 25x52x15 | ROULEMENT A BILLES | 25x52x15 2 |
| 5015400651 | WANNE BODEN FE | VASCA FONDO FE | BOTTOM TRAY FE | CUVE FOND FE | KB/50lt. 1 |
| 5016907182 | BRENNER 801/7A 660mm | BRUCIATORE 801/7A 660mm | BURNER 801/7A 660mm | BRULEUR 801/7A 660mm | BG/D 4 |
| 5017202639 | DÜSE BRENNER | UGELLO BRUCIATORE AL 140 N | BURNER JET AL 140 N | GICLEUR BRULEUR | AL 140 N 4 |
| 5017203116 | DÜSE BRENNER | UGELLO BRUCIATORE AL 80 N | BURNER JET AL 80 N | GICLEUR BRULEUR | AL 80 N 4 |
| 5017203133 | DÜSE ZÜNDBRÜCKE | UGELLO RAMPA ACCENSIONE T 45 | LIGHTING BRIDGE JET T 45 | GICLEUR PONT ALLUMAGE | T 45 1 |
| 5017203168 | DÜSE MINIMUM | UGELLO MINIMO 100 TKW | JET MINIMUM 100 TKW | GICLEUR RALENTI 100 TKW | 100 TKW 1 |
| 5017203169 | DÜSE MINIMUM | UGELLO MNIMO 200 TLW | JET MINIMUM 200 TLW | GICLEUR RALENTI 200 TLW | 200 TKW 1 |
| 5017207186 | DRUCKMESSDÜSE | PRESA DI PRESSIONE OT 58 | PRESSURE TAKE-OFF BRASS | PRISE DE PRESSION LAI.58 | OT 58 2 |
| 5017207871 | DÜSE ZÜNDBRÜCKE | UGELLO RAMPA ACCENSIONE T 70 | LIGHTING BRIDGE JET T 70 | GICLEUR PONT ALLUMAGE | T 70 1 |
| 5018003288 | KUGELVENTIL 3/4" | VALVOLA A SFERA 3/4"F-F SERIE | BALL VALVE 3/4"F-F SERIES | CHAPET A BILLE 3/4"F-F SERIE | DIN - DVGW 1 |
| 5018106152 | ELEKTROVENTIL 1/2" | ELETTROVALVOLA 1/2" | SOLENOID VALVE 1/2" | SOUPAPE ELECTR.1/2" | KMG/KME/50 1 |
| 5018606295 | SCHALTSTATER | PULSANTIERA | SWITCH BOARD | POUSSOIR | KB/50/90 1 |
| 5018902072 | GASVENTIL 150o-300o | VALVOLA GAS 150o-300o | GAS VALVE 150o-300o | SOUPAPE GAZ 150o-300o | 1 |
| 5020307187 | ZÜNDBRÜCKE 400mm | RAMPA ACCENSIONE 400mm | LIGHTING BRIDGE 400mm | PONT ALLUMAGE 400mm | KMG/50 1 |
| 5022902035 | SCHALTKNOPF ABZUG | VOLANTINO CON INDICE | KNOB WITH INDEX | VOLANT AVEC INDICAT. | BE/85I 1 |
| 5022904331 | SCHALTKNOPF GAS | MANOPOLA GAS | GAS KNOB | POIGNEE GAZ | BG/85 1 |
| 5024102394 | THERMOFÜHLER 450mm | TERMOCOPPIA 450mm | THERMOCOUPLE 450mm | THERMOCOUPLE.450mm | GZ/GBP 1 |
| 5024703475 | ZÜNDBRENNER 3-WEG 4mm | PILOTA TRE VIE 4mm | PILOT 3-WAY 4mm SIT | VEILL.3 SORTIES 4mm SIT | SIT 1 |
| 5029406192 | WASSEREINLAUF 1/2" | GETTO D'ACQUA 1/2" | WATER JET 1/2" | JET D'EAU 1/2" | KB/50/90 1 |
| 5040302606 | MUTTER 6KT M10 INOX 18/8 | DADO ES M10 INOX 18/8 | NUT HEX M10 STAINLESS STEEL | ECROU ES M10 INOX 18/82 | 2 |
| 5040302692 | MUTTER 6KT 1/2" VERZ.FIG.332 | DADO ES ZINCATO FIG.312 1/2" | NUT HEX.GALVAN. FIG.312 1/2" | ECROU ES ZINGUE FIG.312 1/2" | 1 |
| 5040302708 | MUTTER 6KT M8 FE VERZINKT | DADO FE ZINCATO M8 | NUT GALVAN. FE M8 | ECROU FE ZINGUE M8 | 2 |
| 5040402696 | HUTMUTTER 6KT M8 INOX A2 18/8 | DADO CIECO ES.A CALOTTA SFER. | CAP NUT HEX. WITH ROUND HEAD | ECROU BORGNE ES.A CALOTTE S. | 1 |
| 5040603226 | ÜBERWURFMUTTER 6 KANT M10x1 | DADO PER BICONO OT.M 10x1>6 | NUT FOR OLIVE BRASS M10x1>6 | ECROU POUR BICONE LAI. | 1 |
| 5050100138 | BOGEN VERZ. FIG.90 3/4">1/2" | GOMITO ZINC.FIG.90 3/4">1/2" | ELBOW GALV.FIG.90 3/4">1/2" | COUDE ZINGU.FIG.90 3/4">1/2" | 1 |
| 5050120011 | BOGEN VERZ. FIG.92 3/4" | GOMITO ZINC. FIG.92 3/4" | ELBOW GALV. FIG.92 3/4" | COUDE ZINGU. FIG.92 3/4" | 2 |
| 5050503194 | DOPPELKEGELRING MS D=6 | BICONO OTTONE | OLIVE BRASS | BICONE LAITON | 1 |
| 5051206145 | KONUS-QUETSCHVERSCHR. 1/2x12 | DADO ADATTATORE DI PRESSIONE | PRESSURE ADAPTOR NUT | ECROU ADAPTATEUR DE PRES. | 3 |
| 5051220023 | ROHRVERSCHRAUBUNG | RACCORDO OTTONE SEMPL. | BRASS FITTING SIMPLE 1/2>16 | RACCORD LAITON SIMPLE 1/2>16 | MS 1/2">16 1 |
| 5051220038 | ROHRVERSCHRAUBUNG | RACCORDO OTTONE 3/8">12 PEL | BRASS FITTING 3/8">12 PEL | RACCORD LAITON 3/8">12 PEL | MS 3/8">12 1 |
| 5060403707 | PIEZÖZÜNDER | ACCENSIONE PIEZO RV 1174-03 | PIEZO LIGHTING RV 1174-03 | ALLUMAGE PIEZO RV 1174-03 | RV 1174-03 1 |
| 5060507682 | ANSCHLUSSKLEMME 10Q 3-POLIG | MORSETTIERA 8010/3 DS.KR. | TERMINAL 8010/3 DS.KR. | BORNE 8010/3 DS.KR. | 1 |
| 5060901909 | SCHALTER BRETER | INTERRUTTORE BRETER | SWITCH BRETER | INTERRUPTEUR BRETER | KB/50 1 |
| 5060902730 | KONTAKTE 300V V50 | CONTATTI 300V V50 | CONTACTS 300V V50 | CONTACTS 300V V50 | KB/50 2 |
| 5060906194 | SCHALKONTAKT | CONTATTO CEMA | CONTACT CEMA | CONTACT CEMA | KB/50 1 |
| 5061003550 | KABEL ZÜNDUNG 740 | CAVO ACCENSIONE 740mm | LIGHTING CABLE 740mm | CABLE ALLUMAGE 740mm | S/85 1 |
| 5061207233 | SPINDELMOTOR TYPE | MOTORE WSP 2650/6 | MOTOR WSP 2650/6 KB | MOTEUR WSP 2650/6 KB | WSP 2650/6 1 |
| 5061807231 | GLASSICHERUNG FLINK 5x20F. | FUSIBILE LA 01078-250V | FUSE LA 01078-250V | FUSIBLE LA 01078-250V | 1 |
| 5061807908 | SICHERUNGSHALTER SIEMENS | PORTA FUSIBILE SIEMENS | FUSE-HOLDER SIEMENS | PORTE FUSIBLE SIEMENS | 1 |
| 5061903322 | VERSCHRAUBUNG PG16 ART.106/16 | PASSACAVO PVC PG/16 N 106 | GROMMET PVC PG/16 N 106 | OEILLET PVC PG/16 N 106 | 2 |
| 5062607632 | ZÜNDKERZE | CANDELA ACCENSIONE SIT | LIGHTING PLUG SIT | BOUGIE ALLUMAGE | SIT 1 |
| 5207400705 | HOLZVERSCHLAG | IMBALLO LEGNO | WOODEN CRATE | EMBALLAGE BOIS | S/80 1 |