

CP-4ET CP-6ET CP-4ETX CP-6ETX

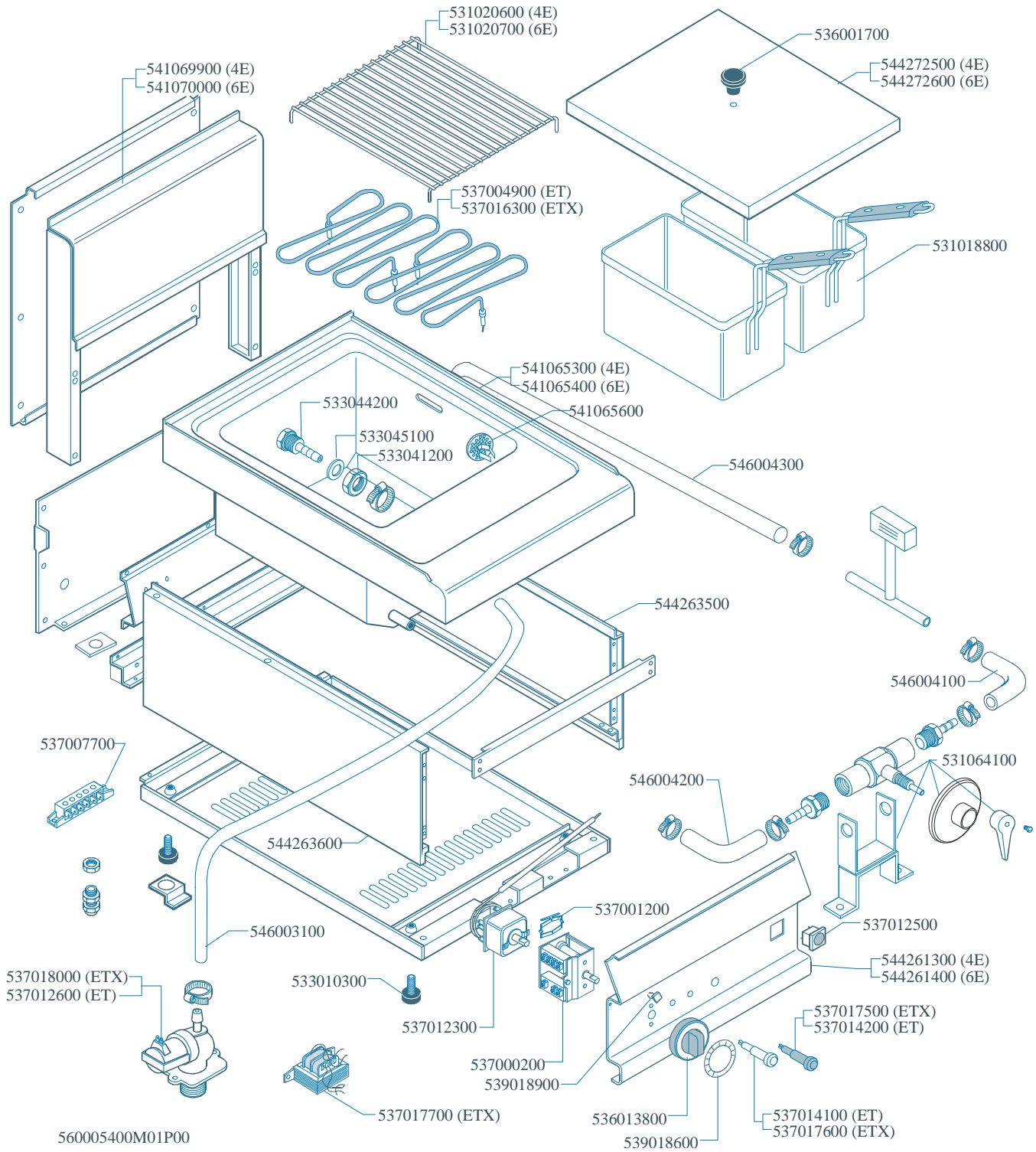

| Page | Pos | Code | Description |
|------|-----|-----------|-------------------------------------|
| 001 | | 536001700 | GRIP D.25*19*M6 |
| 001 | | 537016300 | HEATING ELEMENT 2000W 440V CP65 |
| 001 | | 531018800 | PASTACOOKER BASKET 150X292X150H |
| 001 | | 533044200 | H.20 INPUT FITTING |
| 001 | | 541065600 | DRAIN FILTER CP-E 65 |
| 001 | | 533045100 | GASKET §E24*§I18*SP.1,5 |
| 001 | | 533041200 | HEXAGONAL NUT 3/8" G |
| 001 | | 546004300 | RUBBER TUBE §I.19*§E.27*1300 |
| 001 | | 544263500 | RIGHT SIDE S.65 |
| 001 | | 546004100 | RUBBER TUBE §I.19*§E.27*L266 |
| 001 | | 537012500 | BUTTON 1POLE |
| 001 | | 537007700 | TERMINAL BLOCK THREEPHASE 40A |
| 001 | | 531064100 | BALL VALVE 3/4"G F-F (1320PEL) |
| 001 | | 546004200 | RUBBER TUBE §I.19*§E.27*L156 |
| 001 | | 544263600 | LEFT SIDE S.65 |
| 001 | | 537001200 | FIXING BRACKET FOR THERMOSTAT/COMM. |
| 001 | | 546003100 | RUBBER TUBE §I.10*§E.18*950 |
| 001 | | 533010300 | ADJUSTABLE FOOT M10*20 D.23 |
| 001 | | 537017700 | TRANSFORMER 440V/100V 10VA |
| 001 | | 537017500 | GREEN WARNING LIGHT LOW BUD 110V |
| 001 | | 536013800 | KNOB D.70 BLACK 6*5 WITH SPRING |
| 001 | | 539018600 | ADHESIVE GRADUATED DISC FOR KNOB |
| 001 | | 537017600 | WHITE WARNING LIGHT LOW BUD 110V |
| 001 | | 537018000 | ONE-WAY SOLENOID VALVE 180°100V |
| 001 | | 537012300 | THERMOSTAT 30/110°C THREEPHASE |
| 001 | | 537000200 | COMMUTATOR 1 POS. 3PHASE S.49 16A |
| 001 | | 539018900 | INDEX FOR KNOB |
| 001 | | 541069900 | NEUTRAL SPACER 4 |
| 001 | | 544261300 | CONTROL PANEL CP-4E |
| 001 | | 531020600 | GRID FOR CP-4E |
| 001 | | 544272500 | TANK LID CP-4E |
| 001 | | 541065300 | UPPER PLATE CP-4E |