

	*	**
G30- 28+30mbar G31- 37mbar	533015400	533043400
G30- 50mbar	533015300	533043300
G20- 20mbar G25- 25mbar	533015200	533019400
G25- 20mbar	533030300	533043600
G25- 25mbar NL	533014900	533043500

532001800 ≤ 09040565 (PC)  
532001800 ≤ 09040821 (CF)  
532006500 ≥ 09040566 (PC)  
532006500 ≥ 09040822 (CF)

532001700 ≤ 09040565 (PC)  
532001700 ≤ 09040821 (CF)  
532006400 ≥ 09040566 (PC)  
532006400 ≥ 09040822 (CF)

532006700

532006600

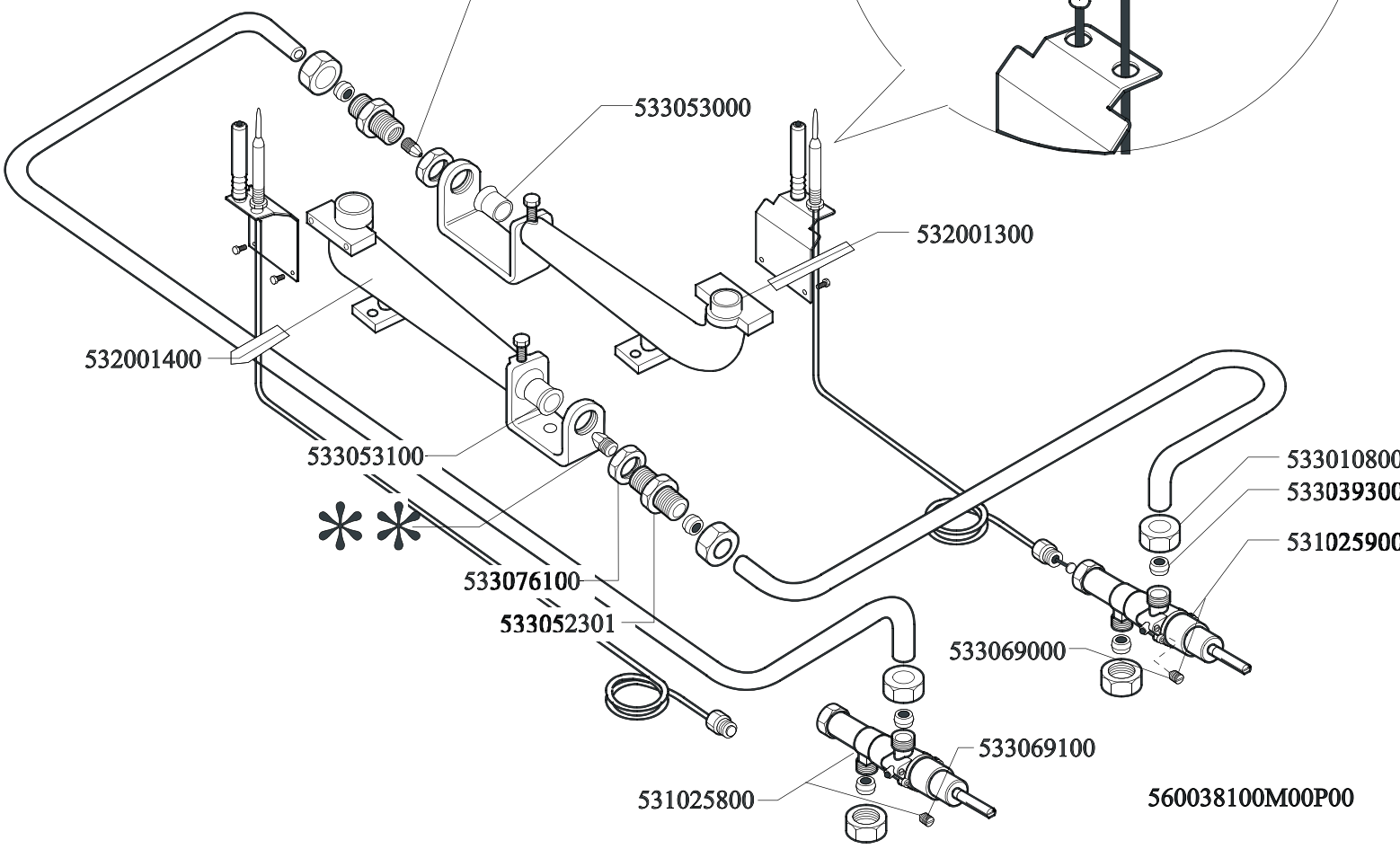
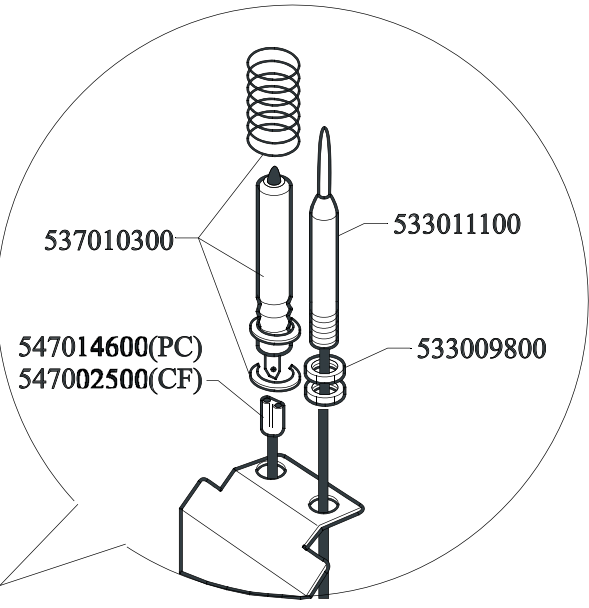

\*

\*\*

Page	Pos	Code	Description
001		533009200	REDUCTION GRATE FOR 65-70LINES+FO
001		532002300	1 FLAME GRILL 346X274 (70
001		532005901	1 FLAME GRILL 340X270 (65) * RAF
001		544300800	ENAMELLED BURNER DRIP PAN 1/1
001		544498800	BURNERS BASIN OF PC GN1/1 SM.N.RAF
001		544498801	
001		541069900	NEUTRAL SPACER 4
001		544288800	UPPER PLATE PC-4G
001		544263500	RIGHT SIDE S.65
001		544292300	CONTROL PANEL PC-4G
001		539018900	INDEX FOR KNOB W/RED SIGN
001		544263600	LEFT SIDE S.65
001		533010300	ADJUSTABLE FOOT M10*20 D.23
001		536017100	BLACK KNOB §70 PIN §8*6,5
001		539022500	ADHESIVE GRADUATED DISC FOR KNOB
001		537002800	PIEZOELECTRIC IGNITION M18 WITH NUT
002		532001700	QUICKBURNER §82
002		532006400	QUICKBURNER 2 RING Ø082 3 Z
002		532001800	QUICKBURNER §102
002		532006500	QUICKBURNER 2 RING Ø102 3 Z
002		532006700	BURNER BODY 5,5 KW WITH PLUG
002		532006600	BURNER BODY 3,5 KW WITH PLUG
002		533011100	THERMOCOUPLE 750 M8*1
002		537010300	IGNITION PLUG WITH SPRING PC65
002		547014600	HIGH-VOLTAGE CABLE208X0,8.TUB.§2 L8
002		533053000	AIR ADJUSTMENT BUSHING §18
002		532001300	BURNER VENTURI 3,5 KW
002		532001400	BURNER VENTURI 5,5 KW
002		533053100	AIR ADJUSTMENT BUSHING §20
002		533076100	HEXAGONAL NUT M14X1 H4 + BUSHING
002		533052301	JOINT FOR NOZZLE HOLDER
002		533010800	TUBE NUT D.10 M16*1,5
002		533039300	BICONE §10
002		531025900	SAFETY TAP 20S-B PEL20S21070
002		533069000	BY PASS COCK §70 20S-21S
002		533069100	BY PASS COCK §60 20S
002		531025800	SAFETY TAP 20S-B PEL20S2160
002		533015400	NOZZLE §93 CH12*14 G-PC4 R
002		533015300	NOZZLE §82 CH12*14 F-PC4 R
002		533015200	NOZZLE §145 CH12*14 F-FP/CP6
002		533030300	NOZZLE §160 CH12*14 M-FPG
002		533014900	NOZZLE §150 CH12*14 F-FQ5 L-FQ6
002		533043400	NOZZLE §117 CH12*14 G-PC4 UR
002		533043300	NOZZLE §103 CH12*14 F-PC4 UR
002		533019400	NOZZLE §180 CH12*14 L-FQ5
002		533043600	NOZZLE §200 CH12*14 L-PC4 UR
002		533043500	NOZZLE §190 CH12*14 G25 PC4R