

Lavastoviglie professionali di lunga durata

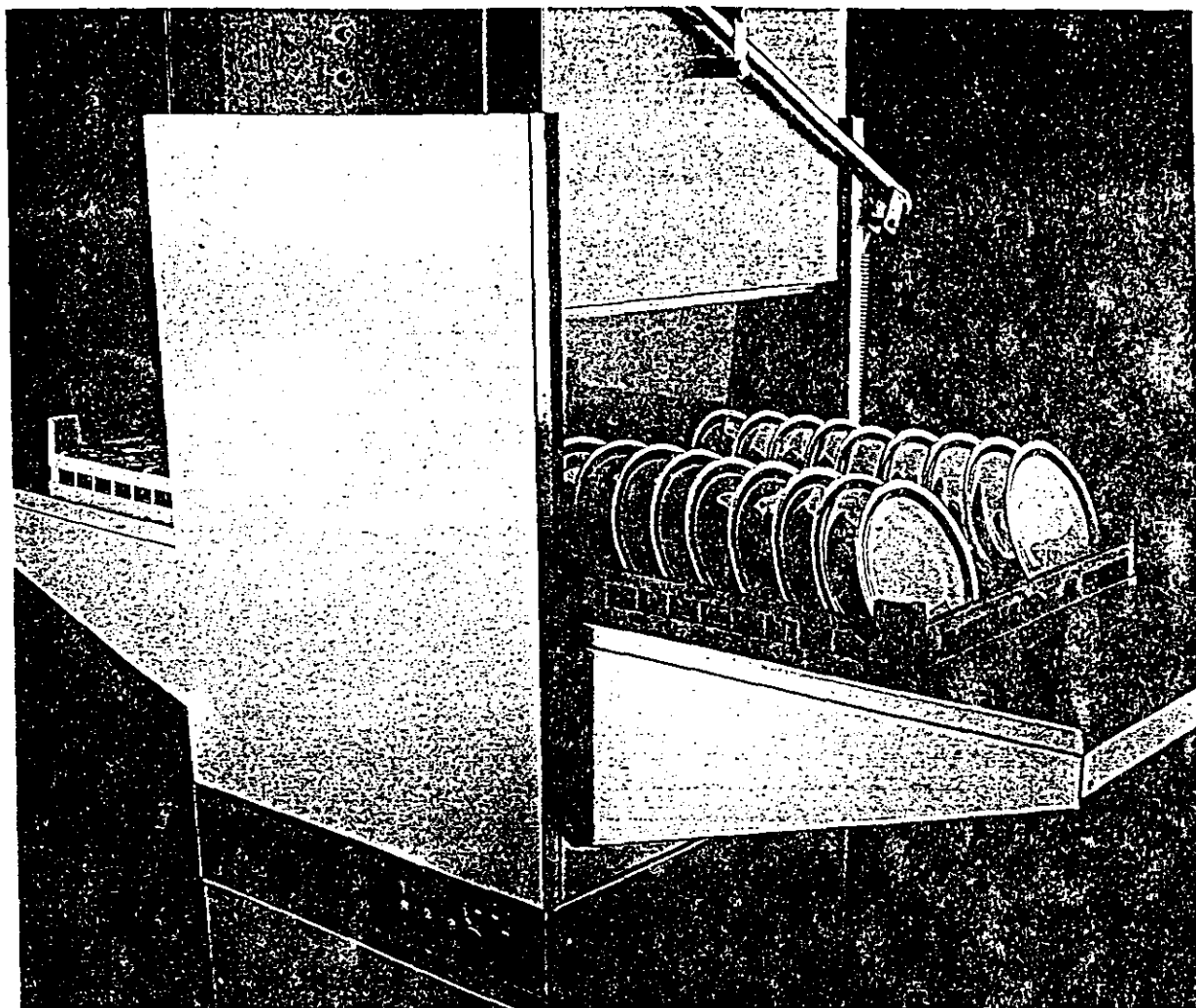

Modello C 30

720 piatti/ora col programma risparmio
540 e 360 piatti/ora con gli altri programmi

ancora più automatica
per guadagnare tempo e
semplificare il lavoro

tre programmi di lavaggio
per togliere lo sporco più resistente e
risparmiare quando è possibile.



L'alta professionalità del lavaggio.

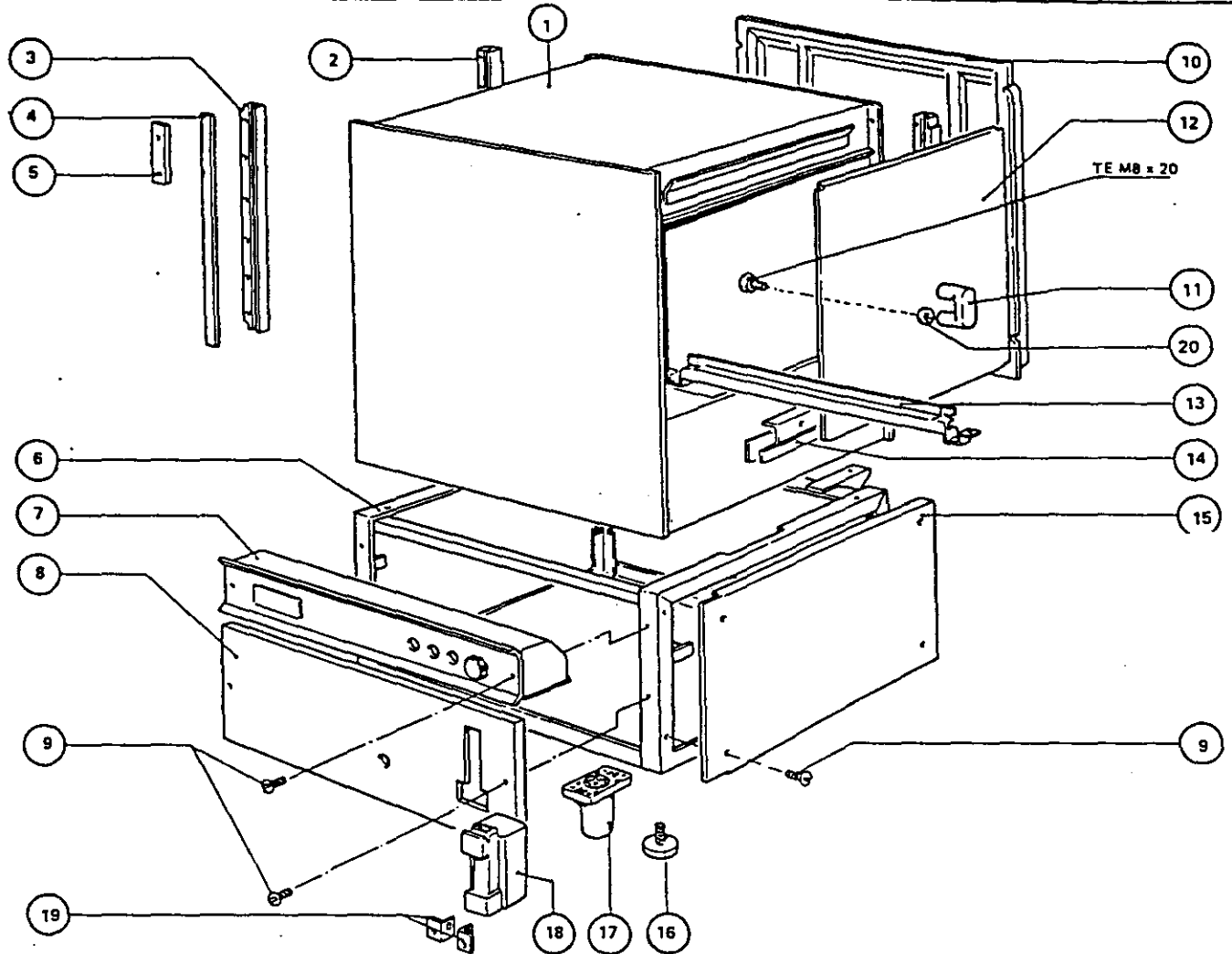

POS.	N. CODICE	DESCRIZIONE	DENOMINATION	DESCRIPTION	BEZEICHNUNG
1	340871	Carrozzeria	Carrosserie	Base	Karosserie
2	180606	Guida sinistra	Rail gauche	Left track	Linke Führung
3	180605	Guida destra	Rail droite	Right track	Rechte Führung
4	200433	Guarniz. ades. 2,5x6	Joint	Gasket	Dichtung
5	320627	Piastra fiss. guide	Patte	Lock plate	Klemmplatte
6	391221	Basamento	Socle	Base frame	Untergestell
7	111154	Cassetta elettrica	Tableau électrique	Control cabinet	E-Schalttafel
7		Cass. elettr. vapore	Tableau électr. vap.	Contr. cab. steam	E-Tafel Dampfausfüh.
8	351102	Pannello frontale	Panneau	Front panel	Frontplatte
9	260227	Vite spec. M5x30	Vis	Screw	Schraube
10	161107	Copert. posteriore	Fanneau	Back panel	Rückwand
11	190608	Cavallotto	Guide	Support	Führung
12	320927	Portina	Porte	Door	Tür
13	320863	Guida cestello	Rail panier	Rack guide	Korbführung
14	330796	Paraspruzzi	Protection	Protection	Spritzschutz
15	350295	Pannello laterale	Panneau lateral	Side panel	Seitliche Abdeckung
16	440201	Piedino	Pied	Foot	Fuss
17	160509	Supporto piede	Support pied	Foot support	Fusshalterung
18	190804	Contenitore brill.	Cont. prod. rinçage	Rinse aid container	Glanzmittelbehälter
19	350745/6	Squadretta	Equerre	Bracket	Winkel
20	160811	Guarnizione	Joint	Gasket	Dichtung

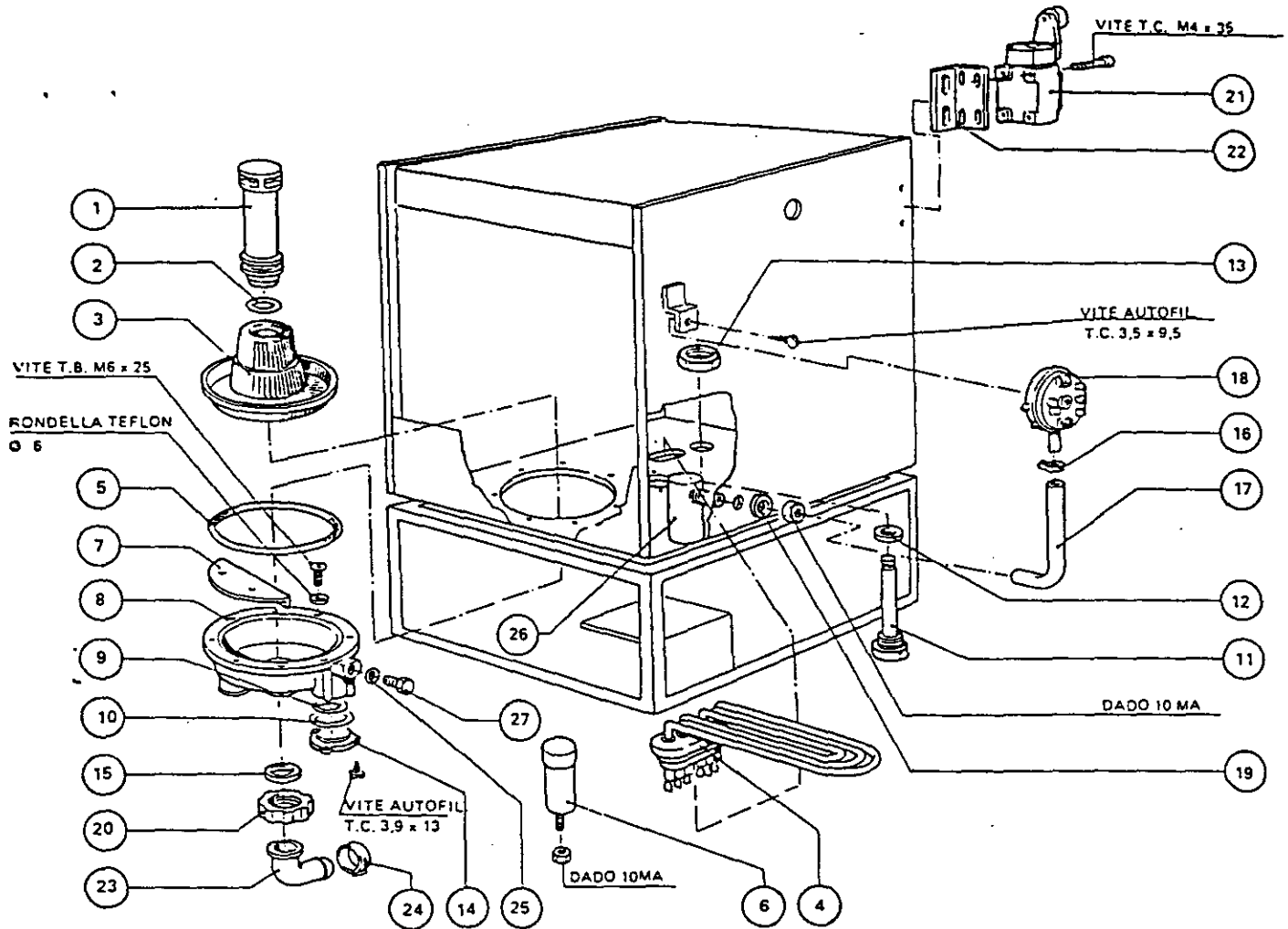

POS.	N. CODICE	DESCRIZIONE	DENOMINATION	DESCRIPTION	BEZEICHNUNG
1	170707	Troppopieno	Trop plein	Overflow pipe	Oberlaufstutzen
2	200830	Guarnizione OR	O-Ring	O-Ring	O-Ring
3	180808	Filtro	Filtre	Strainer	Filter
4	110227	Resistenza 3000 W	Résistance 3000 W	Heating element 3000 W	Heizkörper 3000 W
5	200828	Guarnizione OR	O-Ring	O-Ring	O-Ring
6	631207	Condensatore 12,5 uF	Condensateur 12,5 uF	Condenser 12,5 uF	Kondensator 12,5 uF
7	180814	Filtro prot.aspir.pompa	Filtre	Strainer	Filter
8	180218	Vasch.aspir.pompa	Cuve aspir.pompa	Pump suction	Pumpenansaugung
9	200814	Guarnizione OR	O-Ring	O-Ring	O-Ring
10	200835	Guarnizione OR	O-Ring	O-Ring	O-Ring
11	450508	Guaina termostato	Gaine thermostat	Thermostat shield	Schutzhülle Thermostat
12	460502	Guarnizione 1/2"	Joint 1/2"	Gasket 1/2"	Dichtung 1/2"
13	270101	Controdado 1/2"	Contre ecrous 1/2"	Lock nut 1/2"	Gegenmutter 1/2"
14	160731	Tappo trapp.pressost.	Gouchon	Plug	Propfen
15	200412	Guarnizione codulo	Joint	Gasket	Dichtung
16	450125	Fascetta	Collier	Clamp	Schelle
17	200353	Tubo pressostato	Tuyau pressostat	Press.switch hose	Druckwächterschlauch
18	130605	Pressostato	Pressostat	Pressure switch	Druckwächter
19	200415	Guarnizione	Joint	Gasket	Dichtung
20	180102	Ghiera per codulo	Embout	Drain pipe nut	Ablauf
21	120320	Fine corsa	Fin de course	Micro switch	Endschalter
22	350742	Squadretta	Equerre	Bracket	Winkel
23	160203	Codulo curvo	Douille	Drain pipe	Verbindung
24	450106	Fascetta Ø 32-44	Collier Ø 32-44	Clamp Ø 32-44	Schelle Ø 32-44
25	200818	Guarnizione OR	O-Ring	O-Ring	O-Ring
26	161301	Trappola pressostato	Capuchon air	Air chamber	Luftfalle
27	260112	Vite T.E.	Vis	Screw	Schraube

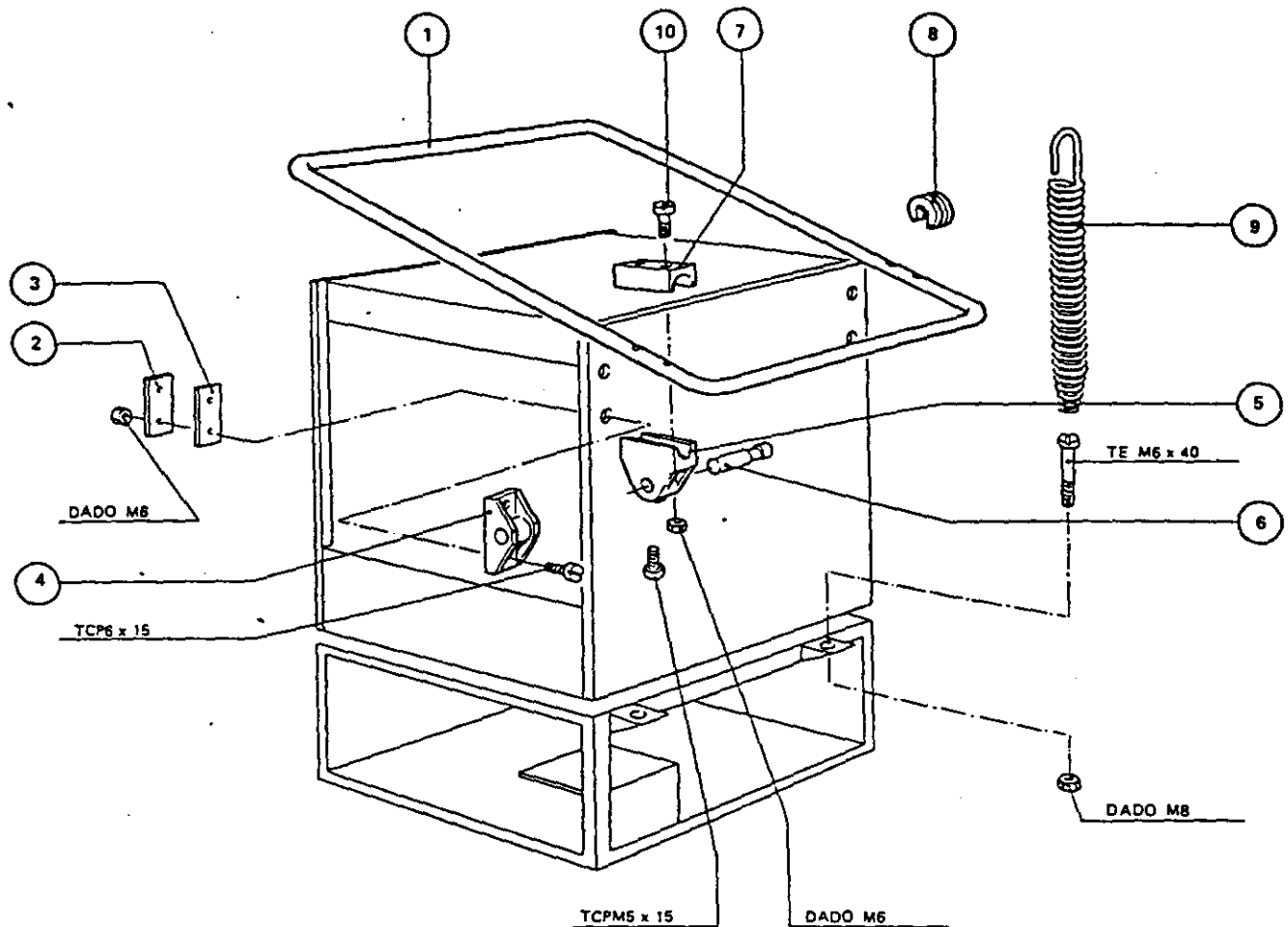

POS.	N. CODICE	DESCRIZIONE	DENOMINATION	DESCRIPTION	BEZEICHNUNG
1	331006	Maniglione	Poignée	Handle	Griff
2	330917	Controfl. supp.	Contreflasque	Counterflange	Gegenflansch
3	200451	Guarnizione controfl.	Joint	Gasket	Dichtung
4	190110	Supporto	Support	Support	Support
5	191013	Snodo	Joint	Joint	Gelenk
6	340493	Perno	Axe	Pin	Stift
7	191014	Flangia snodo	Flasque	Flange	Flansch
8	190607	Bussola	Douille	Bushing	Buchse
9	391312	Molla	Ressort	Spring	Feder
10	260228	Vite M6x42 inox	Vis M6x42 inox	Screw M6x42 inox	Schraube M6x42 inox

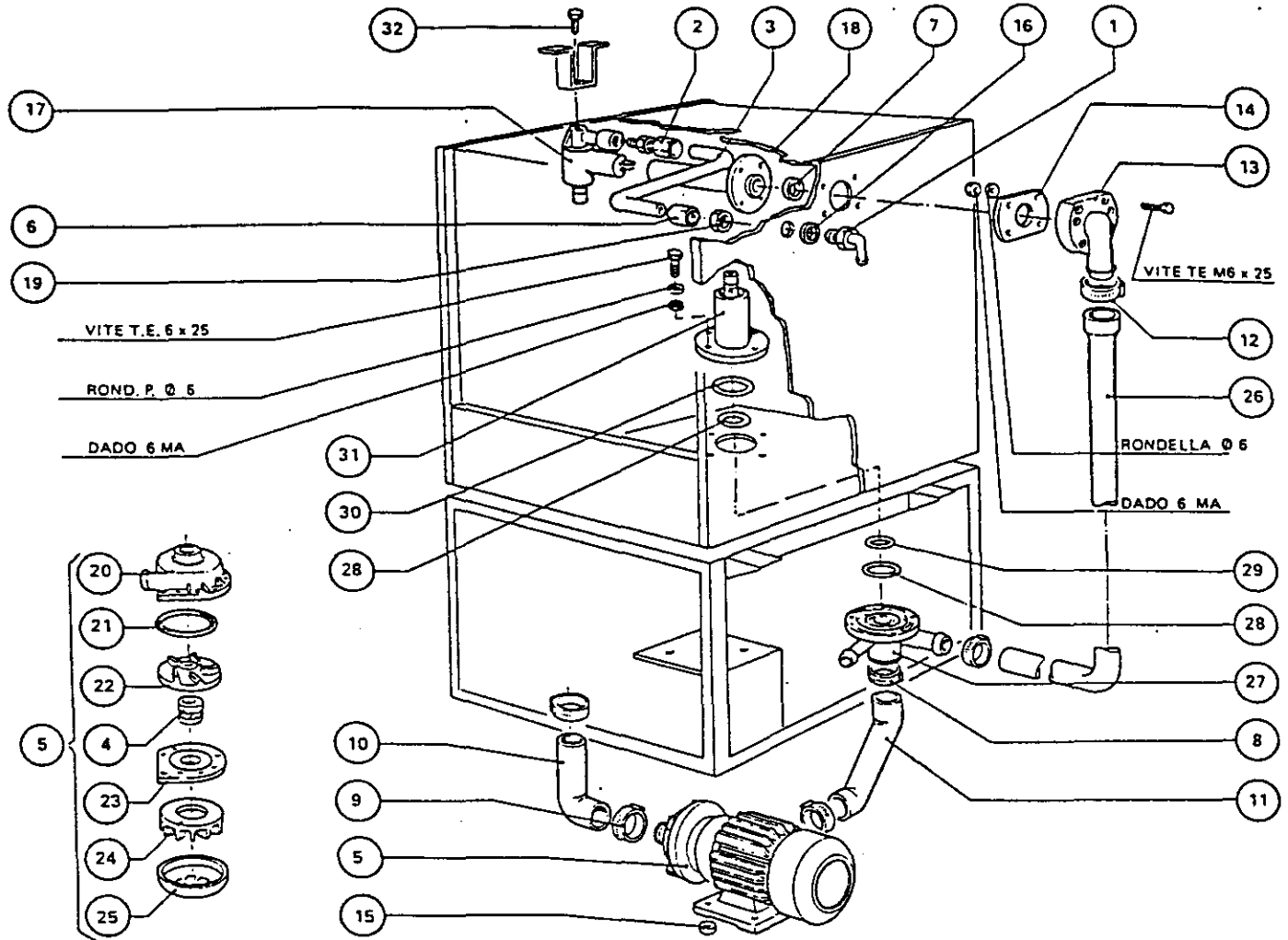

POS.	N. CODICE	DESCRIZIONE	DENOMINATION	DESCRIPTION	BEZEICHNUNG
1	190315	Raccordo a gomiro ris	Coude	Elb	Kniestück
2	190309	Raccordo diritto	Raccord	Connection	Anschluss
3	160115	Tubo risc.superiore	Tuyau rincage	Rinsepipe	Spülrohr
4	630510	Guarnizione tenuta	Joint	Gasket	Dichtung
5	100384	Pompa HP 1	Pompe	Pump	Pumpe
6	180123	Dado raccordo risciac.	Ecrou	Nut	Mutter
7	200435	Guarnizione	Joint	Gasket	Dichtung
8	450107	Fascetta 38+50	Collier	Clamp	Schelle
9	450135	Fascetta 44+56	Collier	Clamp	Schelle
10	200724	Tubo di aspirazione	Tuyau aspiration	Adspire hose	Ansaugrohr
11	200725	Tubo di mandata	Coude	Pressure Knee-hose	Druckstutzen
12	450114	Fascetta 22+32	Collier	Clamp	Schelle
13	180409	Raccordo lav.super.	Raccord	Connection	Verbindungsflansch
14	200434	Guarnizione	Joint	Gasket	Dichtung
15	210202	Piedino	Pied	Foot	Fuss
16	200457	Guarnizione	Joint	Gasket	Dichtung
17	190206	Pipa mulinello sup.	Pipette supérieure	Tee-upper wash	Oberer Washarm Support
18	420310	Tubo inferiore	Tuyau inf.	Lower pipe	Unt. Rohr
19	270118	Controdado	Contre ecrous	Lock nut	Gegenmutter
20	630113	Chiocciola	Escargot	Volute	Pumpengehäuse
21	630410	Anello OR	O-Ring	O-Ring	O-Ring
22	631627	Girante	Turbine	Impeller	Laufrad
23	630214	Flangia	Flasque	Flange	Flansch
24	630303	Ventola raffredd.	Turbine	Fan	Laufrad
25	630219	Coperchio	Couvercle	Fan housing	Schild
26	200726	Tubo lav.sup.e inf.	Tuyau lavage	Pressure Knee-hose	Druckstutzen
27	190203	Pipa inf.lavaggio	Support lavage	Lower support	Unt.Wascharm Supp.
28	200820	Guarnizione OR	O-Ring	O-Ring	O-Ring
29	200806	Guarnizione OR	O-Ring	O-Ring	O-Ring
30	200829	Guarnizione OR	O-Ring	O-Ring	O-Ring
31	191031	Colonna mul.inf.	Colonne tourn.inf.	Lower washarm	Untere Wascharmhalter.
32	261005	Vite spec. M10 x 10	Vis	Screw	Schraube

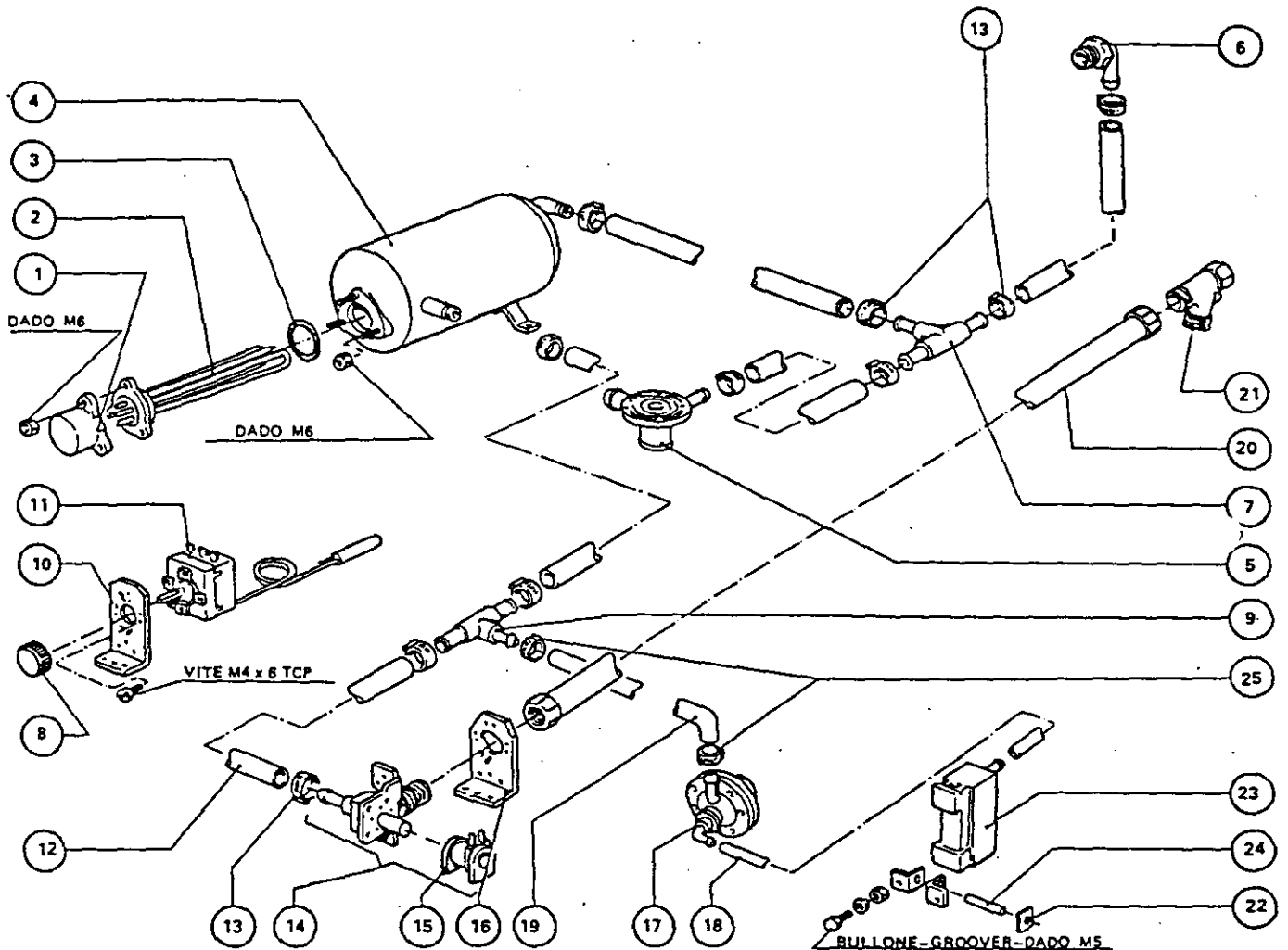

POS.	N. CODICE	DESCRIZIONE	DENOMINATION	DESCRIPTION	BEZEICHNUNG
1	161102	Copriresistenza	Protection résist.	Element cover	Heizkörperchutz
2	110331	Resistenza 4200W	Résistance 4200W	Heater 4200W	Heizkörper 4200W
3	200815	Guarnizione OR	O-Ring	O-Ring	O-Ring
4	330307	Boiler	Surchauffeur	Booster	Durchlauferhitzer
5	190203	Pipa inf. lavaggio	Support lavage	Pressure Knee-hose	Druckstutzen
6	190315	Raccordo a gomito r.	Coude	Elb	Kniestück
7	180403	Portagomma a T	Raccord T	Hose barb	T-Stück
8	450315	Manopola	Poignée	Knob	Knebel
9	180408	TE per dosatore	TE pour doseur	TEE	T-Stück Dosierung
10	330754	Squadretta	Equerre	Bracket	Winkel
11	120501	Termostato	Thermostat	Thermostat	Thermostat
12	2003..	Tubo gomma §12x22	Durite § 12x22	Rubber hose § 12x22	Gummischlauch §12x22
13	450103	Fascetta § 13+20	Collier § 13+20	Clamp 13+20	Schelle § 13+20
14	120145	Elettrovalvola	Electrovanne	Solenoid valve	E-Ventil
15	630969	Bobina elettroval.	Bobine électrov.	Solenoid	Spule
16	330725	Squadretta	Equerre	Bracket	Winkel
17	620120	Dosatore Comenda	Doseur	Rinse injector	Clanzmitteldosierer
18	160108	Tubo aspir. dosat.	Tuyau asp. doseur	Suction hose	Ansaugschlauch
19	200374	Tubo mand. dosatore	Tuyau	Discharge hose	Dosierungsauslauf
20	200715	Tubo carico	Tuyau	Discharge hose	Einlaufschlauch
21	620209	Filtro entr. acqua	Filtre	Strainer	Filter
22	450812	Molla fiss. perno	Ressort	Lock plate	Klemmfeder
23	190804	Contentitore brill.	Container prod. rin.	Rinse aid container	Clanzmittelbehälter
24	340484	Perno contenitore	Axe cont.	Pin	Stift
25	450102	Fascetta § 11+17	Collier § 11+17	Clamp 11+17	Schelle 11+17

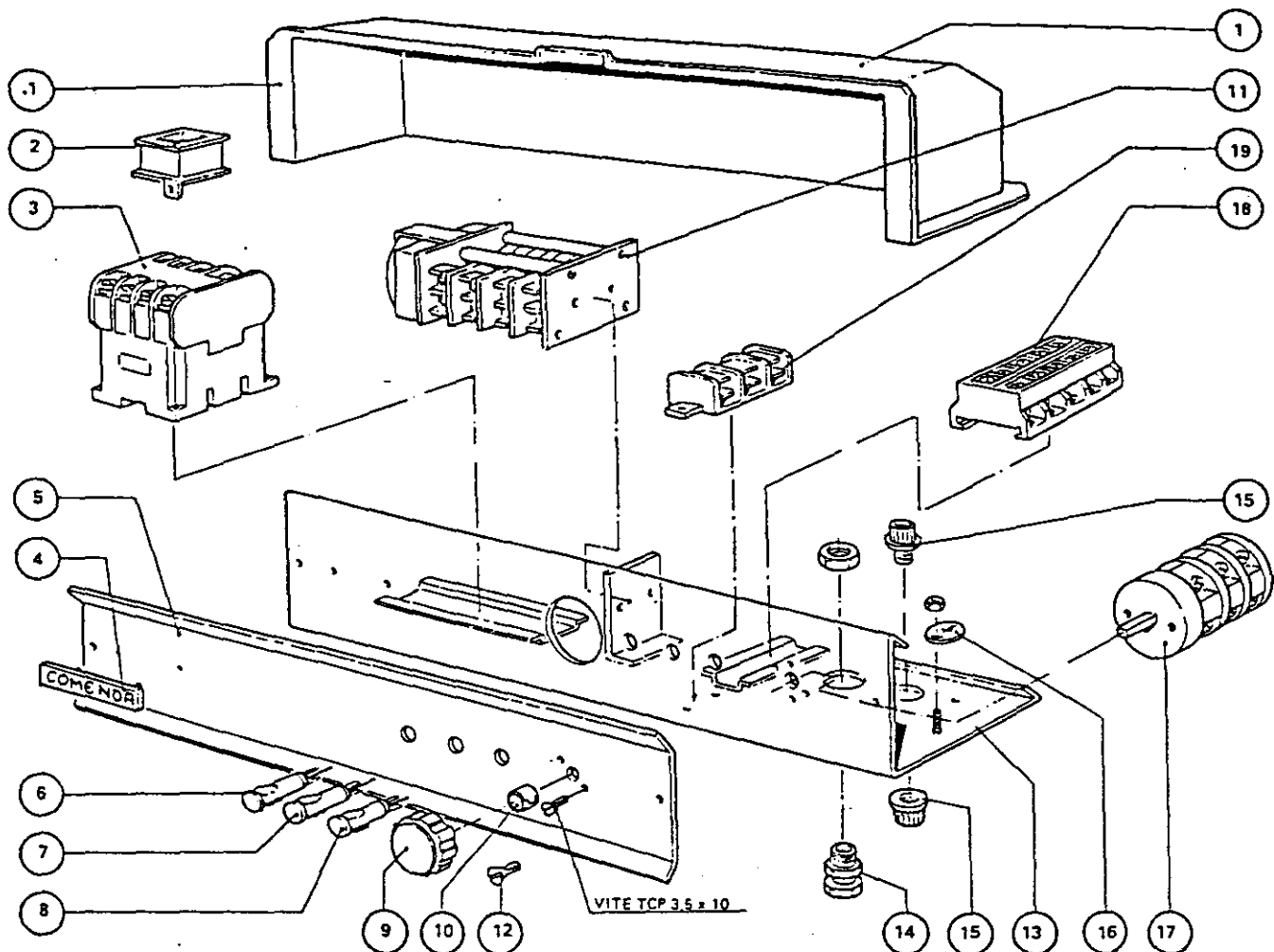

POS.	N. CODICE	DESCRIZIONE	DENOMINATION	DESCRIPTION	BEZEICHNUNG
1	161106	Copertura impianto	Couvercle	Cover	Abdeckung
2	630954	Bobina	Bobine	Solenoid	Spule
3	120434	Teleruttore LCI-D09	Contacteur	Contacteur	Schütz
4	460159	Targhetta Comenda	Plaque Comenda	Name Plate	Markenschild
5	460171	Targa comandi	Plaque	Control panel	Frontplatte
6	130103	Lampada spia rossa	Lampe rouge	Red light	Rote Leuchtlampe
7	130115	Lampada spia verde	Lampe verte	Green light	Grüne Leuchtlampe
8	130116	Lampada spia gialla	Lampe jaune	Yellow light	Gelbe Leuchtlampe
9	180111	Manopola	Poignée	Knob	Knebel
10	440817	Anello elastico	Goupille	Roll pin	Elastischer stift
11	120217	Timer	Programmateur	Timer	Zeitschalter
12	300156	Vite M5x20 brunita	Vis M5x20	Screw M5x20	Schraube M5x20
13	340246	Supporto	Support	Support	Halterung
14	150813	Pressacavo 1"	Protection gaine 1"	Cable holder 1"	Kabeldurchlass 1"
15	150818	Pressacavo plastica	Protection gaine	Cable holder	Kabeldurchlass
16	460121	Targhetta terra	Plaque	Earth plate	Erdungsschild
17	120713	Interruttore	Interrupteur	Switch	Schalter
18	150219	Morsettiera 16mm ²	Borne	Terminal block	Klemmenleiste
19	130303	Fastoniera 4 posti	Borne	Faston block	Fastonklemmleiste

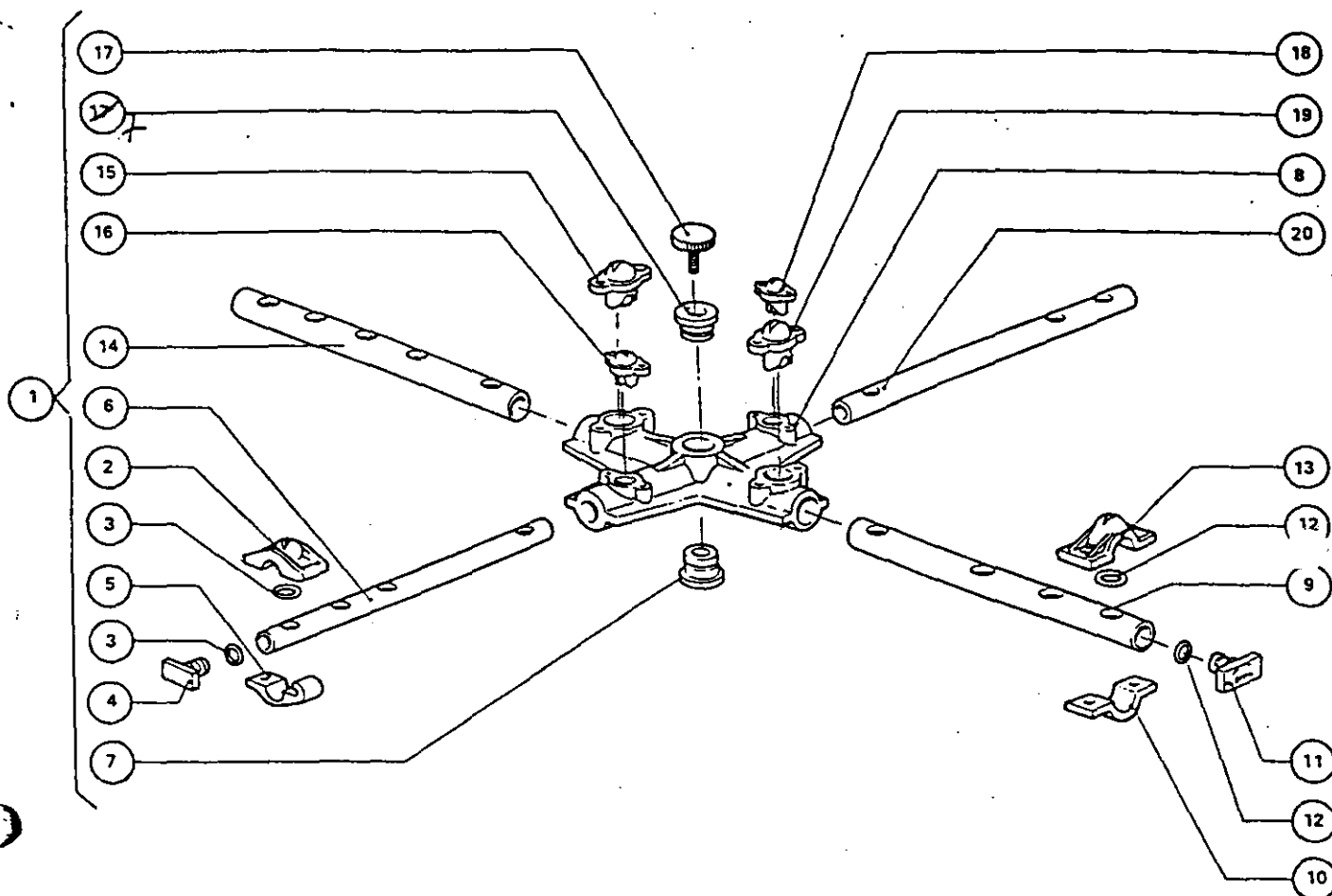

POS.	N. CODICE	DESCRIZIONE	DENOMINATION	DESCRIPTION	BEZEICHNUNG
1	420515	Mulinello completo	Tourniquet compl.	Wash-rinse arm	Spülarm
2	170911	Ugelli risciacquo	Gicleur rincage	Rinse jet	Nachspüldüse
3	200818	Guarnizione OR	Joint OR	O-Ring	O-Ring
4	160718	Tappo risciacquo	Bouchon rincage	Plug rinse arm	Propfen
5	170704	Cavallotto fis. gett.	Etrier	Rinse nozzle	Nachspüldüsenhalteru
6	331362	Tubo risciacquo	Tuyau rincage	Rinse pipe	Nachspülrohr
7	190617	Bussola	Douille	Bush	Buchse
8	191022	Corpo mulinello	Corps tourniquet	Central cross	Spülarmkreuz
9	331360	Tubo lavaggio	Tuyau lavage	Wash pipe	Waschrohr
10	180213	Flangia bloc. getti	Flasque	Jet locking	Düsenklemmung
11	160719	Tappo lavaggio	Bouchon	Plug wash arm	Propfen
12	200824	Guarnizione OR	Joint OR	O-Ring	O-Ring
13	170916	Getti sinistri	Jet gauche	Left jet	Linke Düse
13	170915	Getti destri	Jet droite	Right jet	Rechte Düse
14	331359	Tubo lav. 4 fori	Tuyau lav. 4 trous	Wash pipe	Waschrohr
15	170928	Ugello lav. cieco	Gicleur lavage	Blind-jet	Blinddüse
16	170929	Ugello risciacquo	Gicleur rincage	Rinse jet	Nachspüldüse
17	261004	Vite fermo mulinel.	Vis	Retaining screw	Supportschraube
18	170930	Ugelli risc. cieco	Gicleur rincage	Blind-jet	Blinddüse
19	170927	Ugello lavaggio	Gicleur lavage	Wash-jet	Waschdüse
20	331361	Tubo risc. 3 fori	Tuyau rinc. 3 trous	Rinse-pipe	Nachspülrohr