

FO-1G FO-2G FO-3G

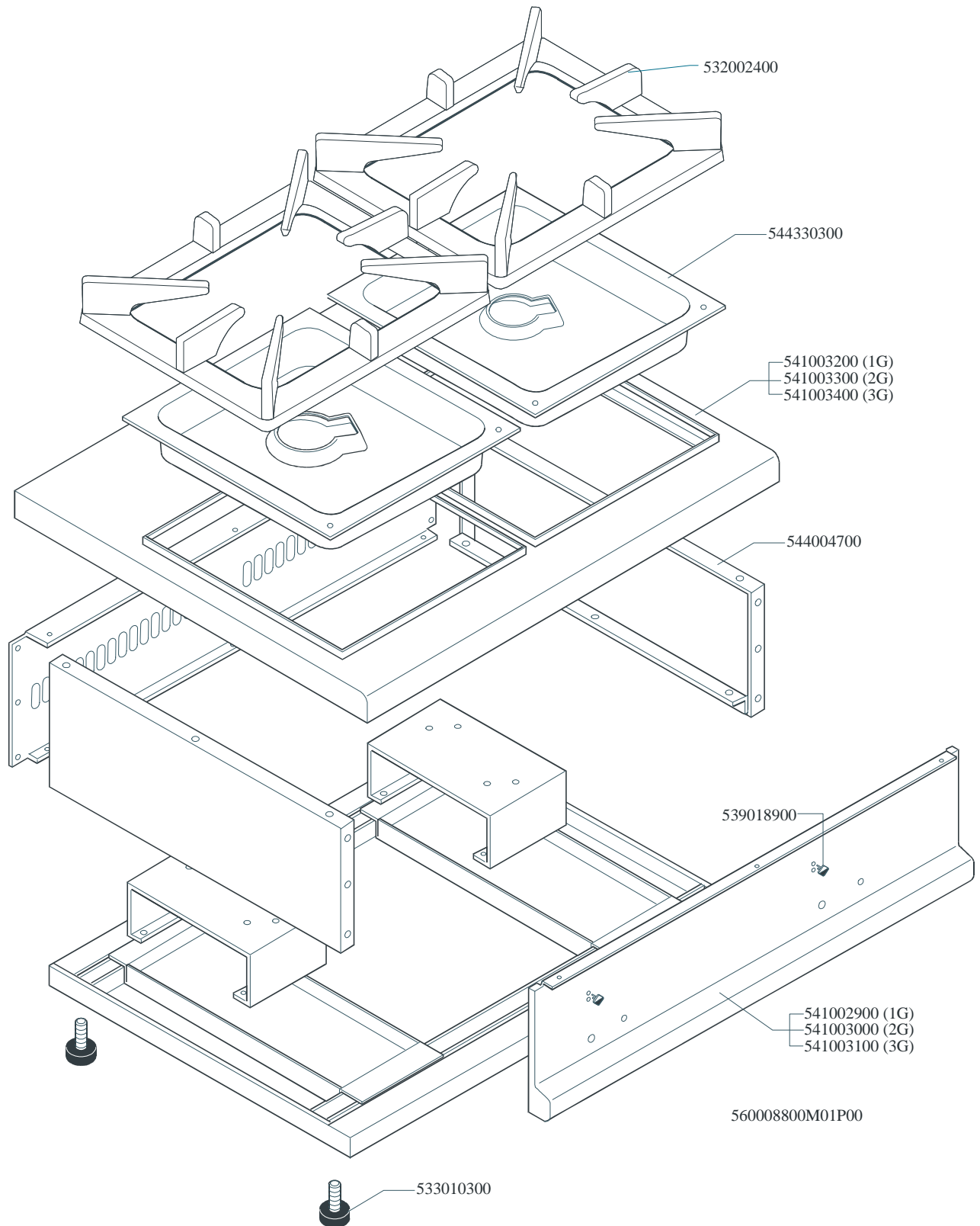

FO-1G FO-2G FO-3G

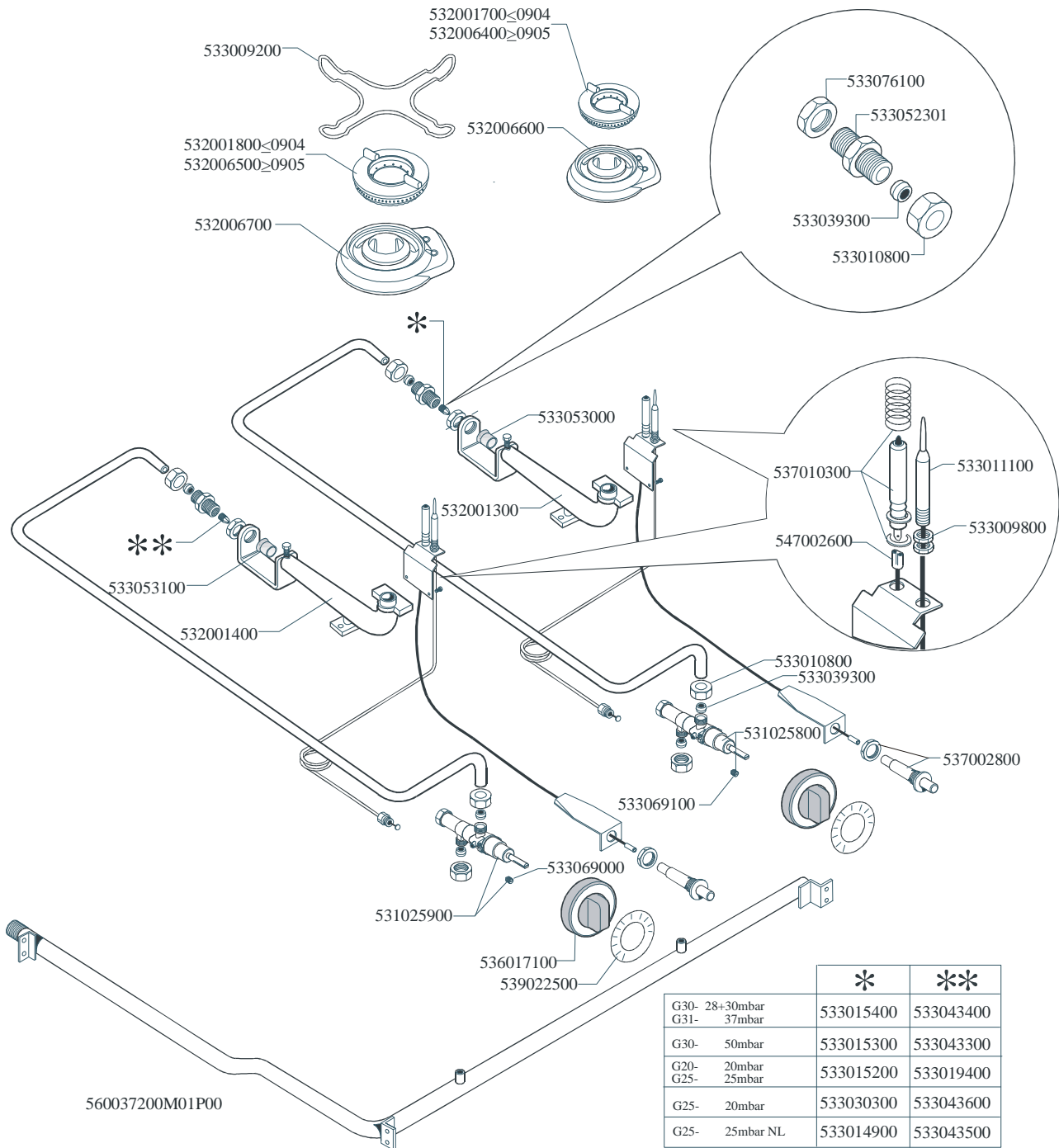

Page	Pos	Code	Description
001		532002400	1 FLAME GRILL 372X346 (FO)
001		544330300	ANAMELLED BURNER DRIP TRAY 2/3
001		541003200	UPPER PLATE FO-1G
001		544004700	SIDE OF FO
001		539018900	INDEX FOR KNOB
001		541002900	CONTROL PANEL FO-1G
001		533010300	ADJUSTABLE FOOT M10*20 D.23
002		532001700	QUICKBURNER §82
002		532006400	QUICKBURNER 2 RING Ø082 3 Z
002		533009200	REDUCTION FOR 65 AND 70 LINE
002		532006600	BURNER BODY 3,5 KW WITH PLUG
002		532001800	QUICKBURNER §102
002		532006500	QUICKBURNER 2 RING Ø102 3 Z
002		532006700	BURNER BODY 5,5 KW WITH PLUG
002		533076100	HEXAGONAL NUT M14X1 H4 + BUSHING
002		533052301	JOINT FOR NOZZLE HOLDER
002		533039300	BICONE §10
002		533010800	TUBE NUT D.10 M16*1,5
002		533053000	AIR ADJUSTMENT BUSHING §18
002		532001300	BURNER VENTURI 3,5 KW
002		537010300	PLUG IGNITION WITH SPRING PC65
002		547002600	HIGH-VOLTAGE CABLE L=500
002		533011100	THERMOCOUPLE 600 M8*1
002		533009800	BRASS NUT M8*1
002		533053100	AIR ADJUSTMENT BUSHING §20
002		532001400	BURNER VENTURI 5,5 KW
002		537002800	PIEZOELECTRIC IGNITION M18
002		531025800	SAFETY TAP 20S-B PEL20S2160
002		533069100	BY PASS COCK §60 20S
002		533069000	BY PASS COCK §70 20S-21S
002		531025900	SAFETY TAP 20S-B PEL20S21070
002		536017100	BLACK KNOB §70 PIN §8*6,5
002		539022500	ADHESIVE GRADUATED DISC FOR KNOB
002		533015400	NOZZLE §93 CH12*14 G-PC4 R
002		533043400	NOZZLE §117 CH12*14 G-PC4 UR
002		533015300	NOZZLE §82 CH12*14 F-PC4 R
002		533043300	NOZZLE §103 CH12*14 F-PC4 UR
002		533015200	NOZZLE §145 CH12*14 F-FP/CP6
002		533019400	NOZZLE §180 CH12*14 L-FQ5
002		533030300	NOZZLE §160 CH12*14 M-FPG
002		533043600	NOZZLE §200 CH12*14 L-PC4 UR
002		533014900	NOZZLE §150 CH12*14 F-FQ5 L-FQ6
002		533043500	NOZZLE §190 CH12*14 G25 PC4R