

COOKING APPLIANCES

COOKING LINES

TYPE: CT

Accessories
WITHOUT ACCESSORY

Spare parts manual

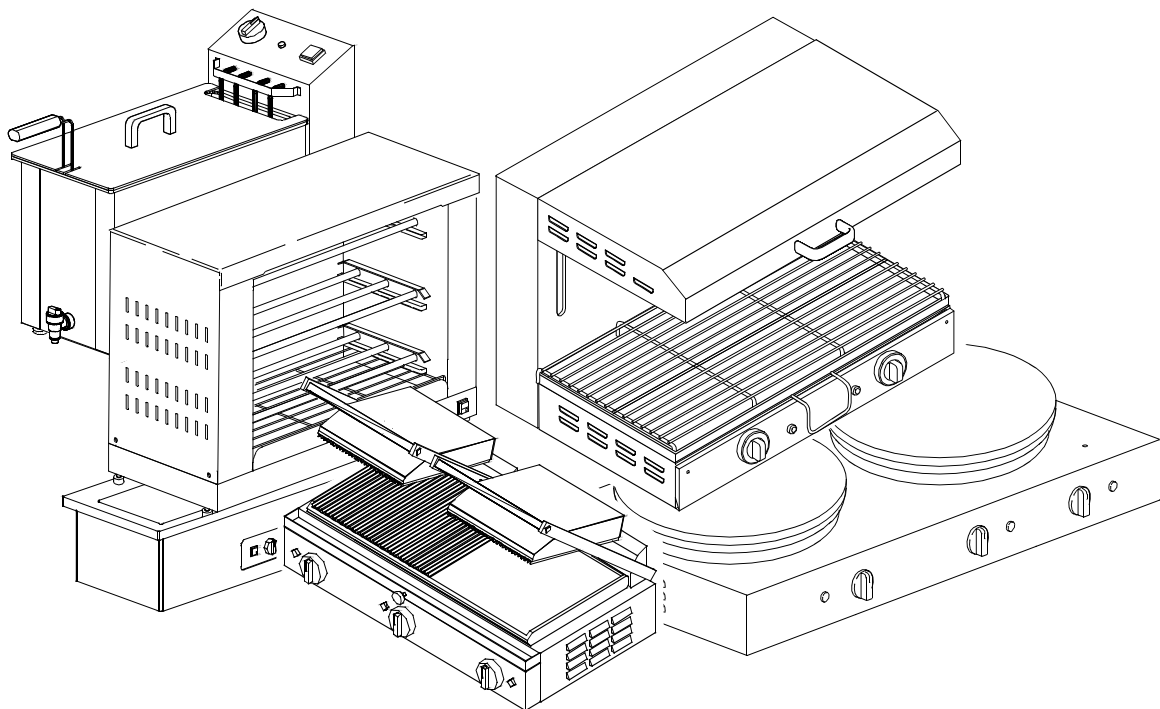

S/N:

Valid from:..10/2003

Rev.: 3.0

1. Spare parts

| | |
|--|-----------|
| Toaster F6 | 7 |
| Toaster F60 | 9 |
| Toaster F12 | 11 |
| Toaster F120 | 13 |
| Crepe-X1 | 15 |
| Crepe-X2 | 17 |
| Single grill | 19 |
| Double grill..... | 21 |
| Salamander S1 | 23 |
| Salamander S2..... | 25 |
| Bain Marie BM100-200-300 | 27 |
| 5M-6M/T-8T deep-fryer | 29 |
| 5+5M-6+6M/T-8+8T deep-fryer | 31 |

1.1 Voltage codes

| Voltage code | Voltage |
|--------------|----------------------|
| A | 3/N/PE~400/230V 50Hz |
| B | ~250V 16A 50Hz |
| C | 3/N/PE~380/220V 50Hz |
| D | 3/PE~200V 50-60Hz |
| F | 2/PE 220-240V 50Hz |
| G | 3/N/PE~415/240V 50Hz |
| H | 3/PE~230V 50Hz |
| I | 3/PE~220V 60Hz |
| J | 3/PE~380 50Hz |
| K | 3/PE~400V 50Hz |
| L | 3/PE~415V 50Hz |
| M | 3/PE~440V 60Hz |
| N | 3/PE~460V 60Hz |
| O | 3/PE~480V 60Hz |
| P | 1/N/PE~220-240V 50Hz |
| R | 2/PE~220-230V 60Hz |
| S | 3/N/PE~400/230V 50Hz |
| T | 3/PE~230V 60Hz |

1.2 Product codes

| Product code | Full name |
|-----------------|-------------------|
| Model codes | |
| | |
| Type codes | |
| 50U | 50U |
| 50D | 50D |
| 50 | 50 |
| 52S | 52S |
| 52D | 52D |
| 52 | 52 |
| 53S | 53S |
| 53D | 53D |
| 53 | 53 |
| 54F | 54F |
| 54R | 54R |
| 54 | 54 |
| 55 | 55 |
| 59 | 59 |
| CT | CT |
| BW | BW |
| Accessory codes | |
| wa | WITHOUT ACCESSORY |

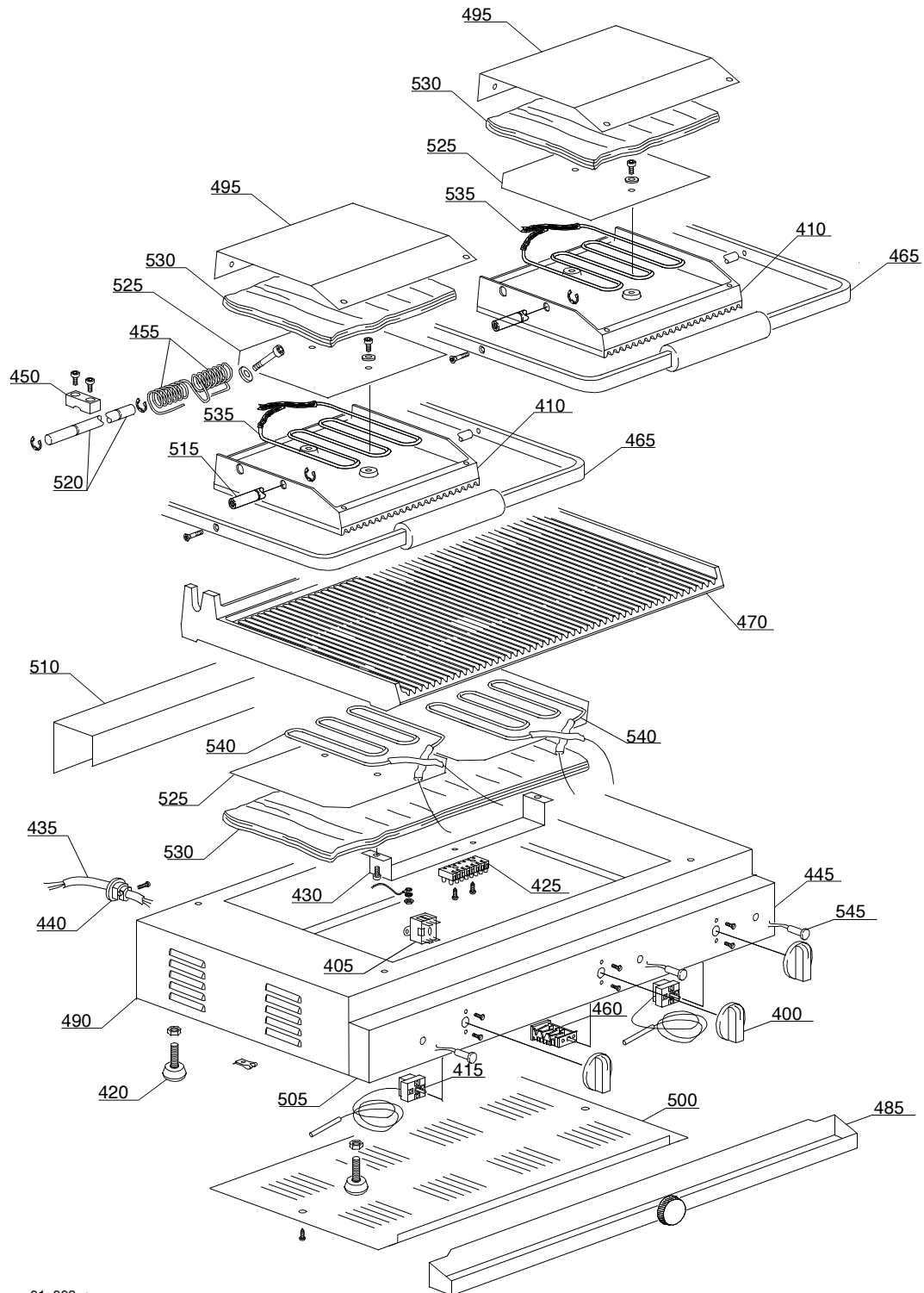

01_003_e

Spare parts

| ID | P-code | Model | Type | Accessory | Voltage | Description |
|---------------------|---------|-------|--------------|-----------|---------|---|
| MODULE:Double grill | | | | | | |
| 400 | 8029 | | BW,CT,53,53D | | | Timer knob |
| 405 | 6011 | | BW,CT,53,53D | | | Safety thermostat |
| 410 | 9002 | | BW,CT,53,53D | | | Top plate |
| 415 | 9010 | | BW,CT,53,53D | | | Plate thermostat |
| 420 | 9024 | | BW,CT,53,53D | | | Plate small foot |
| 425 | 9031 | | BW,CT,53,53D | | | 8 poles terminal board |
| 430 | 9032 | | BW,CT,53,53D | | | Stainless steel plate control panel |
| 435 | 9034 | | BW,CT,53,53D | | | Power supply cable |
| 440 | 9035 | | BW,CT,53,53D | | | Plate cable-fastener |
| 445 | 9511 | | BW,CT,53,53D | | | Double plate panel |
| 450 | 9560 | | BW,CT,53,53D | | | Brass clutch |
| 455 | 9563 | | BW,CT,53,53D | | | Cover tension spring |
| 460 | 9564 | | BW,CT,53,53D | | | Plate switch |
| 465 | 9566 | | BW,CT,53,53D | | | Double plate handle |
| 470 | 9700 | | BW,CT,53,53D | | | Lined-smooth lower cast iron single plate |
| 470 | 9701 | | BW,CT,53,53D | | | Lined lower cast iron double plate |
| 470 | 9702 | | BW,CT,53,53D | | | Smooth lower cast iron double plate |
| 485 | 9703 | | BW,CT,53,53D | | | Double plate gathering tray |
| 490 | 9704 | | BW,CT,53,53D | | | Double plate external body |
| 495 | 9705 | | BW,CT,53,53D | | | Top cast iron double plate cover |
| 500 | 9706 | | BW,CT,53,53D | | | Bottom protection |
| 505 | 9707 | | BW,CT,53,53D | | | Double plate frontal electric components holder |
| 510 | 9708 | | BW,CT,53,53D | | | Double plate back protection |
| 515 | 9711 | | BW,CT,53,53D | | | Double plate balance pin |
| 520 | 9712 | | BW,CT,53,53D | | | Double plate lifting pin |
| 525 | 9714 | | BW,CT,53,53D | | | Double plate protection |
| 530 | 9715 | | BW,CT,53,53D | | | Double plate insulating panel |
| 535 | 9716 | | BW,CT,53,53D | | | 1000W top heating element |
| 540 | 9717 | | BW,CT,53,53D | | | 1200W lower heating element |
| 545 | 10711/B | | BW,CT,53,53D | | | Pilot light |