

MAGIC SNACK 60

GAS / GAS / GAS / GAZ

FT...-61G... FT...-62G... FT...-63G... FT...-64G...

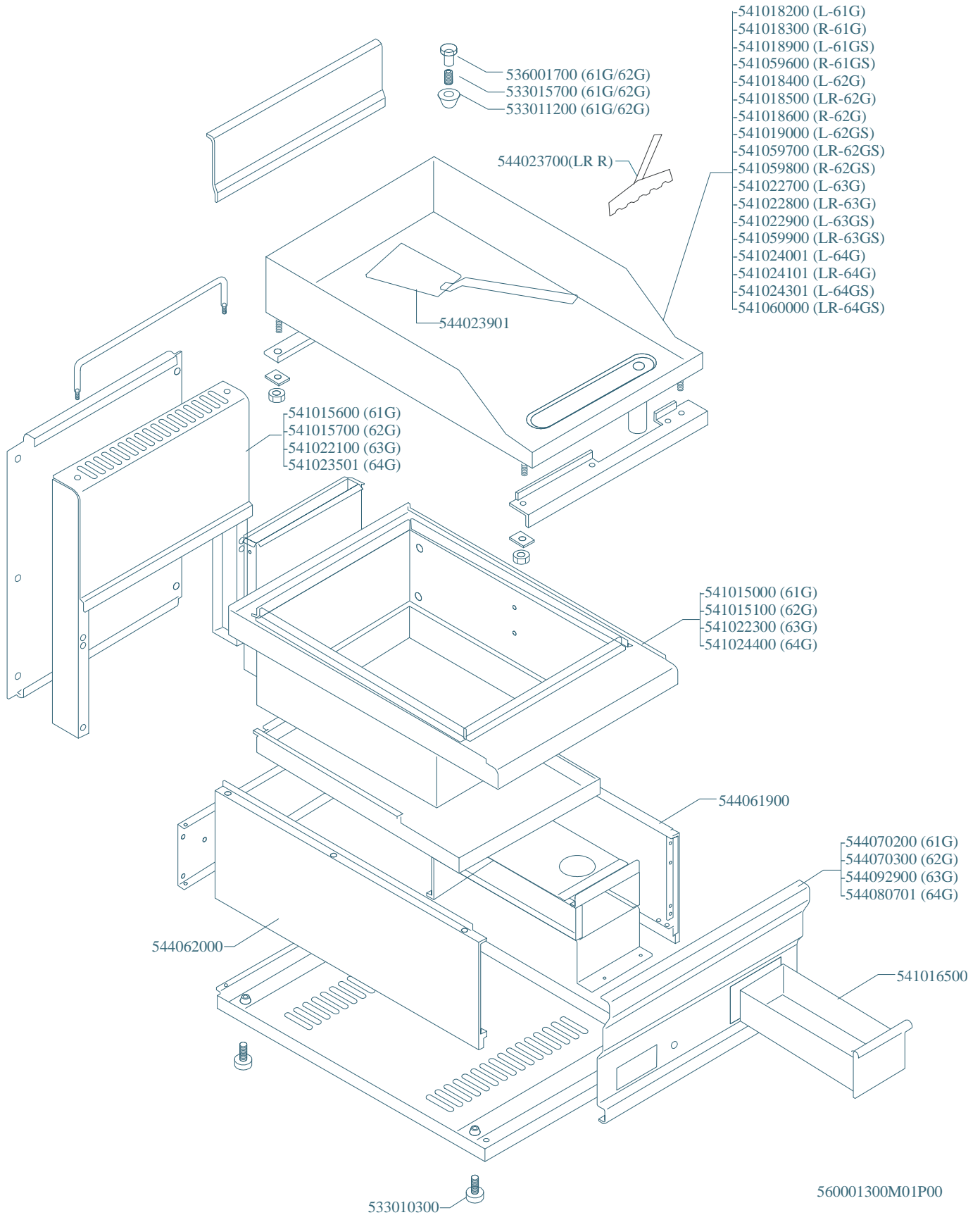

MAGIC SNACK 60

GAS / GAS / GAS / GAZ

FT...-61G... FT...-62G... FT...-63G... FT...-64G...

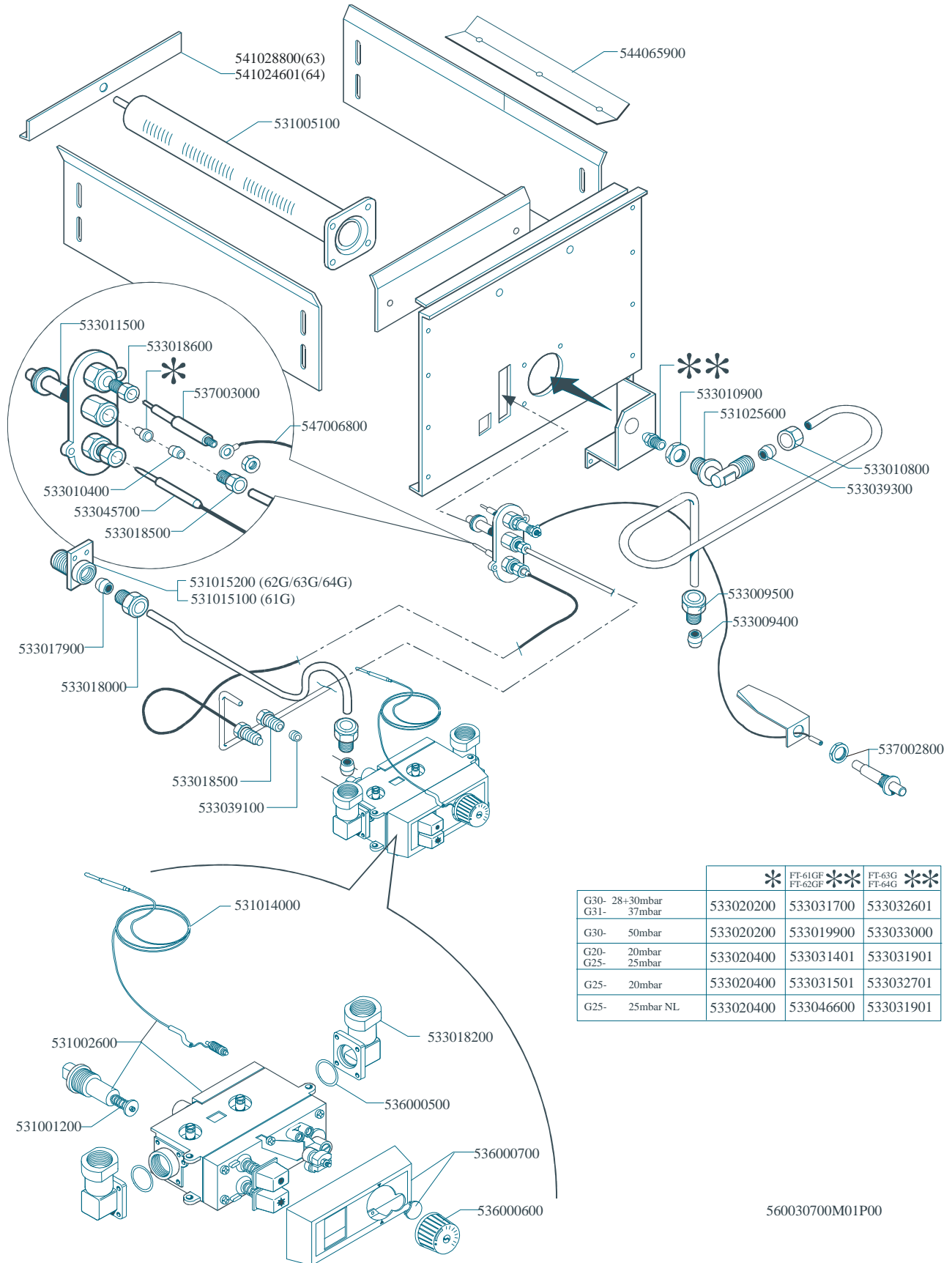

| | | * FT-61GF FT-62GF * | FT-63G FT-64G * |
|----------------|-----------|------------------------|--------------------|
| G30- 28+30mbar | 533020200 | 533031700 | 533032601 |
| G31- 37mbar | 533020200 | 533019900 | 533033000 |
| G30- 50mbar | 533020200 | 533031401 | 533031901 |
| G20- 20mbar | 533020400 | 533031501 | 533032701 |
| G25- 25mbar | 533020400 | 533046600 | 533031901 |
| G25- 25mbar NL | 533020400 | | |

560030700M01P00

| Page | Pos | Code | Description |
|------|-----|-----------|-------------------------------------|
| 001 | | 541018400 | SMOOTH PLATE FTL-62G |
| 001 | | 536001700 | GRIP D.25*19*M6 |
| 001 | | 533015700 | HEADLESS SCREW M6*20 |
| 001 | | 533011200 | SCREW PLUG FOR DRAIN FT-61 |
| 001 | | 544023901 | SPATTLE FOR FRY-TOP |
| 001 | | 541015700 | PERFORATED SPACER 62 |
| 001 | | 541015100 | UPPER PLATE FT-62G |
| 001 | | 544061900 | RIGHT SIDE PANEL 60 LINE |
| 001 | | 544070300 | CONTROL PANEL FT-62G |
| 001 | | 541016500 | DRIP TRAY FT-61 |
| 001 | | 544062000 | LEFT SIDE PANEL 60 LINE |
| 001 | | 533010300 | ADJUSTABLE FOOT M10*20 D.23 |
| 002 | | 544065900 | |
| 002 | | 531005100 | BURNER 511/11 |
| 002 | | 533011500 | PILOT BURNER 2 FLAMES 220 |
| 002 | | 533018600 | PLUG FITTING |
| 002 | | 537003000 | PLUG M4 - LONG ELECTRODE |
| 002 | | 547006800 | HIGH-VOLTAGE CABLE OCC.§4-TUBE§2 L7 |
| 002 | | 533010400 | BICONE D.6 |
| 002 | | 533045700 | THERMOCOUPLE M9*1 500 |
| 002 | | 533018500 | FITTING FOR BICONE D.6 M10*1 |
| 002 | | 533010900 | NUT M14*1 H.4 |
| 002 | | 531025600 | ELBOW 90° NOZZLE-HOLDER §10 PIPE |
| 002 | | 533010800 | TUBE NUT D.10 M16*1,5 |
| 002 | | 533039300 | BICONE §10 |
| 002 | | 533009500 | NIPPLE FOR BICONE 10S |
| 002 | | 533009400 | BICONE 10S |
| 002 | | 537002800 | PIEZOELECTRIC IGNITION M18 |
| 002 | | 531015200 | 1/2" G- TWO WAY 3/8" G FITTING |
| 002 | | 533017900 | BICONE D.12 |
| 002 | | 533018000 | ELBOW FOR BICONE D.12 3/8 RS L20 |
| 002 | | 533039100 | BICONE §6 |
| 002 | | 531014000 | VALVE CAPILLARY PROBE - FT |
| 002 | | 533018200 | ELBOW OR GJ 3/8 |
| 002 | | 536000500 | O-RING FOR MINISIT FITTING |
| 002 | | 536000700 | PLASTIC COVER FOR MINISIT + SCREW |
| 002 | | 536000600 | BLACK LHD KNOB OP. FOR MINISIT |
| 002 | | 531002600 | MINISIT VALVE FO S/RP |
| 002 | | 531001200 | MAGNET AC/2-MINISIT |
| 002 | | 533020200 | PILOT JETS 0160 FOR LPG §30 |
| 002 | | 533020400 | NOZZLE 0160 (NATURAL GAS) 51 |
| 002 | | 533031700 | NOZZLE §105 CH-12*30 G30 CE GFT6 |
| 002 | | 533019900 | NOZZLE §90 G-FT3 F-FT-B2 |
| 002 | | 533031401 | NOZZLE §155 CH12X30 G20 MH-B2/FT |
| 002 | | 533031501 | NOZZLE §170 CH12X30,0 |
| 002 | | 533046600 | NOZZLE §161 G25 |