

MAGIC SNACK 60

GAS / GAS / GAS / GAZ

FT...-61G... FT...-62G... FT...-63G... FT...-64G...

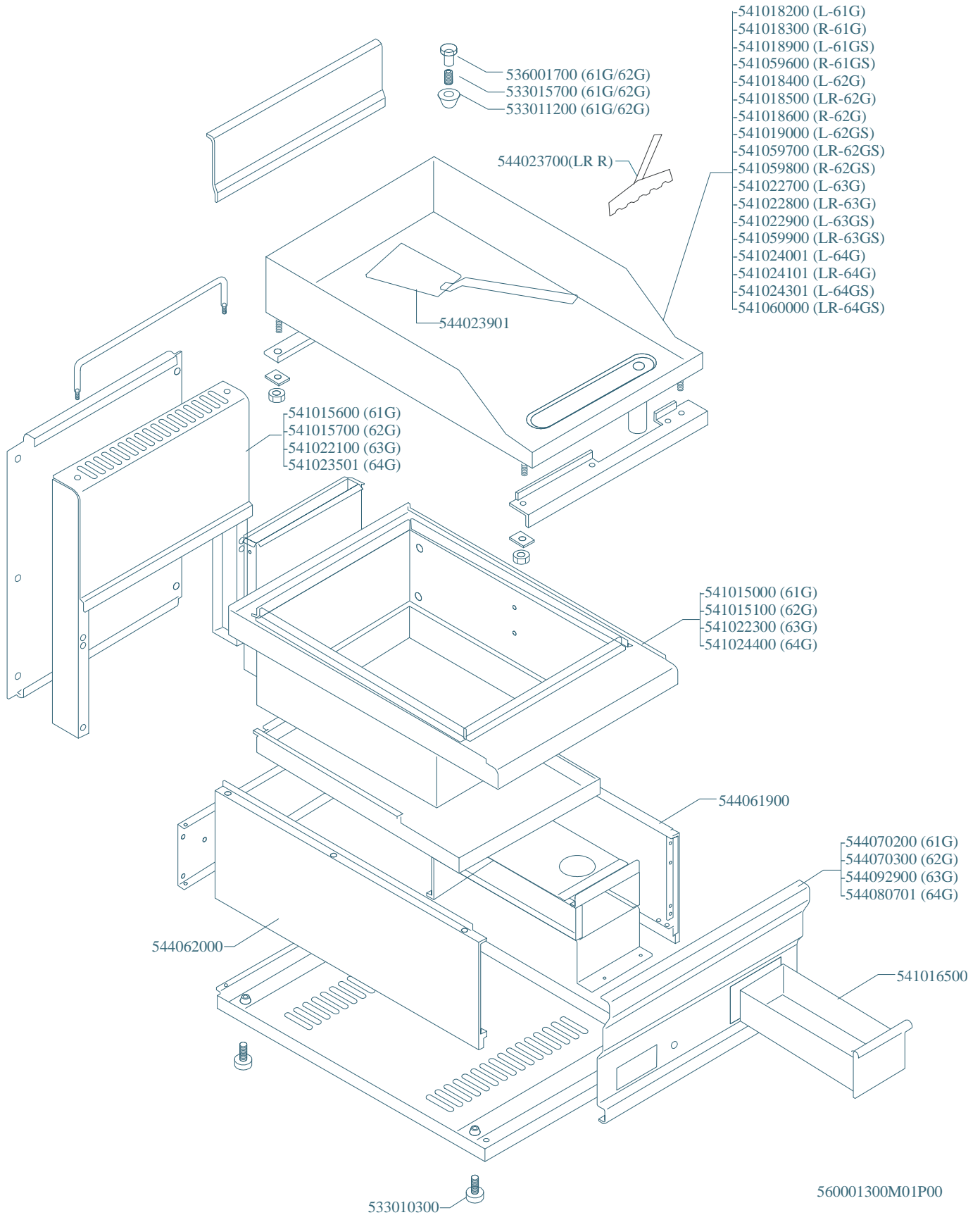

MAGIC SNACK 60

GAS / GAS / GAS / GAZ

FT...-61G... FT...-62G... FT...-63G... FT...-64G...

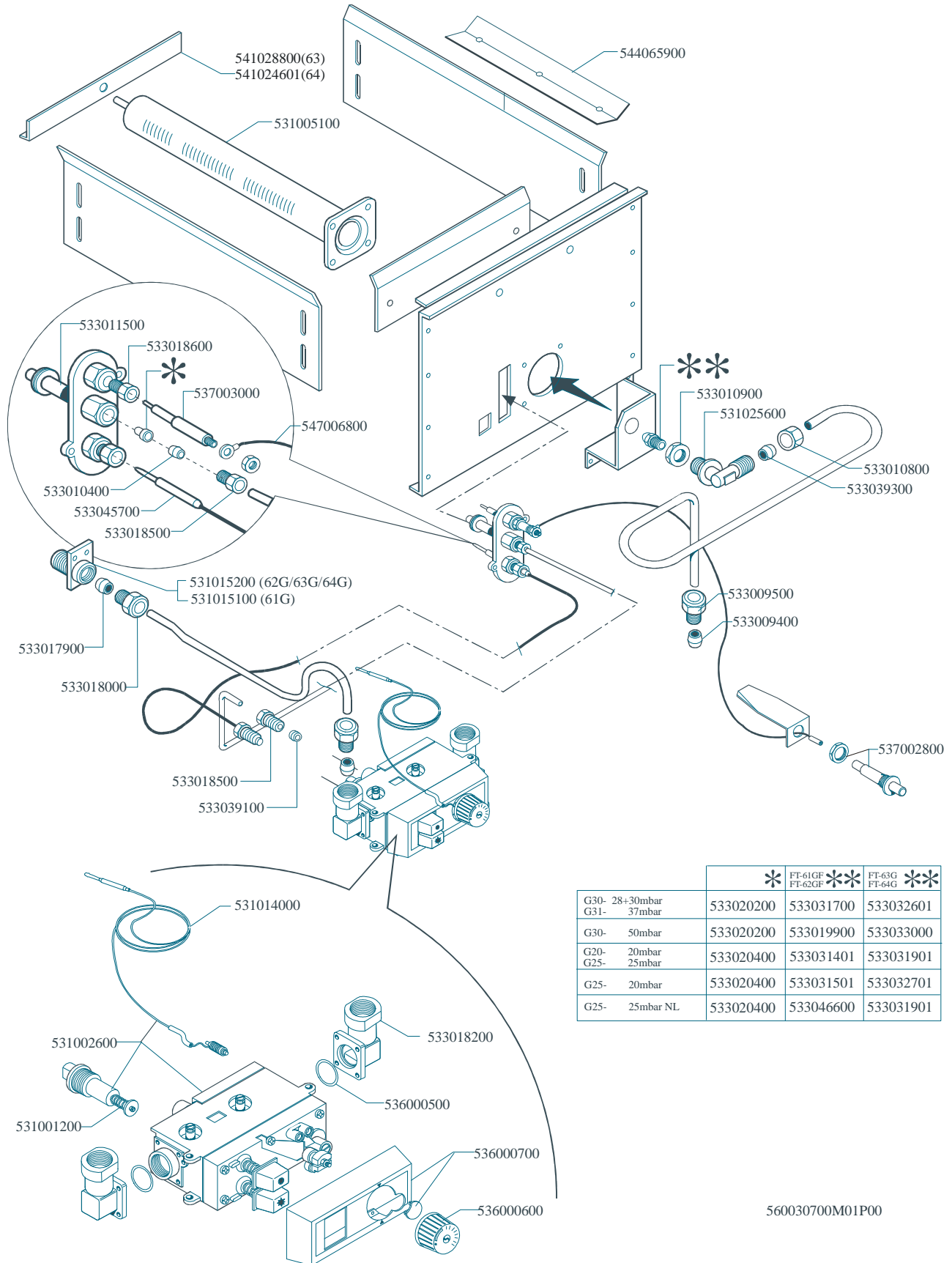

		*	FT-61GF FT-62GF	**	FT-63G FT-64G	**
G30- 28+30mbar		533020200	533031700		533032601	
G31- 37mbar		533020200	533019900		533033000	
G30- 50mbar		533020200	533019900		533033000	
G20- 20mbar		533020400	533031401		533031901	
G25- 25mbar		533020400	533031501		533032701	
G25- 25mbar NL		533020400	533046600		533031901	

560030700M01P00

Page	Pos	Code	Description
001		544023700	
001		541060000	CHROME PLATE FTLR-64G
001		544023901	SPATTLE FOR FRY-TOP
001		541023501	HOLED SPACER 64
001		541024400	UPPER PLATE FT-64G
001		544061900	RIGHT SIDE PANEL 60 LINE
001		544080701	CONTROL PANEL FT-64G CE
001		541016500	DRIP TRAY FT-61
001		544062000	LEFT SIDE PANEL 60 LINE
001		533010300	ADJUSTABLE FOOT M10*20 D.23
002		541024601	BURNERS SUPPORT FT-64G CE
002		544065900	
002		531005100	BURNER 511/11
002		533011500	PILOT BURNER 2 FLAMES 220
002		533018600	PLUG FITTING
002		537003000	PLUG M4 - LONG ELECTRODE
002		547006800	HIGH-VOLTAGE CABLE OCC.§4-TUBE§2 L7
002		533010400	BICONE D.6
002		533045700	THERMOCOUPLE M9*1 500
002		533018500	FITTING FOR BICONE D.6 M10*1
002		533010900	NUT M14*1 H.4
002		531025600	ELBOW 90° NOZZLE-HOLDER §10 PIPE
002		533010800	TUBE NUT D.10 M16*1,5
002		533039300	BICONE §10
002		533009500	NIPPLE FOR BICONE 10S
002		533009400	BICONE 10S
002		537002800	PIEZOELECTRIC IGNITION M18
002		531015200	1/2" G- TWO WAY 3/8" G FITTING
002		533017900	BICONE D.12
002		533018000	ELBOW FOR BICONE D.12 3/8 RS L20
002		533039100	BICONE §6
002		531014000	VALVE CAPILLARY PROBE - FT
002		533018200	ELBOW OR GJ 3/8
002		536000500	O-RING FOR MINISIT FITTING
002		536000700	PLASTIC COVER FOR MINISIT + SCREW
002		536000600	BLACK LHD KNOB OP. FOR MINISIT
002		531002600	MINISIT VALVE FO S/RP
002		531001200	MAGNET AC/2-MINISIT
002		533020200	PILOT JETS 0160 FOR LPG §30
002		533020400	NOZZLE 0160 (NATURAL GAS) 51
002		533032601	NOZZLE §85 CH12X30,0
002		533033000	NOZZLE §075 CH12X30,0
002		533031901	NOZZLE §130 CH12*30 MH-FT34
002		533032701	NOZZLE §146 CH12*30 L-FT34