



Thermische Geräte Serie 900 Gas-Fritteuse

Artikel-Nr. 144004 (9FRI/G610)

Explosionszeichnung / Ersatzteile

Bitte bei Ersatzteilbestellung immer Artikelnummer und Seriennummer mit angeben!

9FRI/G610

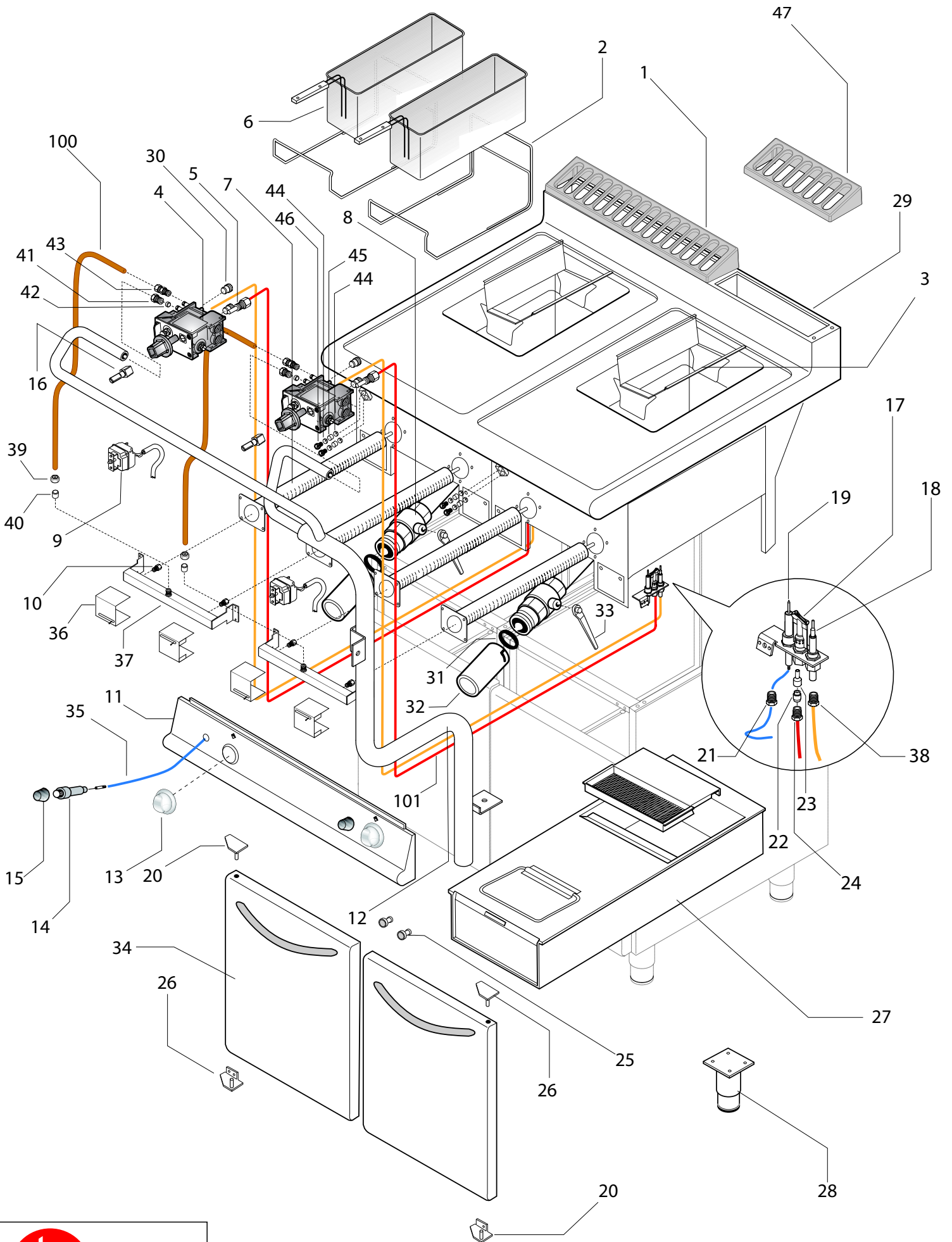



Series 900
Gas Fryer 9FRI/G610

Table_A

POS.	CODE	PIECES	DESCRIPTION	DATA	C
1	CR0901240	1	CHIMNEY GRID		
2	BN9000364	2	BASKET SUPPORT		
3	BN9560610	2	HEAT DEFLECTOR		
4	MACM097000	2	GAS VALVE		C
5	MA1394700	2	PILOT FITTING		
6	BN9000337	2	BASKET		
7	BN2519430	4	BURNER		
8	BN6A023020	2	DRAIN VALVE		C
9	BN6A049401	2	SAFETY THERMOSTAT		C
10	TABLE B	4	BURNER NOZZLE		
11	CR0905940	1	CONTROL PANEL		
12	CR0905970	1	GAS SUPPLY PIPE		
13	CR0905990	2	KNOB		C
14	BN6A041105	2	PIEZO		C
15	BN826630420	2	PIEZO CAP		
16	BN2518670	2	KNOB EXTENSION		C
17	BN6A013220	2	PILOT ASSEMBLY		C
18	MA1950100	2	THERMOCOUPLE		C
19	BN6A013302	2	ELECTRODE		C
20	BN2547870	2	HINGE		
21	MA1888400	2	ELECTRODE NUT		
22	BN6A016900	2	BICONE		
23	TABLE B	2	PILOT NOZZLE		C
24	BN6A017000	2	NUT		
25	CR0587700	2	MAGNET		
26	BN2547860	2	HINGE		
27	CR1020200	1	OIL TRAY (OPTIONAL)		
28	MA6086113	4	FOOT		
29	BN826134792	1	TANK ASSEMBLY		
30	MA1888200	4	3/8" PLUG		
31	BN8217550	2	O-RING		C
32	BN9000619	1	DRAIN EXTENSION		
33	BN6A023021	2	DRAIN VALVE LEVER		
34	BN826901280	2	DOOR		
35	BN2510616	2	PIEZO CABLE		C
36	BN9560380	4	AIR REGULATOR		
37	BN9000650	2	GAS SUPPLY PIPE		
38	MA1891700	2	THERMOCOUPLE FITTING		
39	BN6A011475	2	NUT		
40	BN6A011470	2	BICONE		
41	MA459300	2	3/8" FITTING		
42	MA417810	2	BICONE		
43	BN822450170	2	3/8" FITTING		
44	BN6A038803	8	CAPILLARY OIL PROOF WASHER		C
45	BN6A038804	2	CAPILLARY OIL PROOF GRAPHITE CYLINDER		C
46	BN6A038801	2	CAPILLARY FITTING		
47	CR0901250	1	CHIMNEY GRID		
100	BN41823561541	1	VALVE-BURNER GAS PIPE		
	BN822450170	1	3/8" FITTING		
	BN6A011475	1	NUT		
	BN6A011470	1	BICONE		
101	BN41823561531	1	VALVE-PILOT PIPE		
	MA1394700	1	PILOT FITTING		
	BN6A017000	1	NUT		
	BN6A016900	1	BICONE		

C >>> Recommended exchange



Serie 900
Series 900

Tabella_B \ Table_B

POS	POW	COD	DIAM	GAS
10	9,5Kw+9,5Kw	BN2510506	ø 100	•
10	9,5Kw+9,5Kw	BN2510065	ø 110	○
10	9,5Kw+9,5Kw	BN2510717	ø 170	◻
10	9,5Kw+9,5Kw	BN2510507	ø 185	▲
10	9,5Kw+9,5Kw	BN6A015880	ø 195	▼
23		BN6A013240	ø 16,2	• ○
23		BN6A013230	ø 27,2	◻ ▲ ▼

ID GAS

- G30/50 ○ G30/28÷37 (G30÷31/37)
- ◻ G20/20 ▲ G25/25 ▼ G25/20 (G25.1/25) (G20/25)
- (G110 8mbar) (G120 8mbar)