

	*	**
G30- 28+30mbar G31- 37mbar	533020200	533046400
G30- 50mbar	533020200	533046300
G20- 20mbar G25- 25mbar	533020400	533032801
G25- 20mbar	533020400	533019800
G25- 25mbar NL	533020400	533046500

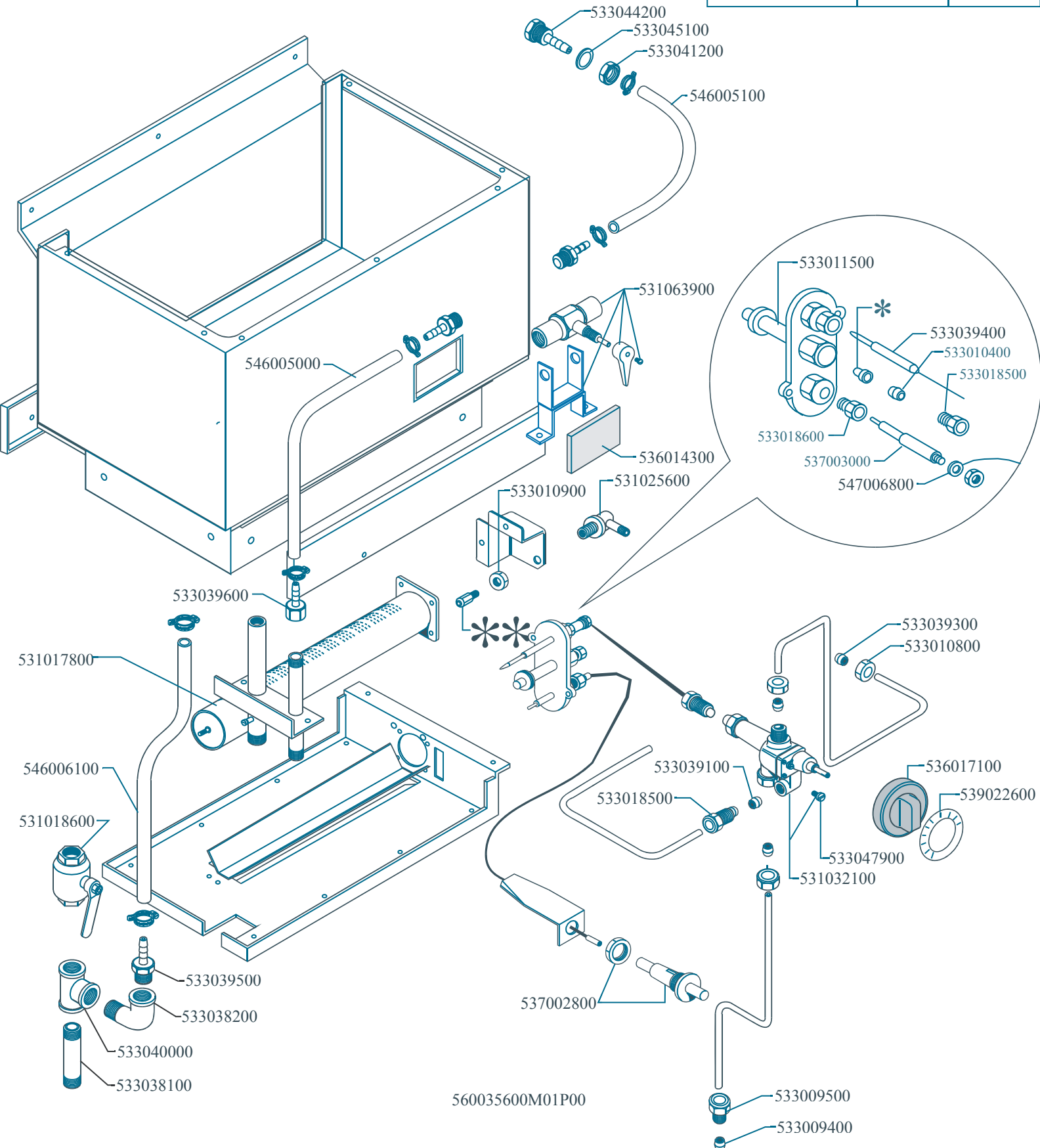

Page	Pos	Code	Description
001		531020200	FLUE GRID 300"S65"
001		541072800	PERFORATED SPACER 6
001		536001700	GRIP D.25*19*M6
001		544244500	TANK LID CPM-62/6G
001		531017900	PASTACOOKER BASKET 1/3 160X290X200H
001		531042800	SEMISPHERE FILTER
001		536005300	PLASTIC LED 2"
001		541047900	LEFT DOOR 30
001		541047800	RIGHT DOOR 30
001		536000200	D.12 H.4 BUMPER
001		544293500	CONTROL PANEL CPM-6G
001		539018900	INDEX FOR KNOB W/RED SIGN
001		541079100	FRAME CPM-6G
001		541079000	UPPER PLATE CPM-6G
001		531018000	BASKET SUPPORT GRID CPM-62G
001		536006400	BLACK HANDLE 65/FE/FG
002		533044200	H.20 INPUT FITTING
002		533045100	GASKET §E24*§I18*SP.1,5
002		533041200	HEXAGONAL NUT 3/8" G
002		546005100	RUBBER TUBE §10INT.*§18EXT.*L=450
002		531063900	BALL VALVE 3/4"G F-F (1320PEL
002		546005000	RUBBER TUBE §I10E18*L=900 100°C
002		536014300	INSPECTION HOLE GLASS PANE CPM-62G
002		531025600	ELBOW 90° NOZZLE-HOLDER §10 PIPE
002		533010900	NUT M14*1 H.4
002		533039600	PIPE HOLDER 1/2" G F D.12
002		531017800	BURNER CPM-62G POLID.103.1515.0
002		546006100	RUBBER TUBE §25INT.*§33EXT.*L=540
002		531018600	BALL VALVE 1"G M-F CPM-62G
002		533039500	PIPE HOLDER 1/2" G M D.12
002		533038200	1" G M-F ELBOW FITTING
002		533040000	1"G F-F-F "T" FITTING
002		533038100	LOWER DRAIN PIPE CPM-62G
002		533009400	BICONE 10S
002		533009500	NIPPLE FOR BICONE 10S
002		537002800	PIEZOELECTRIC IGNITION M18 WITH NUT
002		533018500	FITTING FOR BICONE D.6 M10*1
002		531032100	GAS COCK 21S P.V.BY-PASS Ø100
002		533047900	BY PASS COCK §100 21S
002		539022600	GRADUATED STICKER FOR KNOB
002		536017100	BLACK KNOB §70 PIN §8*6,5
002		533010800	TUBE NUT D.10 M16*1,5
002		533039300	BICONE §10
002		547006800	HIGH-VOLTAGE CABLE OCC.§4-TUBE§2 L7
002		537003000	PLUG M4 - LONG ELECTRODE
002		533018600	PLUG FITTING
002		533010400	BICONE D.6
002		533039400	THERMOCOUPLE M9*1*850
002		533011500	PILOT BURNER 2 FLAMES 220
002		533039100	BICONE §6
002		533020200	PILOT JETS 0160 FOR LPG §30

Page	Pos	Code	Description
002		533020400	NOZZLE 0160 (NATURAL GAS) 51
002		533046400	NOZZLE §185 CH12*30 G-CPM
002		533046300	NOZZLE §160 CH12*30 F-CPM
002		533032801	NOZZLE §280 CH12*30 M-CPM
002		533019800	NOZZLE §300 C-FT-B2
002		533046500	NOZZLE §290 CH12*30 L-CPM