



## Heißluftöfen & Kombidämpfer Heißluftofen

Artikel-Nr. 211025 (G824RUD)

---

### Explosionszeichnung / Ersatzteile

---

Bitte bei Ersatzteilbestellung immer Artikelnummer und Seriennummer mit angeben!

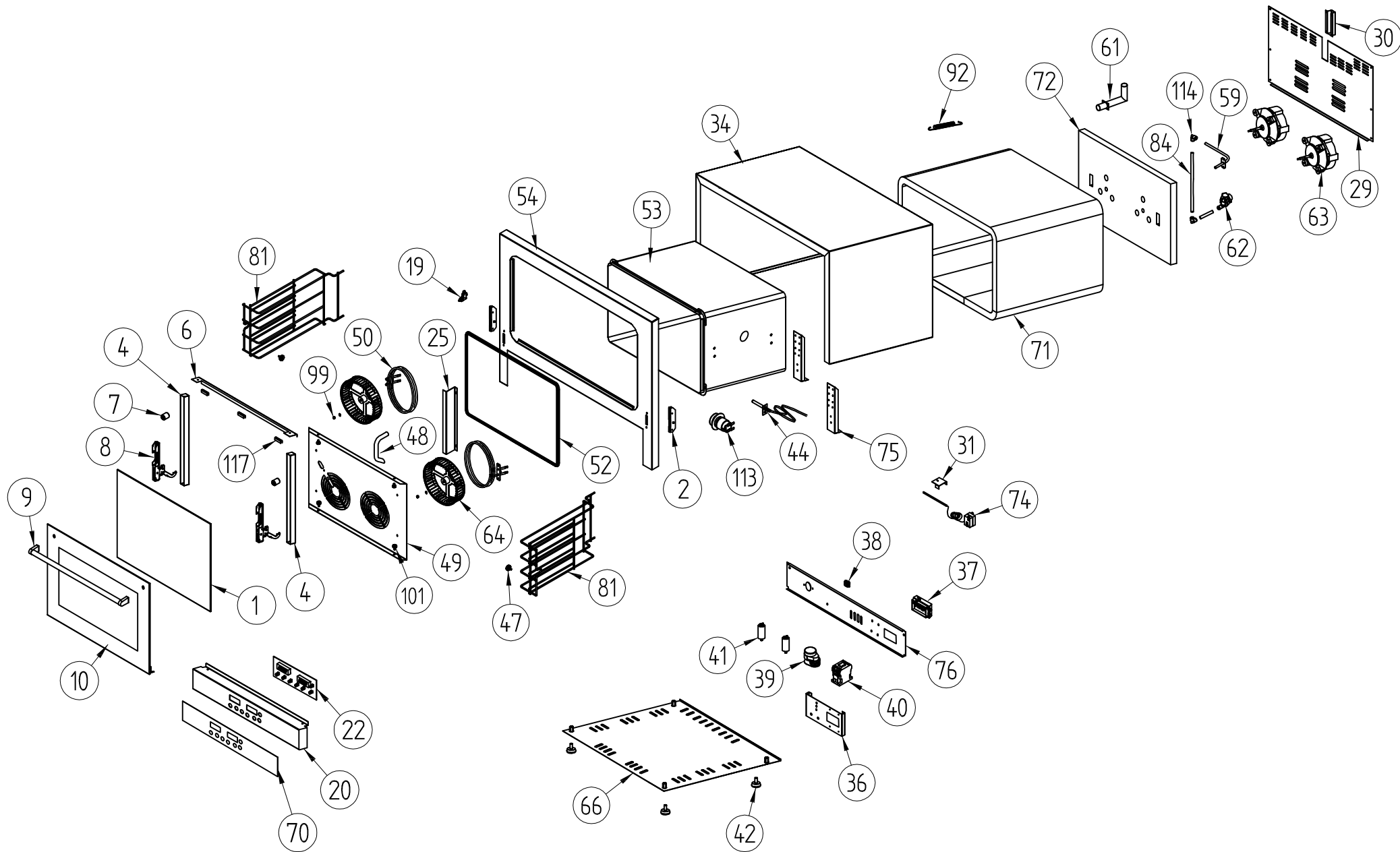

	4			TOLLERANZE: UNI 5307	SCALA	DENOMINAZIONE	ESPLOSO FORNO	DISEGNATO:	CONTE R.
	3			da 1 a 6      ±0,08		MATERIALE	..	MODELLO	FORNO 824RU DIGIT. BCE
	2			da 6 a 18    ±0,12		TRATTAMENTO	..	FILE	ESP30078-A
	1			da 18 a 50   ±0,18	DATA				
RELEASE		MODIFICHE	FIRMA	da 50 a 80   ±0,23	22/07/2011				
				da 80 a 120 ±0,27					
				da 120 a 250 ±0,33					
				da 250 a 400 ±0,42					
				da 400 a oltre ±0,50					

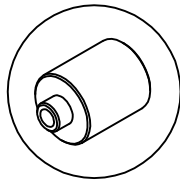

DETAIL 7

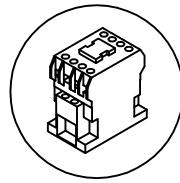

DETAIL 40

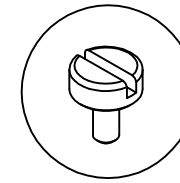

DETAIL 101

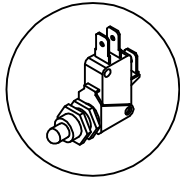

DETAIL 19

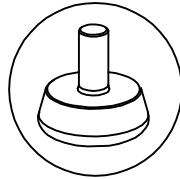

DETAIL 42

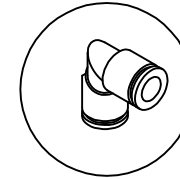

DETAIL 114

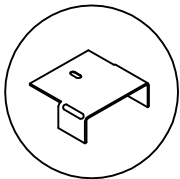

DETAIL 31

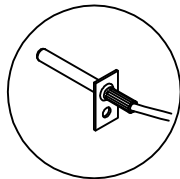

DETAIL 44

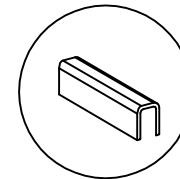

DETAIL 117

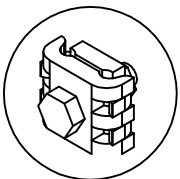

DETAIL 38

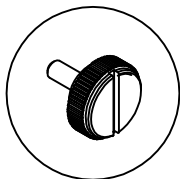

DETAIL 47

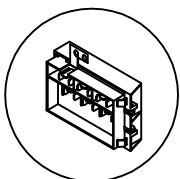

DETAIL 37

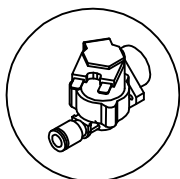

DETAIL 62

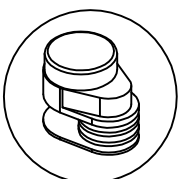

DETAIL 39

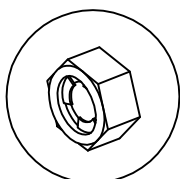

DETAIL 99

	4			TOLLERANZE: UNI 5307	SCALA		DENOMINAZIONE	PARTICOLARI ESPLOSO FORNO		DISEGNATO:	CONTE R.		
	3			da 1 a 6           ±0,08			MATERIALE	..	MODELLO	FORNO 824RU DIGIT. BCE	VERIFICATO	..	
	2			da 6 a 18         ±0,12			DATA	TRATTAMENTO	..	FILE	ESP30078-B	DISEGNO	.....
	1			da 18 a 50       ±0,18			22/07/2011						
RELEASE		MODIFICHE	FIRMA	da 50 a 80       ±0,23									
				da 80 a 120      ±0,27									
				da 120 a 250     ±0,33									
				da 250 a 400     ±0,42									
				da 400 a oltre   ±0,50									

## SPARE PART LIST 211025

CODE	DESCRIPTION	UM	Q	N. DRAW
VET30046	INT GLASS DOOR SP.6MM 824 TRASP TEMP	PZ	1	1
7424000002	HINGE 42009050	PZ	2	2
PRO30088	LAT. PROF. DOOR OVEN 824/820/524/523 430	PZ	2	4
PRO30087	PROFILE INTERNAL GLASS DOOR	PZ	1	6
PER30007	DOOR HINGE PORTA FE 37	PZ	2	7
CER30003	HINGE OVEN NV FORNO 800 VTR SP6 41015100	PZ	2	8
MAG30015	HANDLE F 823/824 PIR INT 760	PZ	1	9
VET00045	OVEN EXTERNAL GLASS SP.6MM 824 TRASP	PZ	1	10
PUL30004	SWITCH + 2 DADI ROLD VRSR21DA1AC26	PZ	1	19
CRU60074	FRONTAL PANEL NEW	PZ	1	20
SCH30008	ELECTRICAL BOARD ORIZ. VERSION MOD.500/800	PZ	1	22
SUP30111	SUPP DIV FANS 824 430	PZ	1	25
FON30072	BACK SUP. SIDE824 LAM ZIN	PZ	1	29
FON30071	BACK OUT HUM- 824/823/524/523 FEZN	PZ	1	30
PIA30037	SUPPORT BULB THERMOSTAT F824 430	PZ	1	31
FIA30042	LATERAL SIDE OVEN 824 430 SB 2B	PZ	1	34
SUP30113	SUP. FOR TEL. INV. 824/823 FEZN	PZ	1	36
MOR30002	THERMINAL BLOCK PA223 MOD. 800-934-936	PZ	1	37
MOR30001	THERMINAL BLOCK 6-16 MMQ(EQUIP)	PZ	1	38
PRG30005	PROGRAM. PWE5J02H624 50Hz	PZ	1	39
TEL30002	CONTACTOR 6A 4P 230 VAC 50/60 HZ 25A	PZ	1	40
CON30001	CONDENSOR	PZ	2	41
PIE30001	FOOT REGOLABILE M10 500-600-800	PZ	4	42
SON30004	PROBE PT100 CAVO L 1,5 M R4/2FA55V10NPN-f	PZ	1	44
VIT30001	SCREW	PZ	2	47
TUB30006	TUBE HUMIDIF.MOTO COVER IX304 934/936	PZ	1	48
DEF30022	MOTOR COVER 824RU 430 LUC	PZ	1	49
RES30010	HEATING ELEMENT 3000 W VENT 200 1GIK3N559001	PZ	2	50
GUA30002	GASKET MOD.500/600/800/900	MT	2,08	52
MUF30018	COOKING CHAMBER 824RU 430PVC LUC	PZ	1	53
FAC30021	FACE NEW	PZ	1	54
TUB30026	TUBE HUMIDIF. NV IX304 936/934/910	PZ	1	59
TUB30036	TUBE OUT HUM. 824 304	PZ	1	61
ELE30004	ELECTRIC VALVE SINGLE J-G COD159174240V	PZ	1	62
MOT30006	MOT.E.MFC80-A_H25 75W K02861-KO+COND.2,5	PZ	2	63
VEN30003	FAN UN F8 S 40PALE 304 2 BUG	PZ	2	64
FON30073	BACK SUPPORT FEET 824/823 LAM ZIN	PZ	1	66
FRO30166	FRONTAL P.	PZ	1	70
LAN30007	INSULATION F904 EUROVER 2000	PZ	1	71
LAN30005	INSULATION LOW 800/904 E.2000(UT.X LAN30010	PZ	1	72
TER30010	SECURITY THERMOSTAT 900MM VGS670MM	PZ	1	74
SUP30112	SUPP BACK COOKING CHAMBER 824/823/524/523 FEZN	PZ	2	75
FON30070	BACK LOWER SIDE 824,823,820 LAM ZIN	PZ	1	76
GRI30031	LATERAL GRID PAST.824 FE 37 CROM	PZ	2	81
TUB30028	TUBE RILSAN PA 11 6X8MM. ROT.100MT	MT	0,8	84
MOL30001	SPRING	PZ	10	92
DAD30005	DADO M5 AUTOFRENANTE DAX IN AISI 304	PZ	2	99
VIT30042	SCREW	PZ	6	101
LAM30004	LAMP-ALG G9,40W,GUA SIL 77208+VTR NOR	PZ	2	113
RAC30003	RACC. DA 8 A 90° R61680 ART 355 P8	PZ	2	114
GUA30004	GASKET MATR.3812 THERMIC-60/T BLACK	MT	0,12	117