

560096700M01P00

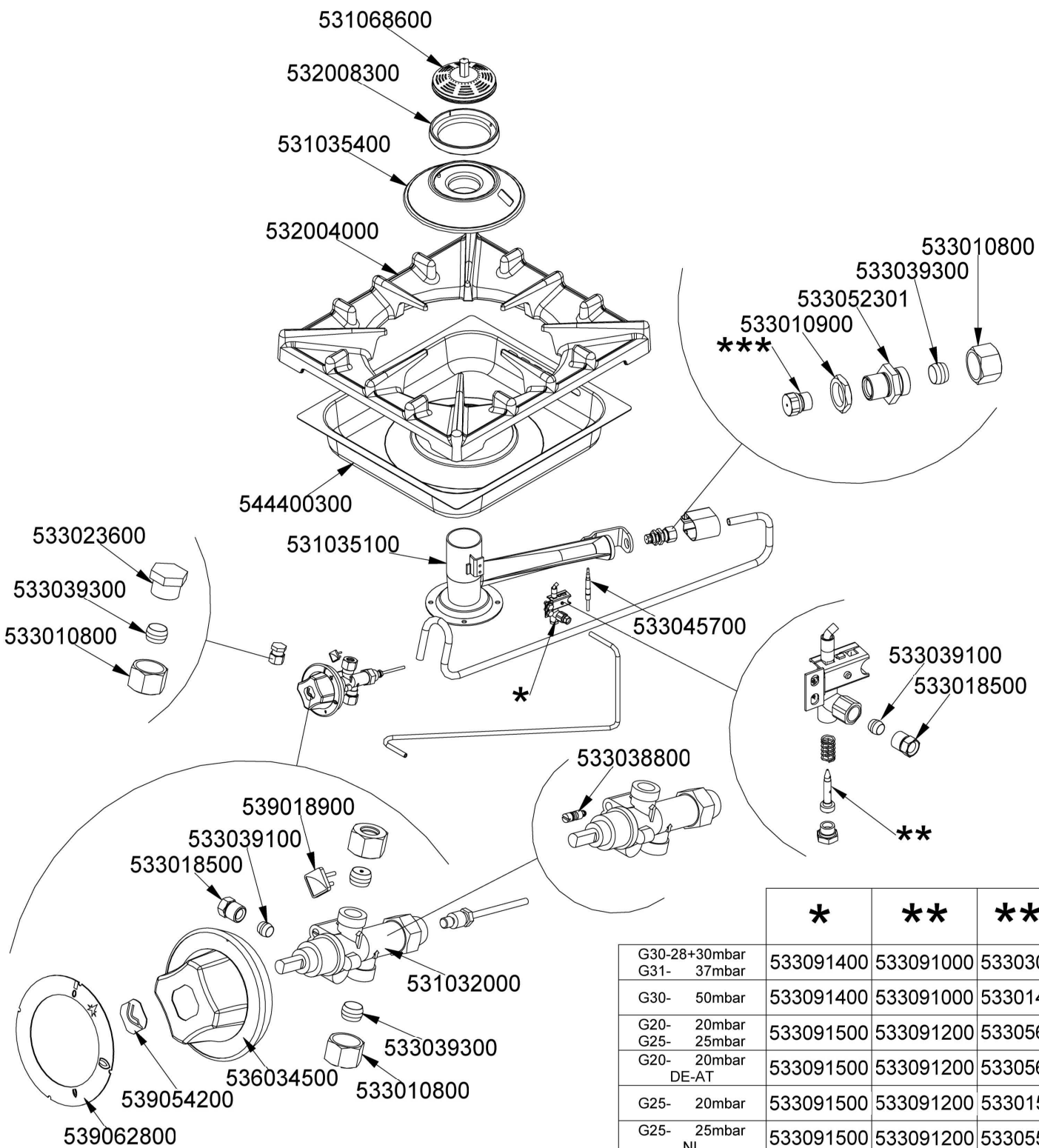

	*	**	***
G30-28+30mbar G31- 37mbar	533091400	533091000	533030800
G30- 50mbar	533091400	533091000	533014800
G20- 20mbar G25- 25mbar	533091500	533091200	533056200
G20- 20mbar DE-AT	533091500	533091200	533056200
G25- 20mbar	533091500	533091200	533015000
G25- 25mbar NL	533091500	533091200	533055400

560096800M01P00

Page	Pos	Code	Description
001		544678500	RING FOR PAN WOK Ø260 S90
001		541134000	NEUTRAL LOW SPACER 74
001		541196101	UPPER PLATE S70 PCW-74G
001		544385600	LEFT SIDE OF 70T LINE
001		541187500	CONTROL PANEL S607090 PC1W-74G
001		544385500	RIGHT SIDE OF 70T LINE
001		533010500	LEG M10*25 D.40
002		531068600	BURNER WOK 0090 WITH SPACER
002		532008300	COLLAR BURNER WOK Ø90 S90
002		531035400	BIG BURNER BODY 90 LINE
002		532004000	1 FLAME GRILL 396X366 (90
002		533010800	TUBE NUT D.10 M16*1,5
002		533039300	BICONE §10
002		533052301	JOINT FOR NOZZLE HOLDER
002		533010900	NUT M14*1 H.4
002		531035100	BIG BURNER VENTURI 90 LINE
002		544400300	BURNER DRIP PAN 2/3
002		533023600	TAP PLUG §10 M16*1, 5CH19
002		533045700	THERMOCOUPLE M9*1 500
002		533039100	BICONE §6
002		533018500	FITTING FOR BICONE D.6 M10*1
002		533038800	75 BY-PASS FOR 21S TAP
002		539018900	INDEX FOR KNOB W/RED SIGN
002		539062800	RED STICKING DISK 72
002		539054200	STAMP Ø20,5 CR. "L" LOTUS R.
002		536034500	KNOB §77 4P. §08*6,5
002		531032000	GAS COCK P.V.BY-PASS Ø075
002		533091400	P.NOZZLE S100 UG.§20 PC90 LPG-FLUS
002		533091500	PILOT NOZZLE S.100 §30 PC90 NAT.GAS
002		533091000	NOZZLE 0.100 §20
002		533091200	PILOT NOZZLE 0100 Ø35 PIL.PC
002		533030800	NOZZLE §155 CH12X14 M-CW
002		533014800	NOZZLE §135 CH12*14,0
002		533056200	NOZZLE §230 CH12*14
002		533015000	NOZZLE D.I 260 G110 (TOWN GAS
002		533055400	NOZZLE §245 CH12*14