



**Snackgeräte  
Salamander**

Artikel-Nr. 221015 (SCG 80MG)

---

**Explosionszeichnung / Ersatzteile**

---

Bitte bei Ersatzteilbestellung immer Seriennummer mit angeben!

- b) Clean end thermocouple at tap tighten t.
- c) replace the thermocouple
- e) replace Tap
- a) clean
- b) Clean or fit new injector
- c) Check and adjust pressure
- d) Check gas type and fit correct Inj.
- e) Replace main burner
- a) reposition and tighten the Thermoc.

**SPARES PART NUMBERS**

DESCRIPTION	MODELS	
	600	800
Injector Main Burner NG*	51480-4400	51480-4400
Injector Main Burner LPG*	51480-4500	51480-4500
Injector Pilot Burner NG*	51480-4000	51480-4000
Injector Pilot Burner LPG*		
Main Burner	SGC 582	SGC 584
Main Burner Sealing Washe	SXJ 208	SXJ 208
Pilot Burner	SGT 335	SGT 335
Thermocouple	SGT 316	SGT 316
Split Nut	SGT 317	SGT 317
Piezo Igniter Unit	SEW 848	SEW 848
Ignition Lead	438310600	438310600
Ignition Electrode	SEW 932	SEW 932
Gas Control Tap	SVG 181	SVG 181
Control Knob	SCH 307	SCH 307
Spring Clip - Control Knob	SXX 148	SXX 148
Toast Grid	12257-2601	12257-2601
Crumb Tray	1225-7262	1225-7263
Brander Plate	EXT363	EXT817
Branding Frame		
Drip/Basting Trough		
Inner Top Liner	12247-343	
Shelf Support Bracket	1224-7061	
3/8" Gas Governor*	SGT 042	SGT 042
Bench Stand	EXT 815	EXT 815
Floor Stand	EXT 816	EXT 816
Wall Brackets	EXT 814	EXT 814
Facia Pa5el	SXL 444	SXL 444
Handle protector	54881-5801	54881-5801

Parts marked \* together with an appropriate Data Plate form the kit for converting the appliance to burn an alternative gas. The 3/8" Governor is required for converting from LPG to Natural Gas.

**A. OUTER TOP PANEL**

REMOVE/REPLACE (figure 2)

1. Pull the outer top panel forward and lift clear to release keyhole slots from the locating pegs on the side panels then lift clear of the appliance.
2. Replace in a reverse sequence ensuring that there is no gap between the top of side panels and the outer top panel..

**B. INNER LINER**

REMOVE/REPLACE (figure 2)

1. Complete procedure A.
2. Lift the inner liner (2) clear of the appliance.
3. Replace in a reverse sequence ensuring that the panel fits correctly over the gas pipes and cable going into the control compartment.

**C. CONTROL FASCIA PANEL**

REMOVE/REPLACE (figure 2)

1. Complete procedure A.
2. Remove the gas control knob (3) by pulling firmly off the spindle.
3. Remove one screw (4) from the top of the fascia (5) and two screws (6) from the bottom of the panel.
4. Disconnect the Piezo ignition lead and remove panel from the appliance.
5. Replace in a reverse sequence.

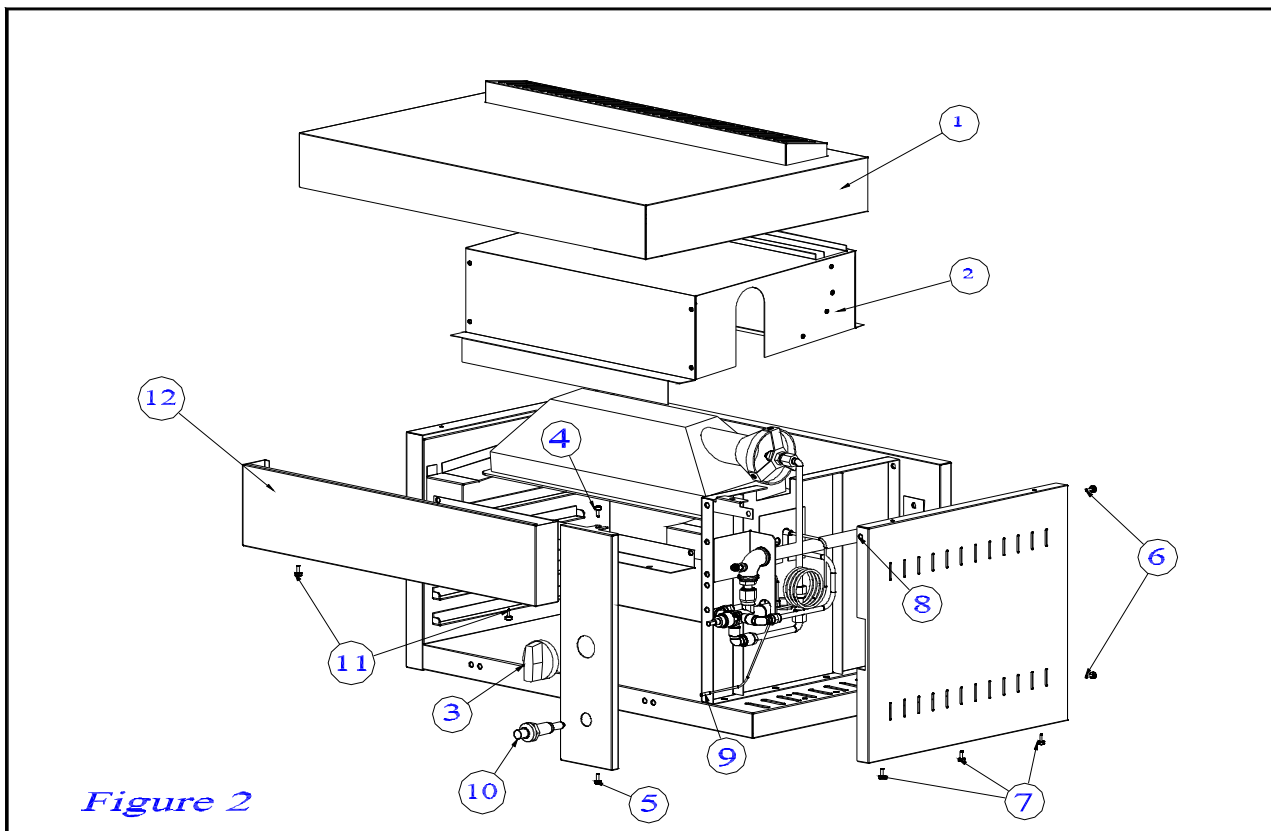

## F. GAS TAPS

EXCHANGE (figure 3)

1. Complete procedures A, C and D.
2. Disconnect the gas supply pipe (1), pilot outlet (2) and main gas outlet (5).
3. Disconnect thermocouple (4).
4. Remove gas tap from the appliance.
5. Check gas flow indication arrow on the replacement tap and fit in a reverse sequence ensuring that all gas connections are sound.
6. Restore the gas supply to the appliance at the gas Isolating Tap.
7. Check for gas leaks.
8. Light the main Burner ensuring that the Pilot Burner flame will established, and then turn the gas Tap to the LOW Position
9. Adjust the LOW flame by means of the Low Rate Adjusting Screw..

## D. RIGHT OUTER SIDE PANEL

REMOVE/REPLACE (figure 2)

1. Complete procedure A,B and C.
2. Withdraw two screws (6) from the rear edge of panel.
3. Withdraw three screws (7) from lower edge of panel.
4. Remove the Outer Side Panel from the appliance.
5. Replace in a reverse sequence.

## E. GAS TAPS

SERVICING (figure 3)

1. Complete procedure D.
2. Remove the two screws and carefully withdraw the tap spindle/niting plate assembly . NOTE the alignment of the spindle.
3. Withdraw the spring and shaft.
4. Extract the plug noting the plug alignment.
5. Clean the plug and the interior of the tap body using a lint-free cloth and solvent if necessary.
6. Regrease sparingly, ensuring the grease does not block the ports and cavities.
7. Refit the plug into the body (3) then the shaft and spring
8. Secure the spindle/niting plate assembly to the body with the screws .
9. Restore the gas supply to the appliance at the gas isolating tap and check for gas leaks.
10. Light the main burner, and turn down to LOW setting.  
NOTE: Use only high temperature "GREEN GREASE MAGNALUBE" type 9801/6A01 or "MOLYKOTE

## G. THERMOCOUPLE

REMOVE/REPLACE (figure 3 & 4)

1. Follow procedures A, B,C and D.
  2. Disconnect the Thermocouple (figure 3, item 4) at the rear of the gas control tap.
  3. At the Pilot Burner, unscrew two screws (figure 4, item 8) and remove the pilot protection bracket inside the grilling compartment.
  4. Unscrew nut (figure 4, item 4) and withdraw the thermocouple from the pilot burner assembly.
  5. Fit replacement by reversing the above procedure.
- NOTE! When connecting the Thermocouple to the rear of Gas Control Tap - screw the nut in finger tight, and then apply a half turn maximum using a spanner.

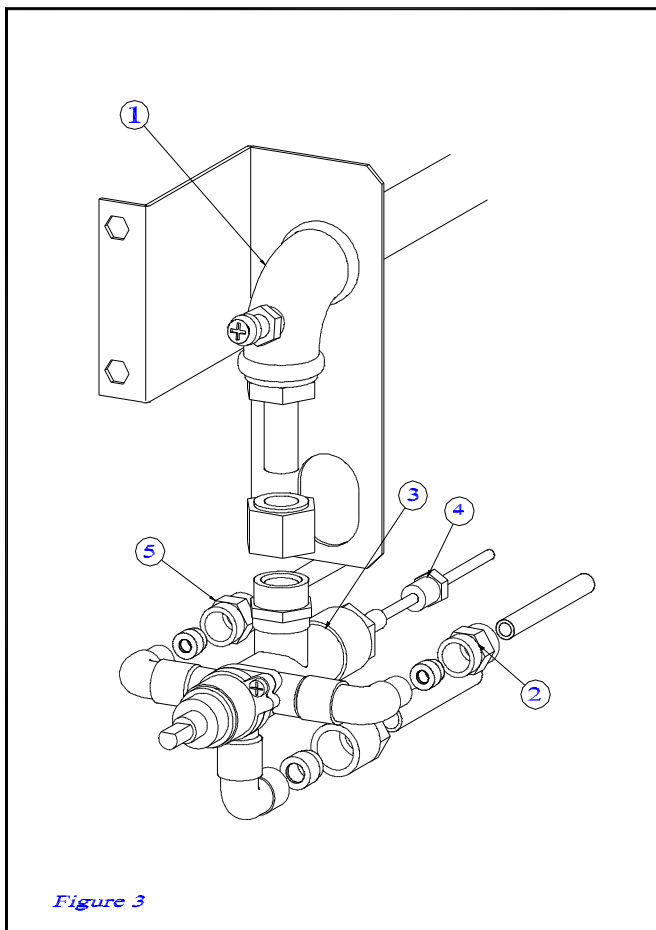

Figure 3

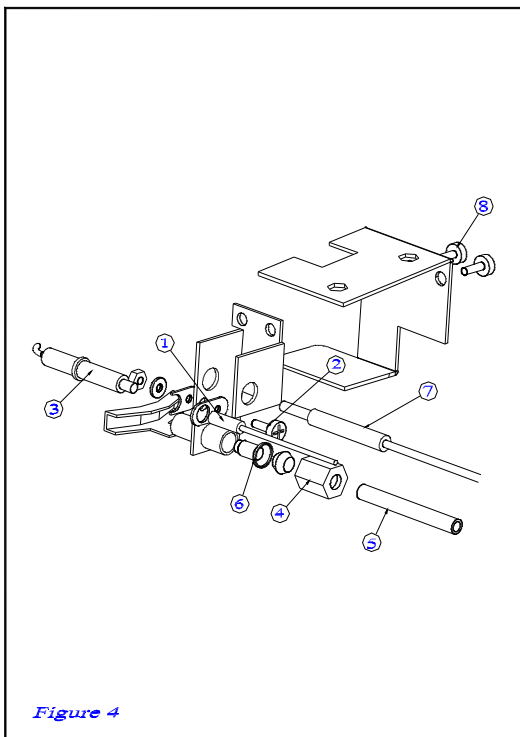

Figure 4

pilot burner and may have to be extracted by carefully prising around its edge.

4. Carefully clean/replace the injector using soft fine wire.
5. Reassemble in a reverse procedure.

## L. PILOT BURNER

CLEAN/REPLACE (figure 4)

1. Follow procedures A, B and C.
2. To clean the Pilot Injector: unscrew the tubing nut and remove the pilot protection bracket from inside the grilling compartment, making the gas joint between the elbow and pilot Burner, and ease the elbow away from the Burner..
3. The Pilot Burner injector is sealed within the tube of Pilot Burner and may have to be extracted by carefully prising around the edge of the hole with sharp blade.
4. Carefully clean or replace the injector and reassemble by reversing the above procedure.

## H. SPARK ELECTRODE & IGNITION LEAD

REMOVE/REPLACE (figure 4)

1. Complete procedures A and B for Spark Ignition electrode and for Ignition Lead, follow procedures A, B, C and D.
2. Remove the small screw that secures the Ignition Electrode to the Pilot Burner and remove the pilot protection bracket from inside the grilling compartment.
3. Disconnect the Ignition Lead (1) from the Electrode (3).
4. Remove the screw (2) and remove the electrode.
5. Inspect the Ignition Lead for damage or wear. If replacement is necessary then remove the Fascia panel as in procedure C and disconnect lead at the Piezo unit. Ensure that the high temperature sleeving is fitted to the length of the lead that is outside of the Control's Compartment.
6. Replace the electrode and lead by reversing the above procedure. NOTE Ensure that the high temperature protection sleeve is fitted to the lead.

## J. PIEZO IGNITER

REMOVE/REPLACE (figure 3)

1. Follow procedure C.
2. Disconnect lead (2) from the terminal on the Piezo unit.
3. Unscrew nut (5) and remove Piezo unit (4) through front fascia panel.
4. Replace in reverse sequence.

## K. PILOT INJECTOR

CLEAN/REPLACE (figure 4)

1. Follow procedure B.
2. Unscrew the two screws 8 and remove the pilot protection bracket from inside the grilling compartment.
3. Unscrew nut (4) and ease tube (5) away from burner.  
NOTE: the injector (6) is secured within the tube of the

5. If it is intended to completely replace the Pilot Burner, proceed to, and then continue:
6. Unscrew the thermocouple securing nut (7) and withdraw thermocouple from the Pilot Burner.
7. Disconnect the Ignition lead (1) from electrode (3).
8. Using a Phillip's or Pozi Head screwdriver and spanner, remove the two screws and nuts securing the Pilot Burner to the appliance.
9. Remove the ignition electrode (3) from the old Pilot Burner ( as in procedure H), inspect and discard if necessary.
10. Fit new Pilot Burner by reversing the above sequence.
11. Turn on the gas supply to the appliance and light the pilot burner, ensuring that the igniter and thermocouple operate correctly. Test for gas leaks.  
Check that the Main Burner are ignited by the Pilot Burner.

## M. MAIN BURNER

REMOVE/REPLACE (figure 5A & 5B)

1. Follow procedure B.
2. Disconnect gas supply at burner injector unit.
3. Remove two screws (5) and lift main burner away from appliance.

## N. MAIN BURNER INJECTOR

REMOVE/REPLACE (figure 5A & 5B)

1. Follow procedure M.
2. Unscrew three screws and remove aeration cover (4) complete with injector holder .
3. Unscrew injector (2), clean or renew as required.
4. Replace in a reverse sequence..

## M. MAIN BURNER INJECTOR

REMOVE/REPLACE (figure 5A & 5B)

1. Carry out procedure B.
2. Unscrew the screws (figure 2, item 1) and remove upper fascia panel (13).
3. Unfasten locknut (figure 5, item 4) and remove spring washer(3), then extract injector housing(2) from burner bracket by gently pulling tee or elbow away from burner.
4. Ensure that the Burner is supported within the Grill compartment then remove the eight nuts and washers.
5. Lower burner into the grill compartment then remove from appliance.
6. Replace in a reverse sequence.
7. Trn on gas supply to the appliance and light the Pilot Burner.
8. Check for gas leaks and ensure main burners cross light from pilots. Check low setting for operation.

NOTE . If, for any reason, the tee junction or elbow connections to the burner are disconnected from the injector housings always reconnect using a new

copper/fibre washer(6) and reseal with an approved gas seal compound.

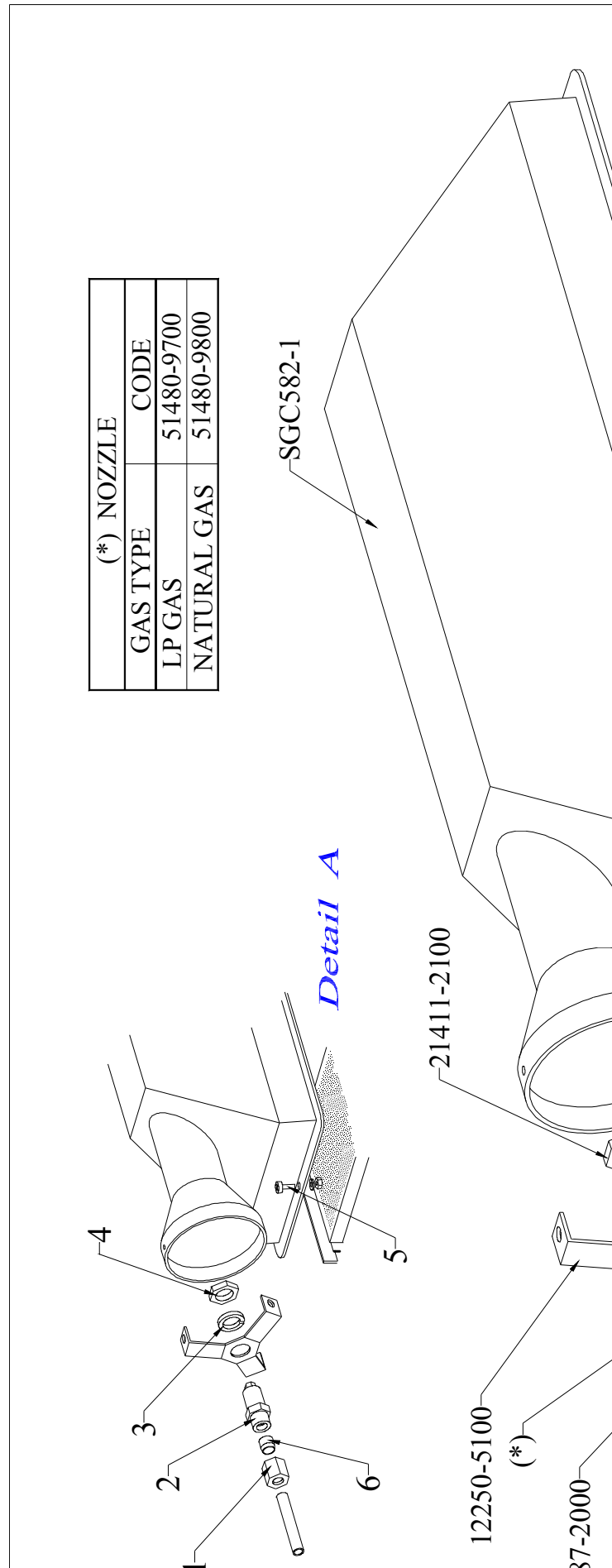

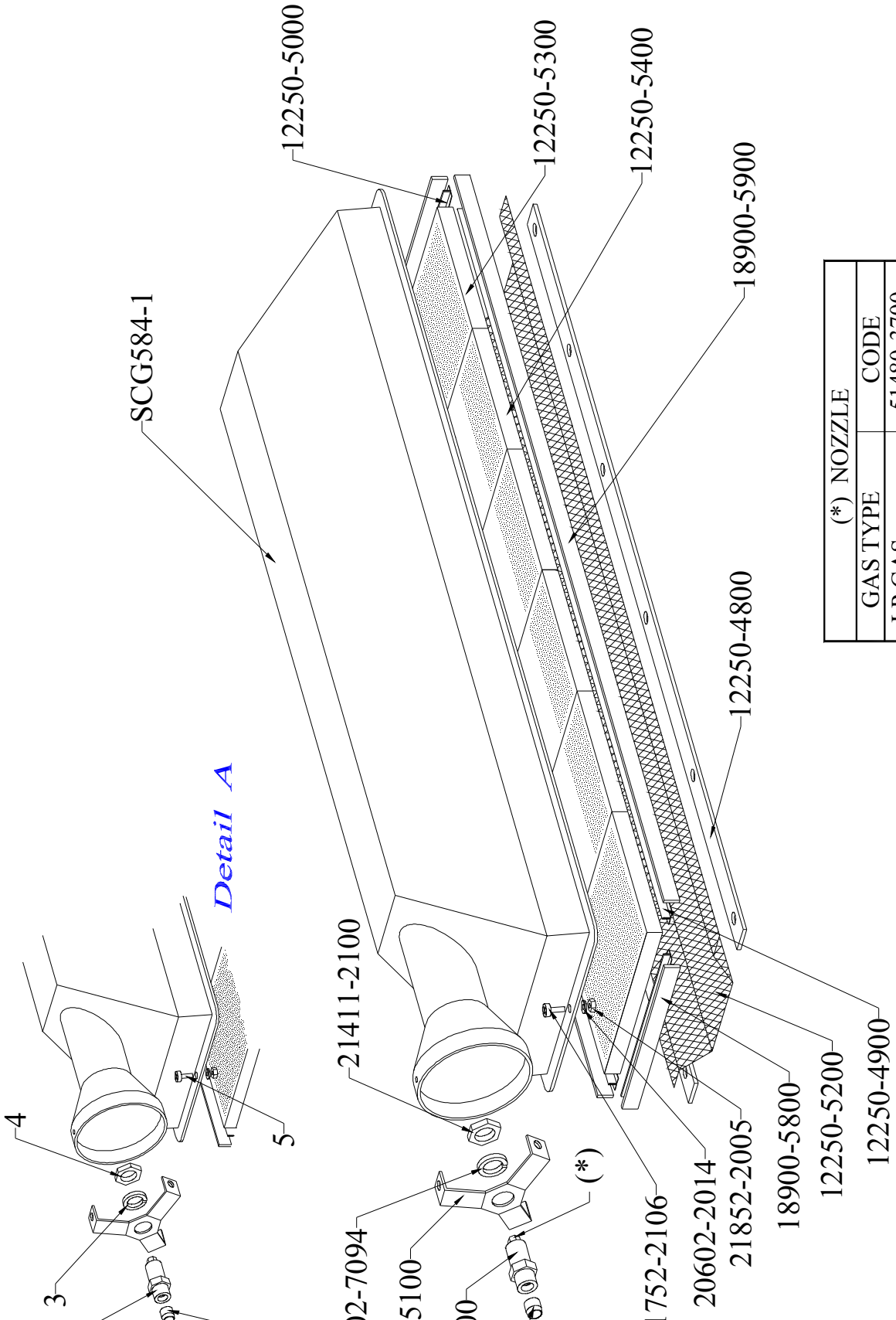

*Detail A*

(*) NOZZLE	
GAS TYPE	CODE
LP GAS	51480-3700
NATURAL GAS	51480-9900

*B*

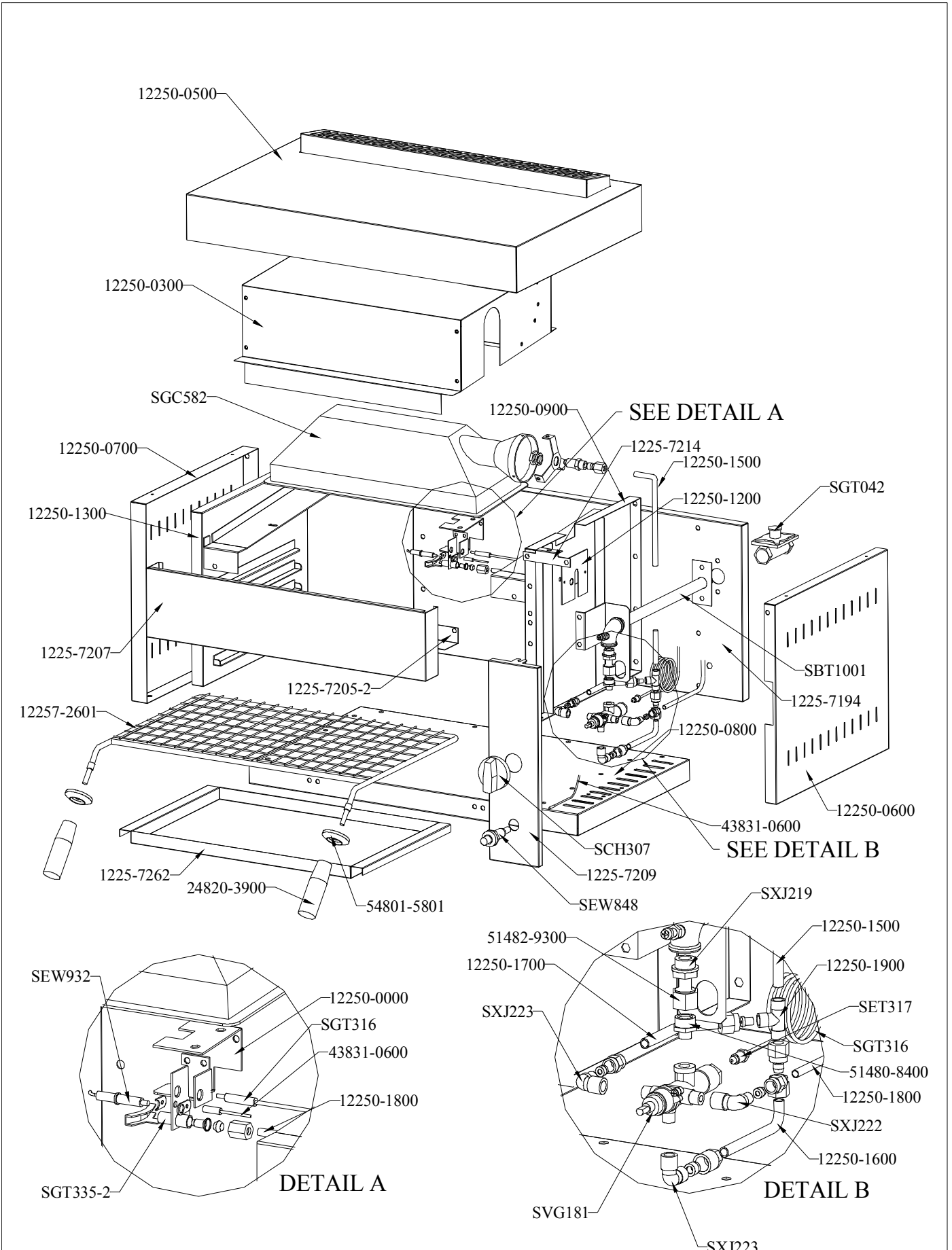

# SCG60MG

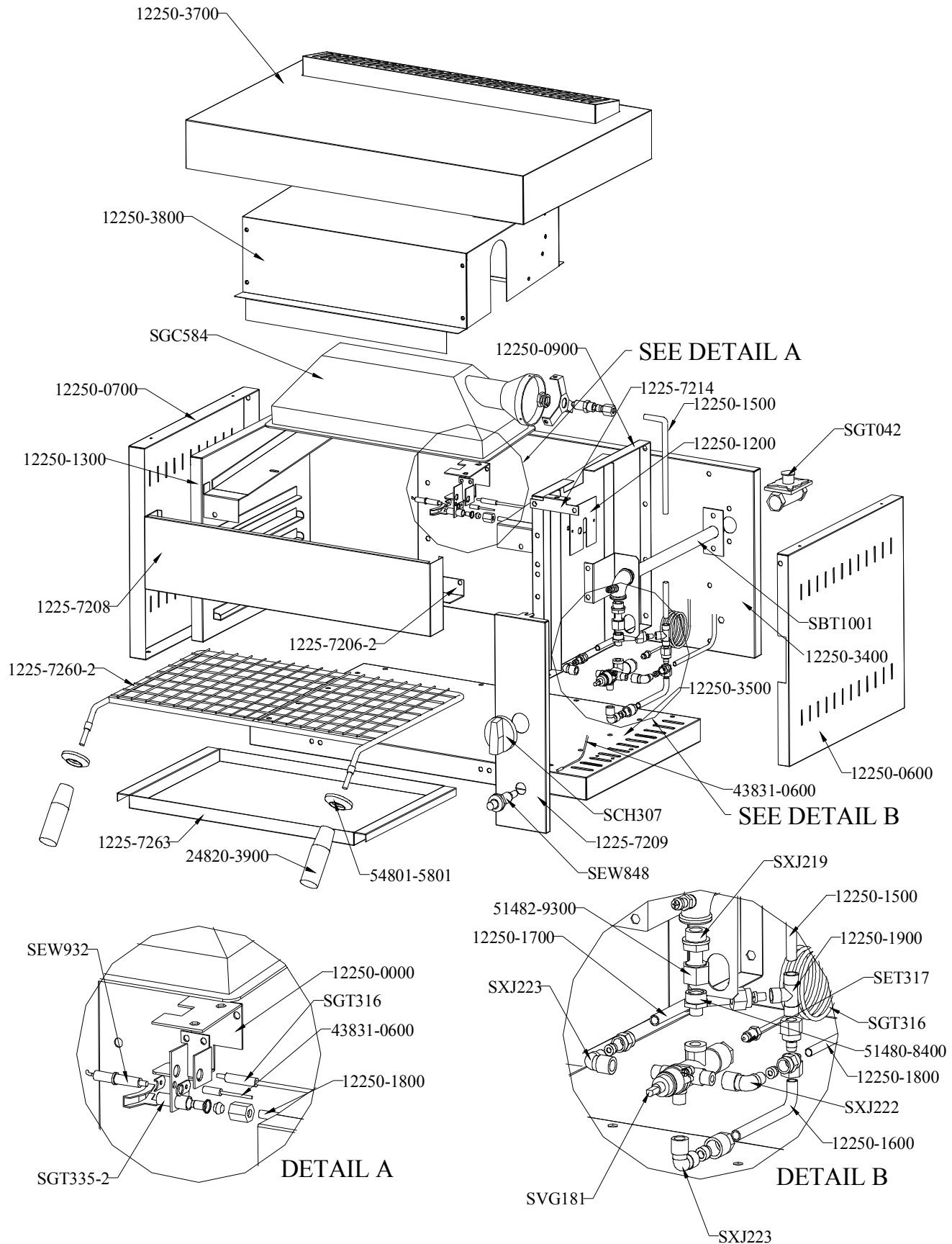

# SCG80MG



	<b>DESCRIPTION</b>	<b>SCG60MG</b>	<b>SCG80MG</b>
TOP COVER		122500500	122503700
TOP COVER LINNING		122500300	122503800
MAIN BURNER		SGC 582-1	SGC 584-1
SIDE COVER L/H		122500700	122500700
SIDE COVER R/H		122500600	122500600
FRONT CROSS COVER		12257207	12257208
FRONT CROSS MEMBER		12257205	12257206
INSIDE PANEL L/H		122501300	122501300
INSIDE PANEL R/H		122500900	122500900
TOAST RACK		122572601	122572602
CRUMB TRAY		12257262	12257263
HANDLE		248203900	248203900
PROTECTOR		548015801	548015801
REAR COVER		122507194	122503400
FLOOR		122500800	122503500
BURNER PIPE		122501500	122501500
MAIN GAS PIPE		SBT 1001	SBT 1001
FASCIA PANEL		SXL 444-2	SXL 444-2
FASCIA PANEL		122505800	122505800
FASCIA PANEL		122505900	122505900
FASCIA PANEL		12257209	12257209
CONTROL KNOB		548837311	5488837311
IGNITION UNIT		SEW 848	SEW 848
IGNITION CABLE		438310600	438310600
ELBOW		SXJ 223	SXJ223
THERMOCOUPLE NUT		SGT 317	SGT 317
PIPE		122501600	122501600
ELBOW		SXJ 222	SXJ 222
PIPE		122501700	122501700
"T" PIECE		122501900	122501900
THERMOCOUPLE NUT		SGT 316	SGT 316
COUPLING		514829300	514829300
COUPLING		514808400	514808400
COUPLING		SXJ219	SXJ 219
GAS VALVE		SVG 181	SVG 181
TEST ELBOW SCREW		217202105	217202105
TEST ELBOW NUT		214159801	214159801
ELECTRODE		SEW 932	SEW 932
PILOT ASSEMBLY		SGT 335-2	SGT 335-2
PILOT MOUNTING BRACKET		12250000	12250000
IGNITION CABLE		438310600	438310600
PILOT GAS PIPE		122501800	122501800
PILOT INJECTOR		51480400	51480400
GAS REGULATOR 3/8"		SGT 042	SGT 042
MAIN BURNER INJECTOR MOUNTING BRACKET		122505100	122505100
NOZZLE LPG GAS		514809700	514803700
NOZZLE NATURAL GAS		514809800	514809900
MAIN BURNER INJECTOR		51487200	51487200
CERAMIC PLAQUE ENDS		122505300	122505300
CERAMIC PLAQUE MIDDLE		122505400	122505400
CLAMPLING FRAME		189006000	189005900

	<b>DESCRIPTION</b>		<b>SCG60MG</b>	<b>SCG80MG</b>
CLAMPLING FRAME			189005800	189005800
FIXING STRINGER			122505600	122504800
PROTECTION GRID			122505700	122505200
MAIN BURNER FIXING SCREW			217522106	217522106
MAIN BURNER FIXING WASHER			206022014	206022014
MAIN BURNER FIXING NUT			215822005	215822005
GASKET			122505500	122504900
GASKET			122505000	122505000
BICONE			SXJ 208	SXJ208
SPLIT NUT			SXJ 207	SXJ 207
GROWER WASHER			206027094	206027094
INJECTOR FIXING NUT			214112100	214112100
BRANDER PLATE			EXT363	EXT817