

**MAGIC SNACK 60**  
ELETTRICO / ELECTRIC / ELEKTRO / ELECTRIQUE

**CW-61ET CW-62ET**

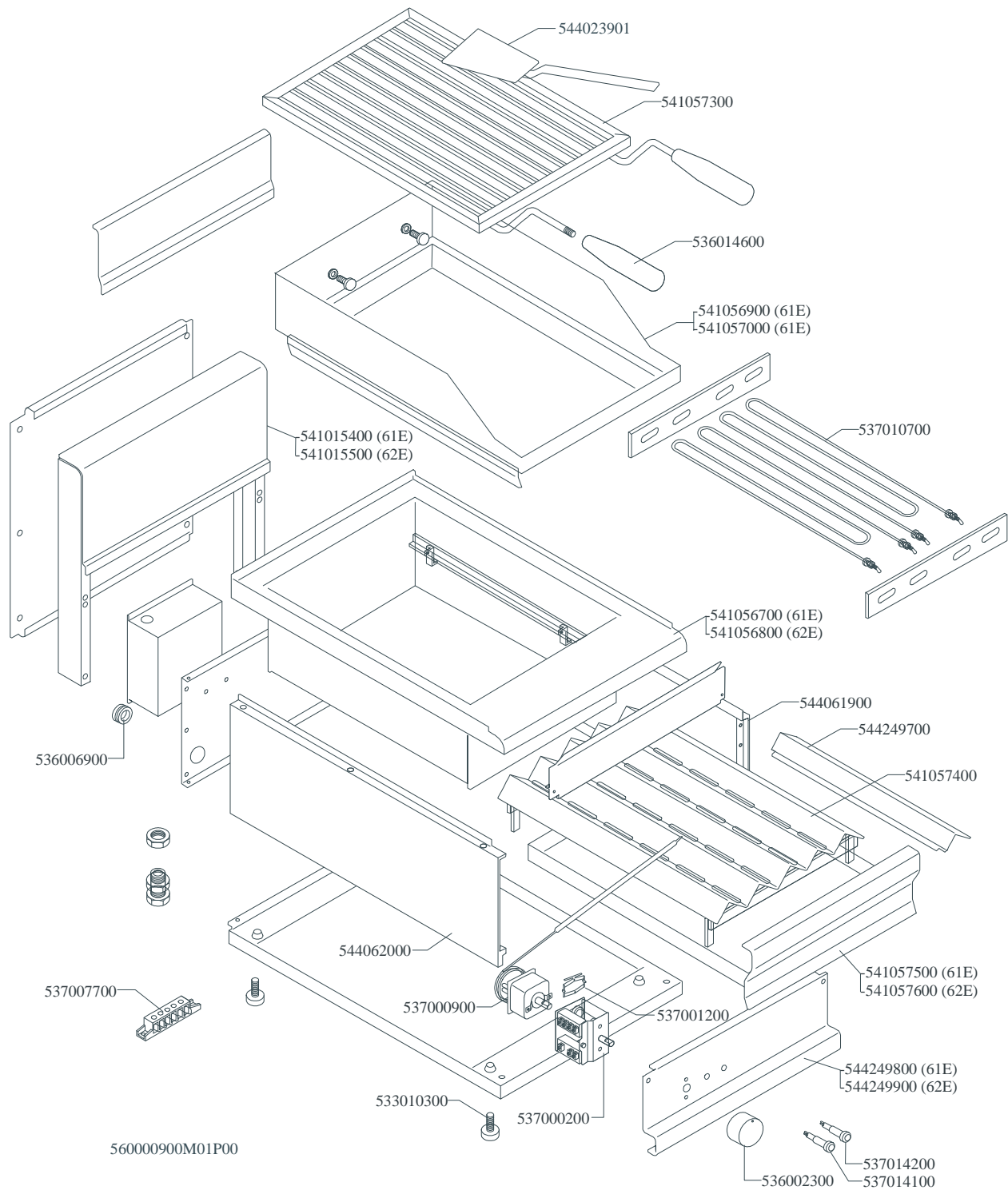

Page	Pos	Code	Description
001		544023901	SPATTLE FOR FRY-TOP
001		541057300	GRID CW
001		536014600	GRIP D.28*90*M10 CW
001		541056900	SPLASH SHIELD CW-61E
001		541057000	SPLASH SHIELD CW-62E
001		537010700	HEATING ELEMENT W2000 V230 CW
001		541015400	NEUTRAL SPACER 61
001		541056700	UPPER PLATE CW-61E
001		544061900	RIGHT SIDE PANEL 60 LINE
001		544249700	CENTRAL REFLECTING ELEMENT CW-62E
001		536006900	RUBBER CABLE GUIDE D.25MM.HOLE 16MM
001		541057400	REFLECTING BOARD CW S-60
001		541057500	DRIP TRAY CW-61E
001		537001200	FIXING BRACKET FOR THERMOSTAT/COMM.
001		537000900	THERMOSTAT 50-320°C THREEPHASE
001		544062000	LEFT SIDE PANEL 60 LINE
001		537007700	TERMINAL BLOCK THREEPHASE 40A
001		544249800	CONTROL PANEL CW-61E
001		537014200	GREEN WARNING LIGHT 250V
001		537014100	WHITE WARNING LIGHT 250V
001		536002300	KNOB 50-300°C THREEPHASE SNACK
001		533010300	ADJUSTABLE FOOT M10*20 D.23
001		537000200	COMMUTATOR 1 POS. 3PHASE S.49 16A