

FRIGGITRICI / FRYERS / FRITEUSEN / FRITEUSES
GAS / GAS / GAS / GAZ

FMG-10 FMG-2/10

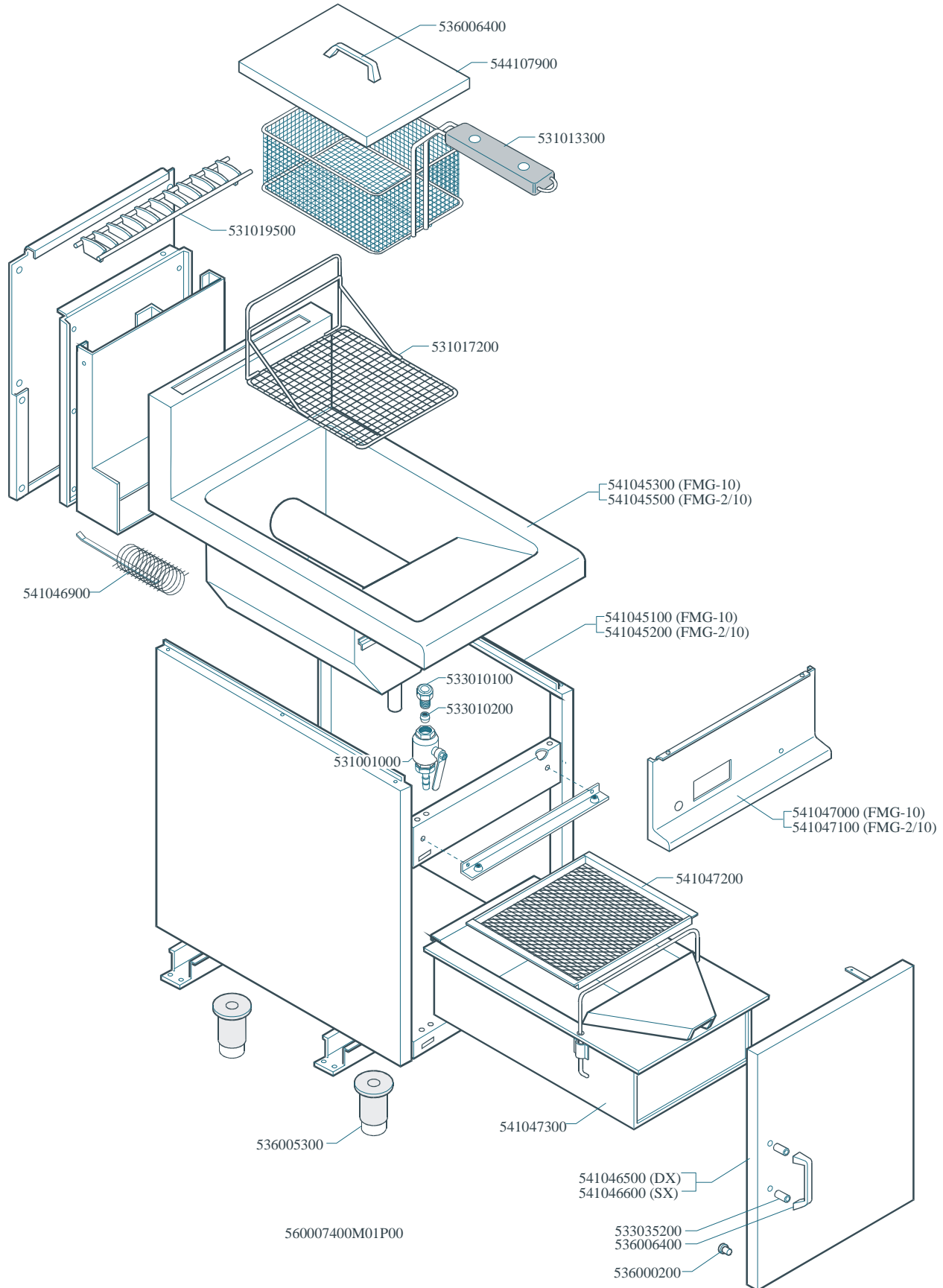

FMG-10 FMG-2/10

		*	**	***
G30- G31-	28+30mbar 37mbar	533020200	533043200	531013900
G30-	50mbar	533020200	533030100	531030700
G20- G25-	20mbar 25mbar	533020400	533030200	531013900
G20- DE-AT	20mbar	533020400	533030200	531030700
G25-	20mbar	533020400	533043100	531030700
G25-	25mbar NL	533020400	533030200	531013900

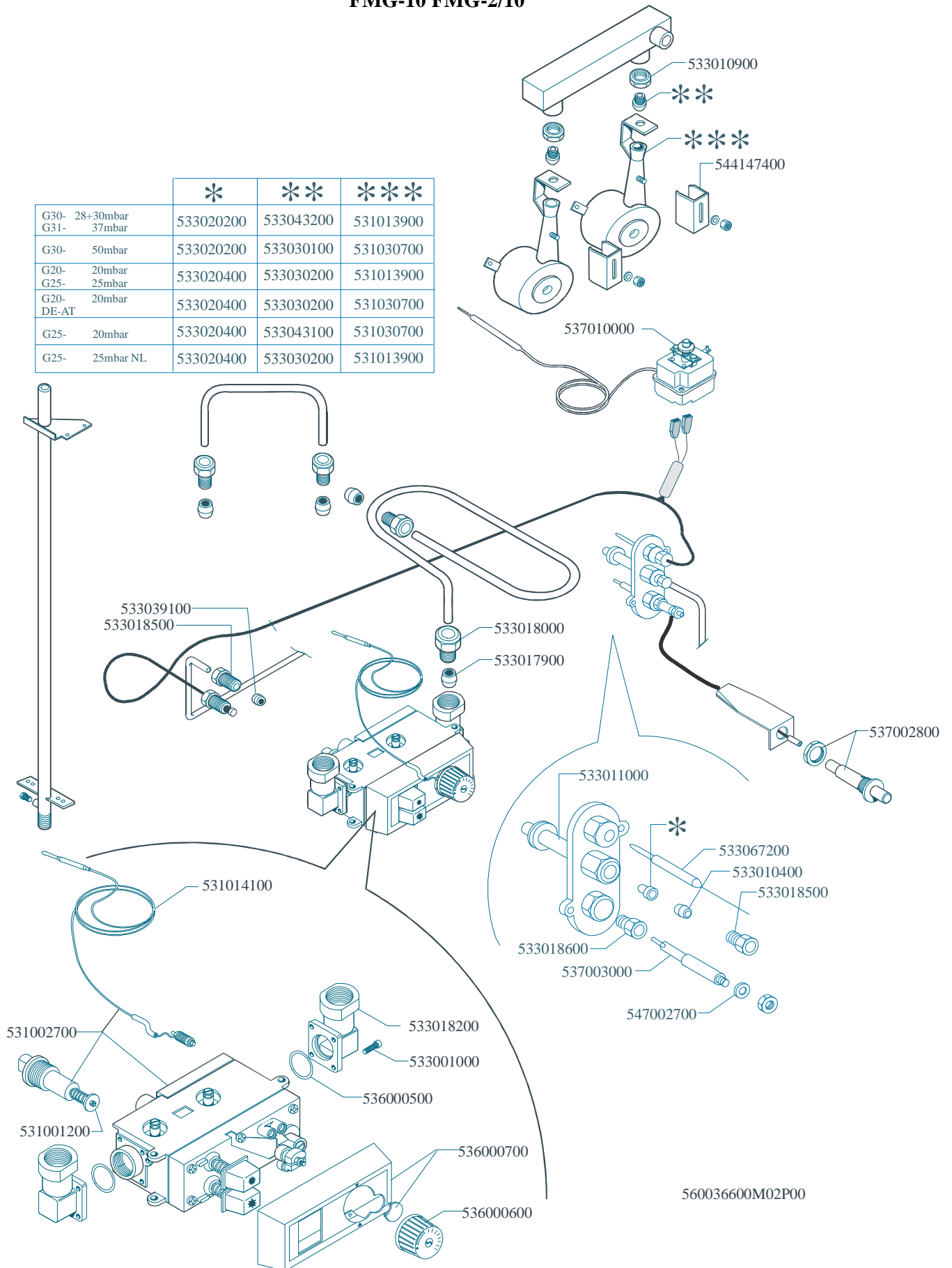

560036600M02P00

Page	Pos	Code	Description
001		536006400	BLACK HANDLE 65/FE/FG
001		544107900	TANK LID FMG-10-2/10
001		531013300	FRYER BASKET 10LTS.GAS/70EL.
001		531019500	FLUE GRID 400 FMG CHROME
001		531017200	TANK FILTER/BASKET SUPPORT FMG10/13
001		541046900	HEAT ACCUMULATOR FMG-10-2/10
001		541045300	UPPER PLATE FMG-10
001		533010100	3/4 D. 18 PIPE UNION
001		533010200	BICONE 18S
001		531001000	DRAIN COCK 3/4" + HANDLE
001		541045100	FRAME FMG-10/15
001		541047200	FILTER FOR DRIP TRAY
001		541047300	DRIP TRAY FMG
001		536005300	PLASTIC LED 2"
001		541047000	CONTROL PANEL FMG-10/15
001		541046500	RIGHT DOOR 40
001		541046600	LEFT DOOR 40
001		533035200	
001		536000200	D.12 H.4 BUMPER
002		533010900	NUT M14*1 H.4
002		544147400	AIR ADJUSTMENT BUSHING FMG-FQ
002		537010000	SAFETY THERMOSTAT 220°C SINGLEPHASE
002		533039100	BICONE §6
002		533018500	FITTING FOR BICONE D.6 M10*1
002		533018000	ELBOW FOR BICONE D.12 3/8 RS L20
002		533017900	BICONE D.12
002		537002800	PIEZOELECTRIC IGNITION M18
002		533011000	PILOT BURNER 3 FLAMES 320
002		533067200	THERMOCOUPLE 220+500 M9*1 CUT-OFF
002		533010400	BICONE D.6
002		533018600	PLUG FITTING
002		537003000	PLUG M4 - LONG ELECTRODE
002		547002700	HIGH-VOLTAGE CABLE L=500
002		531014100	VALVE CAPILLARY PROBE FOR FG §6
002		531002700	MINISIT VALVE 100-190°C FQ/FG
002		531001200	MAGNET AC/2-MINISIT
002		533018200	ELBOW OR GJ 3/8
002		533001000	SCREW TCB C/CC M4X16
002		536000500	O-RING FOR MINISIT FITTING
002		536000700	PLASTIC COVER FOR MINISIT + SCREW
002		536000600	BLACK LHD KNOB OP. FOR MINISIT
002		533020200	PILOT JETS 0160 FOR LPG §30
002		533043200	NOZZLE §110 G30 (LPG) CH12X14
002		531013900	BURNER FMG-10/15
002		533030100	NOZZLE §95 CH12*14 G-FP
002		531030700	BURNER "S" FMG-10/15
002		533020400	NOZZLE 0160 (NATURAL GAS) 51
002		533030200	NOZZLE §170 CH12*14 MH-FG L-FP/CW
002		533043100	NOZZLE §185 G25 CH12X14