

Forno elettrico mod.FME4 - 4+4 - 6 - 6+6 - 9
 Electric oven mod.FME4 - 4+4 - 6 - 6+6 - 9

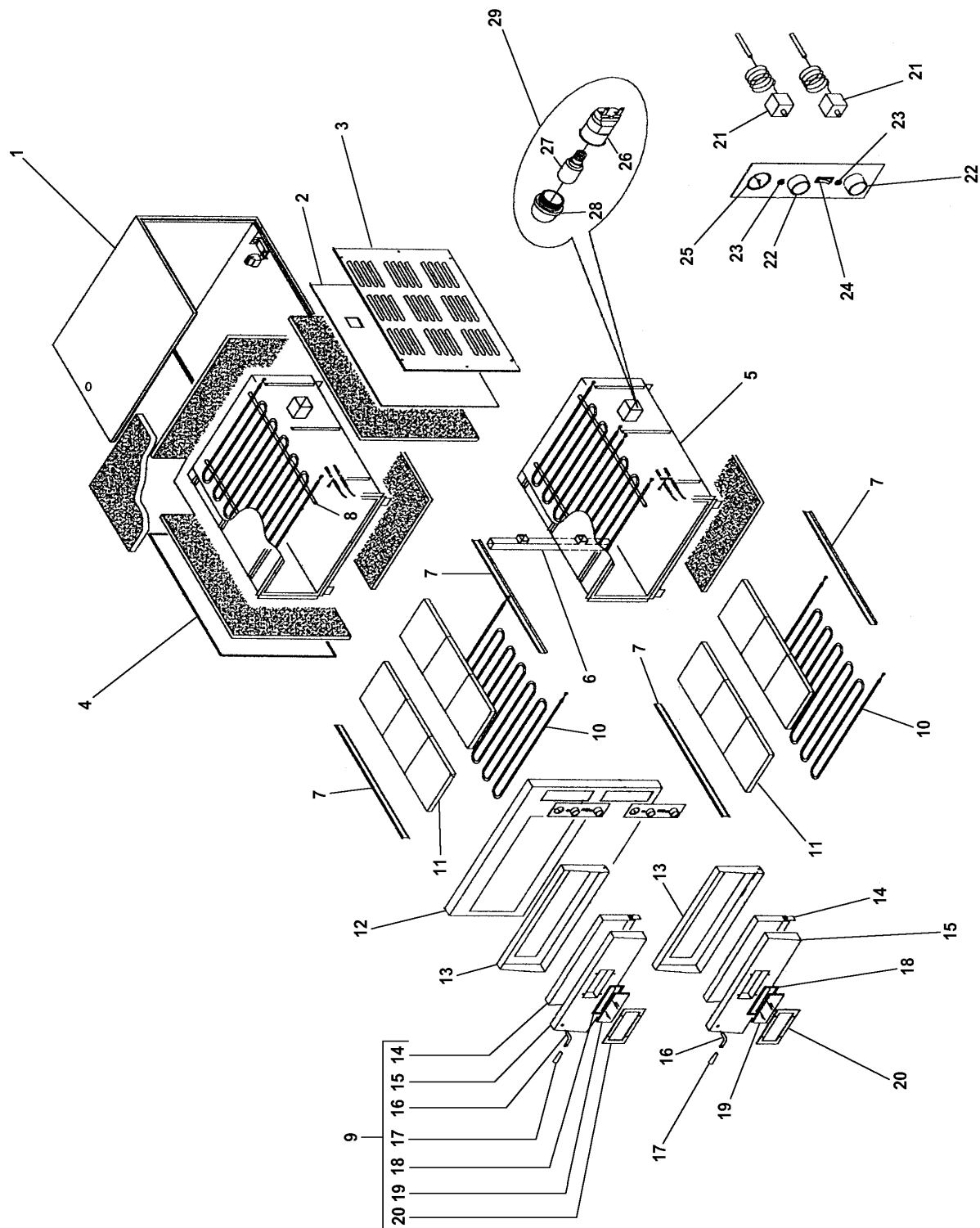

FORNO ELETTRICO MOD.FME4-4+4-6-6+6-9 ELECTRIC OVEN MOD.FME4-4+4-6-6+6-9

RIF.	CODICE / CODE	DIN - UNI	DESCRIZIONE / DESCRIPTION
1	CO1217		Carcassa mod.FME4 / Housing mod.FME4
1	CO1218		Carcassa mod.FME44 / Housing mod.FME44
1	CO1219		Carcassa mod.FME6 / Housing mod.FME6
1	CO1220		Carcassa mod.FME66 / Housing mod.FME66
1	CO1221		Carcassa mod.FME9 / Housing mod.FME9
2	CO1222		Pannello mod.FME4 / Panel mod.FME4
2	CO1223		Pannello mod.FME44 / Panel mod.FME44
2	CO1224		Pannello mod.FME6 / Panel mod.FME6
2	CO1225		Pannello mod.FME66 / Panel mod.FME66
2	CO1226		Pannello mod.FME9 / Panel mod.FME9
3	CO1227		Copertura mod.FME4 / Cover mod.FME4
3	CO1228		Copertura mod.FME44 / Cover mod.FME44
3	CO1229		Copertura mod.FME6 / Cover mod.FME6
3	CO1230		Copertura mod.FME66 / Cover mod.FME66
3	CO1231		Copertura mod.FME9 / Cover mod.FME9
4	CO1232		Copertura mod.FME4 / Cover mod.FME4
4	CO1233		Copertura mod.FME44 / Cover mod.FME44
4	CO1234		Copertura mod.FME6 / Cover mod.FME6
4	CO1235		Copertura mod.FME66 / Cover mod.FME66
4	CO1236		Copertura mod.FME9 / Cover mod.FME9
5	CO1237		Camera mod.FME4-44 / Chamber mod.FME4-44
5	CO1238		Camera mod.FME6-66 / Chamber mod.FME6-66
5	CO1239		Camera mod.FME9 / Chamber mod.FME9
6	CO1240		Canna fumaria mod.FME44-66 / Chimney mod.FME44-66
7	CO1241		Supporto mod.FME4-44 / Support mod.FME4-44
7	CO1242		Supporto mod.FME6-66 / Support mod.FME6-66
7	CO1243		Supporto mod.FME9 / Support mod.FME9
8	CO1244		Traverso mod.FME4-44 / Rod mod.FME4-44
8	CO1245		Traverso mod.FME6-66 / Rod mod.FME6-66
8	CO1246		Traverso mod.FME9 / Rod mod.FME9
9	CO1264		Gruppo sportello inox mod.FME4-44-6-66 / Stainless steel door mod.FME4-44-6-66 (assembly)
9	CO1265		Gruppo sportello rustico mod.FME4-44-6-66 / Rustic door mod.FME4-44-6-66 (assembly)
9	CO1266		Gruppo sportello inox mod.FME9 / Stainless steel door mod.FME9 (assembly)
9	CO1267		Gruppo sportello rustico mod.FME9 / Rustic door mod.FME9 (assembly)
10	CO3651	230V/1Ph/50-60Hz	Resistenza mod.FME4-44 / Resistance mod.FME4-44
10	CO3652	230V/1Ph/50-60Hz	Resistenza mod.FME6-66 / Resistance mod.FME6-66
10	CO3653	230V/1Ph/50-60Hz	Resistenza mod.FME9 / Resistance mod.FME9
11	CO1247		Piana / Stone
12	CO1248		Frontale inox mod.FME4-6 / Stainless steel panel mod.FME4-6
12	CO1249		Frontale rustico mod.FME4-6 / Rustic panel mod.FME4-6
12	CO1250		Frontale inox mod.FME44-66 / Stainless steel panel mod.FME44-66
12	CO1251		Frontale rustico mod.FME44-66 / Rustic panel mod.FME44-66
12	CO1252		Frontale inox mod.FME9 / Stainless steel panel mod.FME9
12	CO1253		Frontale rustico mod.FME9 / Rustic panel mod.FME9
13	CO1254		Telaio mod.FME4-44-6-66 / Frame mod.FME4-44-6-66
13	CO1255		Telaio mod.FME9 / Frame mod.FME9
14	CO1256		Sportello mod.FME4-44-6-66 / Door mod.FME4-44-6-66
14	CO1257		Sportello mod.FME9 / Door mod.FME9
15	CO1258		Sportello inox mod.FME4-44-6-66 / Stainless steel door mod.FME4-44-6-66
15	CO1259		Sportello rustico mod.FME4-44-6-66 / Rustic door mod.FME4-44-6-66
15	CO1260		Sportello inox mod.FME9 / Stainless steel door mod.FME9
15	CO1261		Sportello rustico mod.FME9 / Rustic door mod.FME9
16	CO1214		Supporto / Support
17	CO1215		Maniglia / Handle
18	CO1262		Guarnizione / Washer
19	CO1200		Vetro / Glass
20	CO1263		Cornice / Frame
21	CO3601		Termostato / Thermostat
22	CO3611		Manopola / Knob
23	32W2970	230V 2W	Lampada / Bulb
24	CO1269		Interruttore / Switch
25	CO1270		Pirometro / Pyrometer
26	CO1271		Supporto / Support
27	CO1272	230V/1Ph/50-60Hz	Lampada / Lamp
28	CO1273		Vetro / Glass
29	CO3654	230V/1Ph/50-60Hz	Lampada completa / Lamp (assembly)

(*): fuori produzione / out of production