

BRT-66G

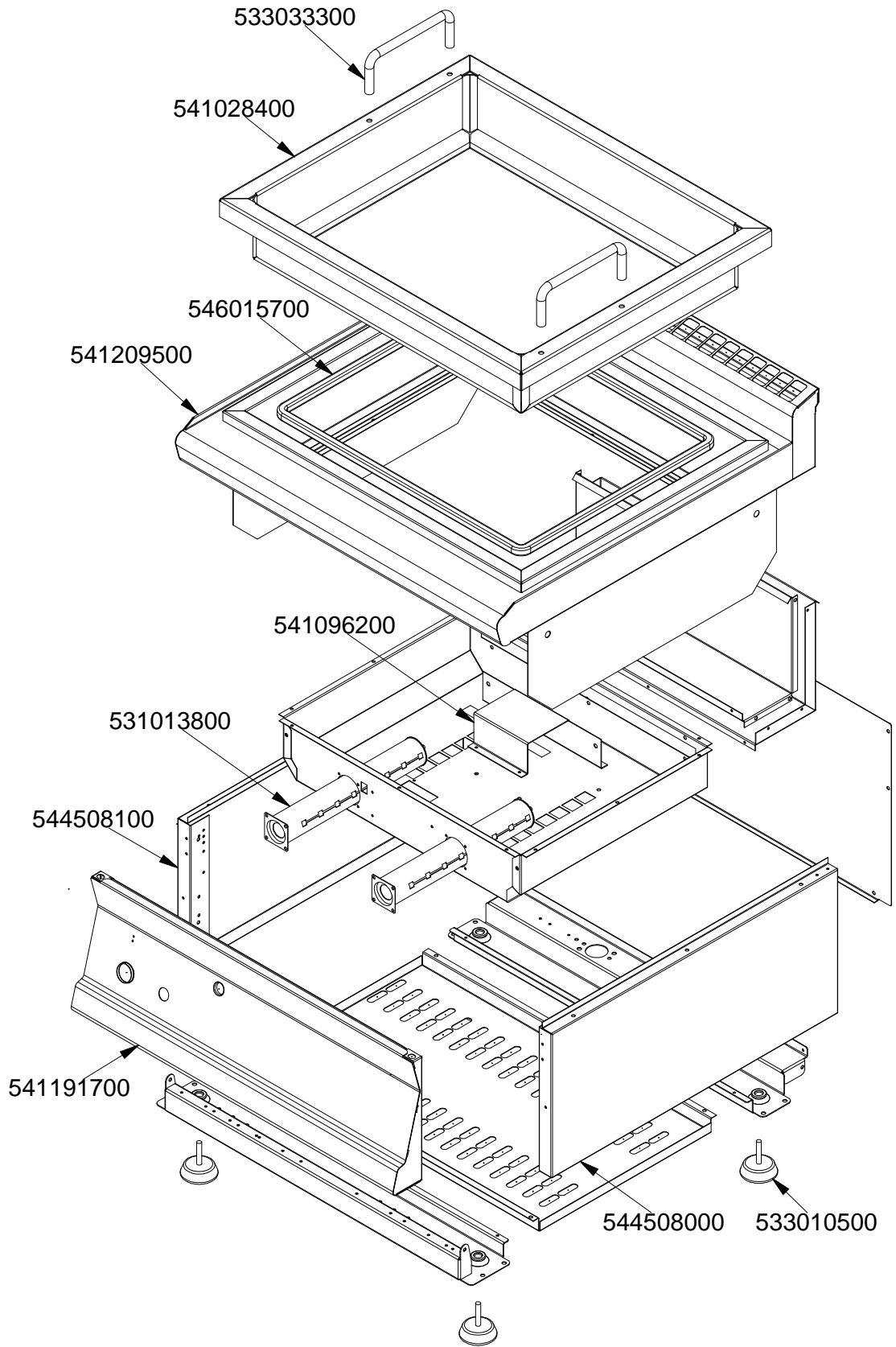

560075800M00P00.

MAGICLOTUS 60

CUCINE / RANGES / HERDE / CUISINIÈRES

BRT-66G

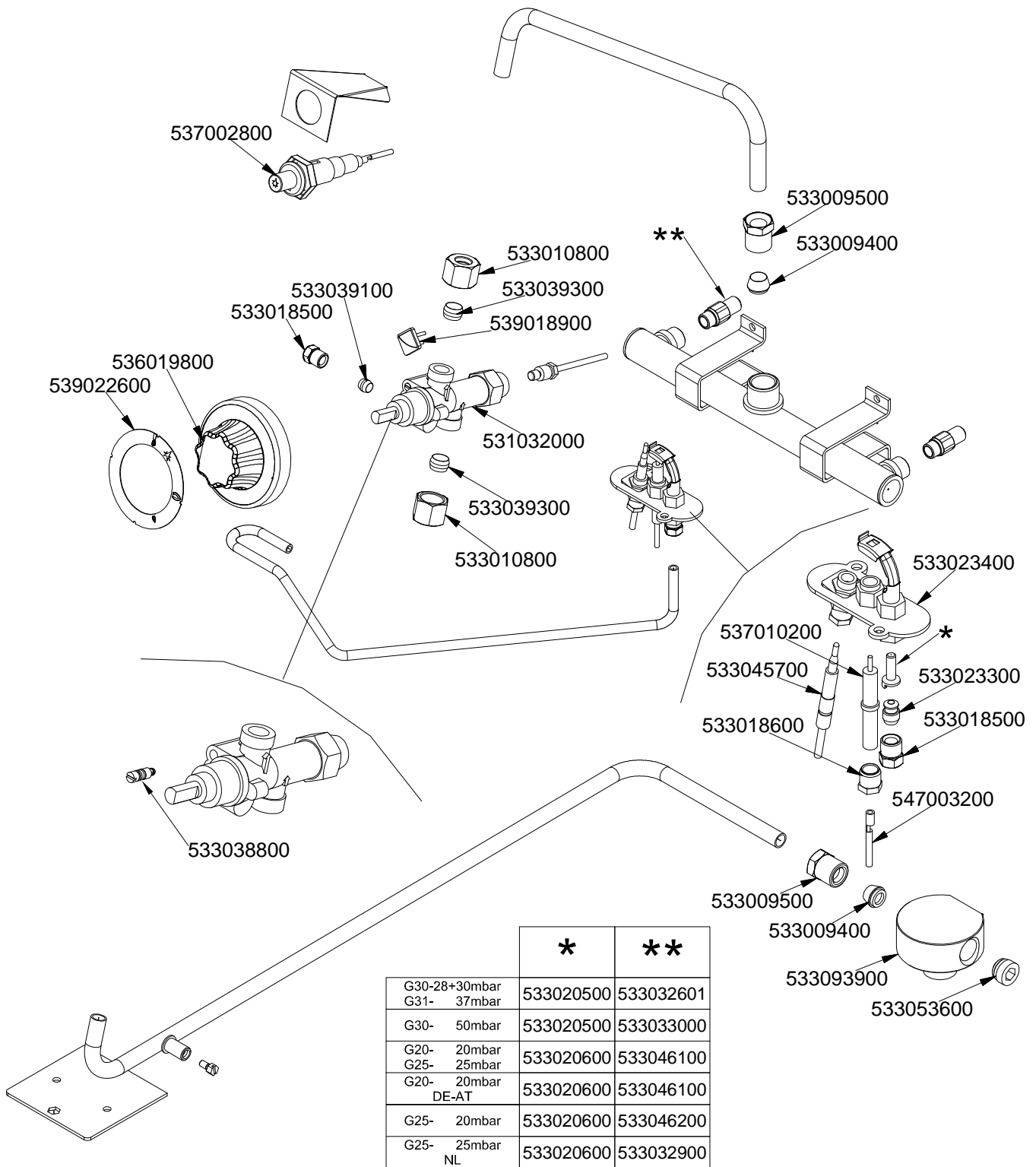

	*	**
G30-28+30mbar G31- 37mbar	533020500	533032601
G30- 50mbar	533020500	533033000
G20- 20mbar G25- 25mbar	533020600	533046100
G20- 20mbar DE-AT	533020600	533046100
G25- 20mbar	533020600	533046200
G25- 25mbar NL	533020600	533032900

560075900M00P00.

Page	Pos	Code	Description
001		533033300	TANK HANDLE BR-62
001		541028400	TANK BR-62
001		533010500	LEG M10*25 D.40
001		546015700	SQUARE BRAID 12*12*L1600 FC.
001		541209500	
001		544508000	
001		541096200	BURNER SUPPORT FT-74G FT-78G
001		531013800	BURNER BM-61G 102.0299.00
001		544508100	
001		541191700	CONTROL PANEL 607090 BRT-66G
002		537002800	PIEZOELECTRIC IGNITION M18
002		533009500	NIPPLE FOR BICONE 10S
002		533009400	BICONE 10S
002		533010800	TUBE NUT D.10 M16*1,5
002		533039300	BICONE §10
002		539018900	INDEX FOR KNOB
002		533039100	BICONE §6
002		533018500	FITTING FOR BICONE D.6 M10*1
002		536019800	BLACK KNOB §70 PIN §8*6,5
002		539022600	GRADUATED STICKER FOR KNOB
002		531032000	GAS COCK P.V.BY-PASS Ø075
002		533023400	"TARGET" PILOT + NIPPLE TC
002		537010200	ROUND PLUG §2,4 - SHORT ELECTRODE
002		533045700	THERMOCOUPLE M9*1 500
002		533018600	PLUG FITTING
002		533023300	BICONE §6 ("TARGET" PILOT)
002		547003200	HIGH-VOLTAGE CABLE TUBE.§2 L=500
002		533038800	75 BY-PASS FOR 21S TAP
002		533093900	FITTING GAS ENTRY 1/2G 2OUT 3/8G
002		533053600	EUROSIT VALVE PLUG
002		533020500	NOZZLE 0.140 §19
002		533032601	NOZZLE §85 CH12X30,0
002		533033000	NOZZLE §075 CH12X30,0
002		533020600	NOZZLE 0.140 §27
002		533046100	NOZZLE §140 CH12X30 MH-BR
002		533046200	NOZZLE §150 CH12X30 L-BR TP
002		533032900	