

FT...-4G... FT...-6G... FT...-8G...

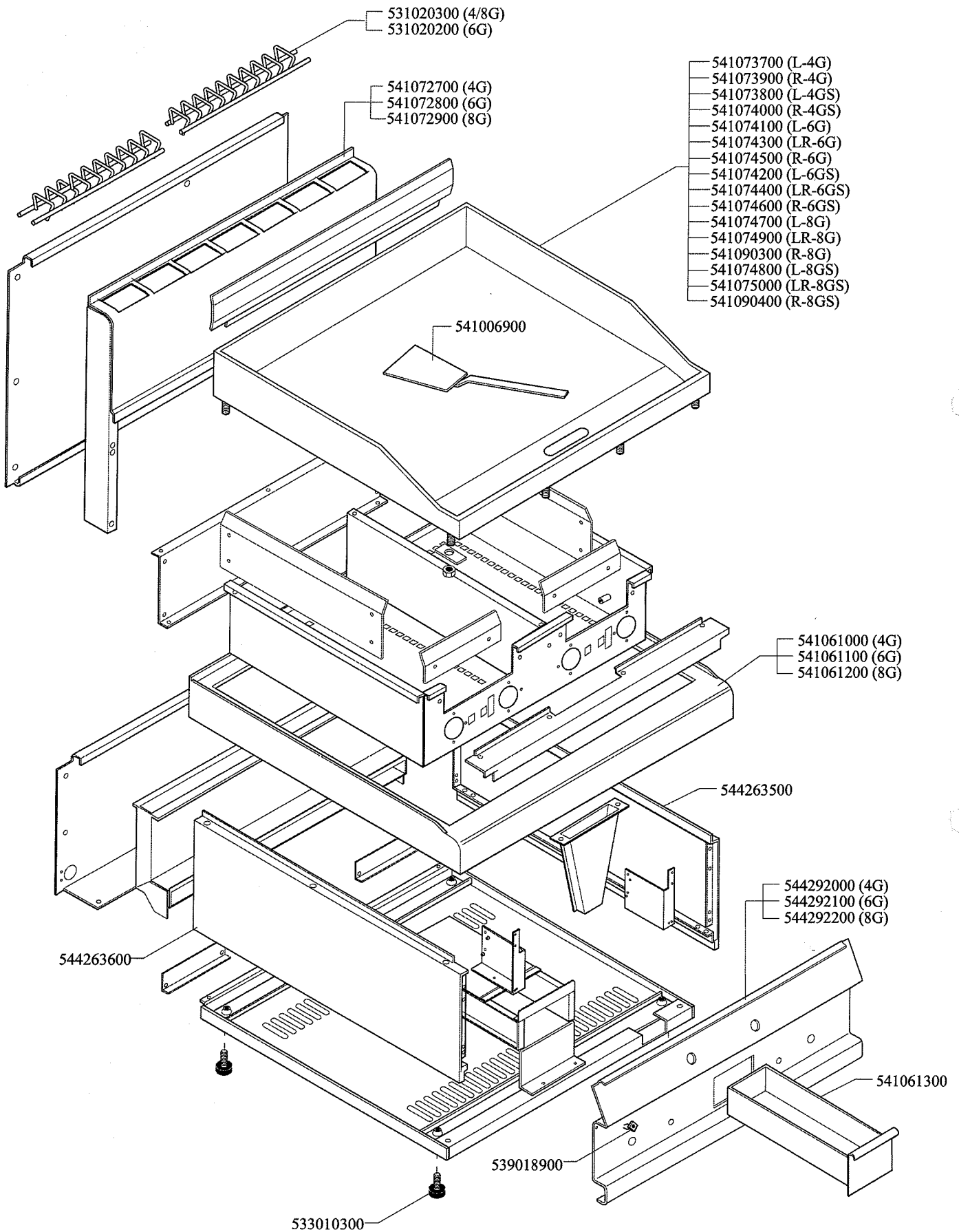

FT...-4G... FT...-6G... FT...-8G...

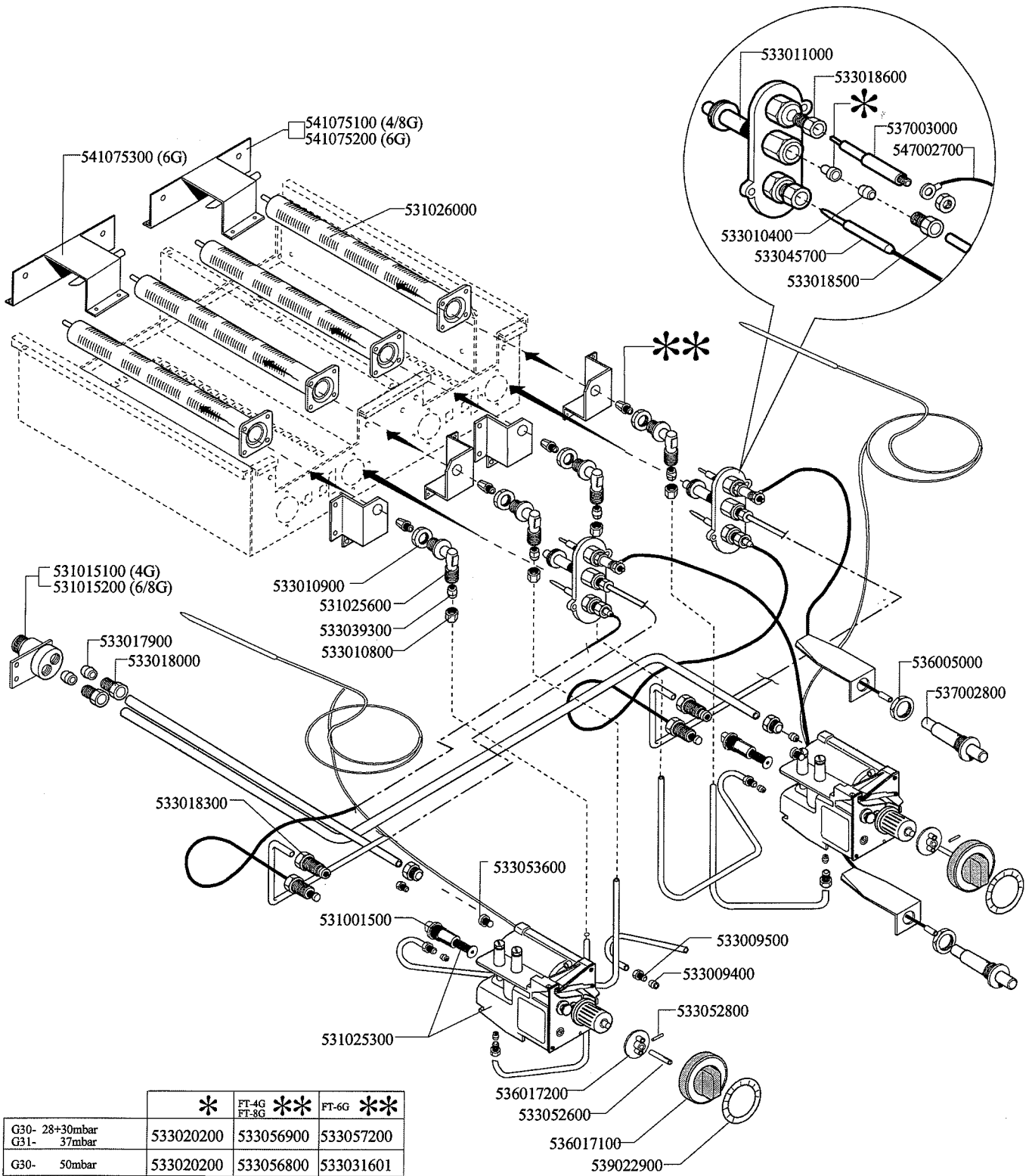

	*	FT-4G FT-8G	**	FT-6G	**
G30- 28+30mbar G31- 37mbar	533020200	533056900		533057200	
G30- 50mbar	533020200	533056800		533031601	
G20- 20mbar G25- 25mbar	533020400	533056700		533031300	
G25- 20mbar	533020400	533057000		533057100	
G25- 25mbar NL	533020400	533057100		533057300	

Page	Pos	Code	Description
001		541090300	PLATE FTR-8G
001		541072900	PERFORATED SPACER 8
001		541061200	UPPER PLATE FT-8
001		544292200	CONTROL PANEL FT-8G
001		531020300	FLUE GRID 400"S65"
001		541006900	SPATTLE FT
001		544263500	RIGHT SIDE S.65
001		541061300	DRIP TRAY FOR FT 65
001		539018900	INDEX FOR KNOB
001		533010300	ADJUSTABLE FOOT M10*20 D.23
001		544263600	LEFT SIDE S.65
002		533020200	PILOT JETS 0160 FOR LPG §30
002		533020400	NOZZLE 0160 (NATURAL GAS) 51
002		533056900	NOZZLE §87 CH12*30 G-FT4/8
002		533056800	NOZZLE §77 CH12*30 F-FT4/8
002		533056700	NOZZLE §135A CH12*30 M-FT4/8
002		533057000	NOZZLE §150A CH12*30 L-FT4/8
002		533057100	NOZZLE §140A CH12*30 M-FT4/6/8
002		533057200	NOZZLE §80 CH12*30 G-FT6
002		533031601	NOZZLE §70 CH-12*30
002		533031300	NOZZLE §120 CH12*30,0
002		533057300	NOZZLE §125 CH12*30 M-FT6
002		541075100	BURNERS SUPPORT FT-4/8G
002		531015200	1/2" G- TWO WAY 3/8" G FITTING
002		531026000	BURNER FT-4/6/8G BM-4G
002		533011000	PILOT BURNER 3 FLAMES 320
002		533018600	PLUG FITTING
002		537003000	PLUG M4 - LONG ELECTRODE
002		547002700	HIGH-VOLTAGE CABLE L=500
002		533010400	BICONE D.6
002		533045700	THERMOCOUPLE M9*1 500
002		533018500	FITTING FOR BICONE D.6 M10*1
002		536005000	NUT M18 FOR PIEZOELECTRIC IGNITION
002		537002800	PIEZOELECTRIC IGNITION M18
002		533009500	NIPPLE FOR BICONE 10S
002		533009400	BICONE 10S
002		533052800	ELASTIC PEG §2,5*26
002		533053600	EUROSIT VALVE PLUG
002		531001500	MAGNET FOR EUROSIT VALVE
002		531025300	VALVE EUROSIT FT 100-340°C
002		536017200	MATCHER REMOTE CONTROL EUROSIT
002		533052600	PIN FOR KNOB 65LINE
002		536017100	BLACK KNOB §70 PIN §8*6,5
002		539022900	ADHESIVE GRADUATED DISC FOR KNOB
002		533018300	FITTING WITH BICONE 6 M10*1
002		533017900	BICONE D.12
002		533018000	ELBOW FOR BICONE D.12 3/8 RS L20
002		533010900	NUT M14*1 H.4
002		531025600	ELBOW 90° NOZZLE-HOLDER §10 PIPE
002		533039300	BICONE §10
002		533010800	TUBE NUT D.10 M16*1,5