

**CP-4ET CP-6ET CP-4ETX CP-6ETX**

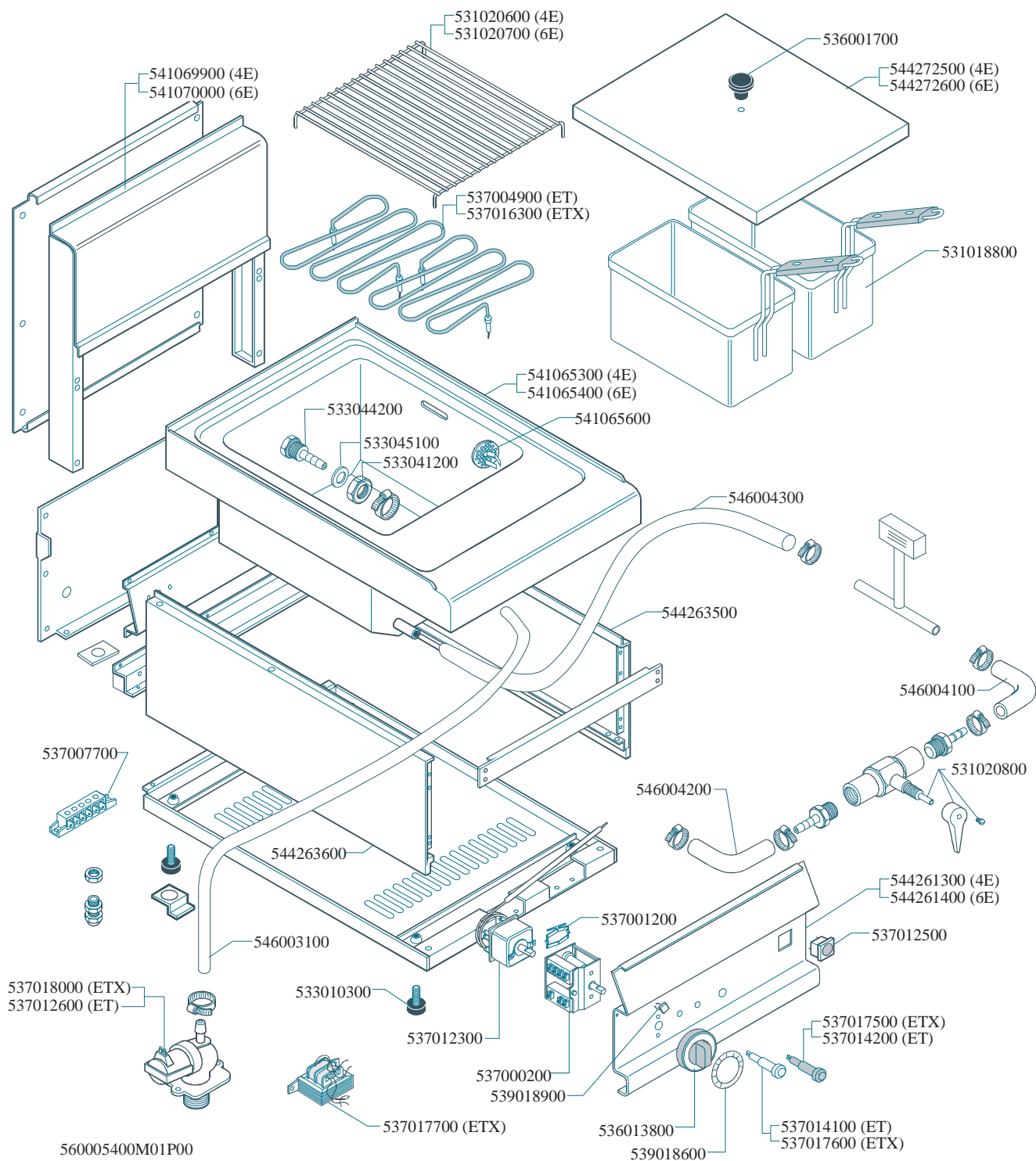

Page	Pos	Code	Description
001		541069900	NEUTRAL SPACER 4
001		544263500	RIGHT SIDE S.65
001		544263600	LEFT SIDE S.65
001		533010300	ADJUSTABLE FOOT M10*20 D.23
001		537000200	COMMUTATOR 1 POS. 3PHASE S.49 16A
001		539018600	ADHESIVE GRADUATED DISC FOR KNOB
001		537017600	WHITE WARNING LIGHT LOW BUD 110V
001		537017500	GREEN WARNING LIGHT LOW BUD 110V
001		536013800	KNOB D.70 BLACK 6*5 WITH SPRING
001		537012300	THERMOSTAT 30/110°C THREEPHASE
001		537001200	FIXING BRACKET FOR THERMOSTAT/COMM.
001		539018900	INDEX FOR KNOB
001		544261300	CONTROL PANEL CP-4E
001		537017700	TRANSFORMER 440V/100V 10VA
001		537007700	TERMINAL BLOCK THREEPHASE 40A
001		537016300	HEATING ELEMENT 2000W 440V CP65
001		531020600	GRID FOR CP-4E
001		544272500	TANK LID CP-4E
001		536001700	GRIP D.25*19*M6
001		531018800	PASTACOOKER BASKET 150X292X150H
001		541065600	DRAIN FILTER CP-E 65
001		537012500	BUTTON 1POLE
001		541065300	UPPER PLATE CP-4E
001		537018000	ONE-WAY SOLENOID VALVE 180°100V
001		533044200	H.20 INPUT FITTING
001		533045100	GASKET §E24*§I18*SP.1,5
001		533041200	HEXAGONAL NUT 3/8" G
001		546004300	RUBBER TUBE §I.19*§E.27*1300
001		546004100	RUBBER TUBE §I.19*§E.27*L266
001		531020800	BALL VALVE 3/4"G F-F (1320PEL)
001		546004200	RUBBER TUBE §I.19*§E.27*L156
001		546003100	RUBBER TUBE §I.10*§E.18*950