

IF IN DOUBT ASK!!

DO NOT SCALE !!  
First Angle Projection

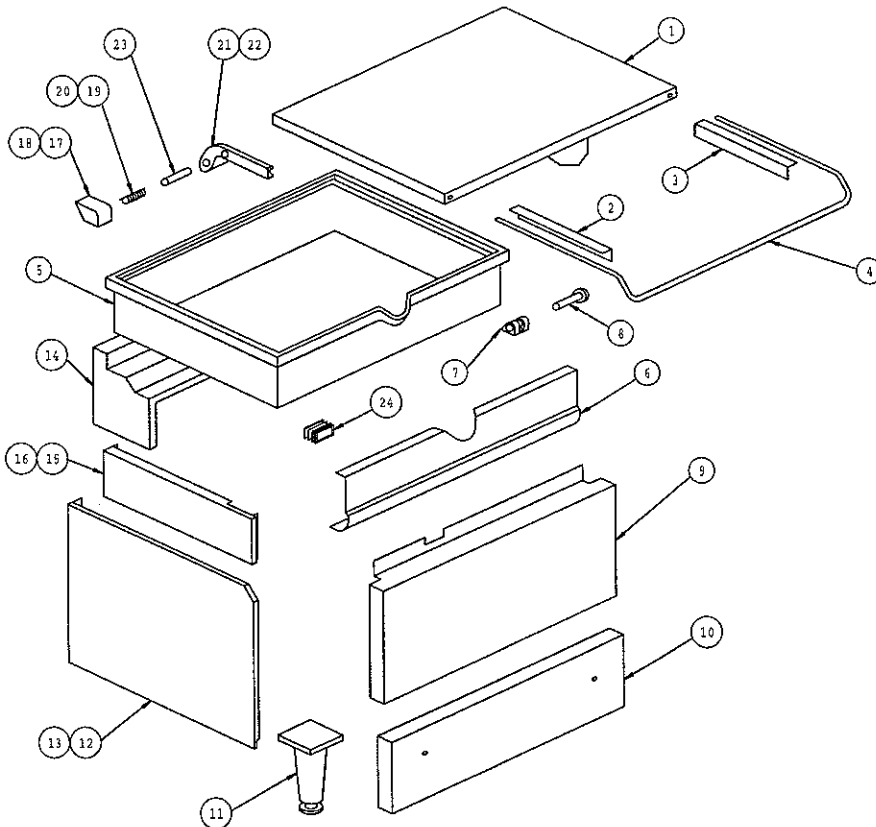
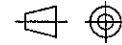

ITEM	DESCRIPTION	G2962	G2965	G2994	G2995
		SPARES No.	SPARES No.	SPARES No.	SPARES No.
1	PAN LID	531750010	531750010	531790010	531790010
2	LID HANDLE BRACKET L.H.	531750020	531750020	531750020	531750020
3	LID HANDLE BRACKET R.H.	531750030	531750030	531750030	531750030
4	LID HANDLE	531750040	531750040	531790020	531790020
5	PAN	531750050	531750050	531790030	531790030
6	PAN FACIA PANEL	537810030	537810030	537830010	537830010
7	PAN HINGE CASTING	531750070	531750070	531750070	531750070
8	PAN HINGE PIN	531750080	531750080	531750080	531750080
9	FRONT PANEL PRE F480123	537810080	537820010	537830020	537840010
9	FRONT PANEL POST F480123	537810085	537820015	537830025	537840015
10	BOTTOM FRONT PANEL PRE F480123	537810040	537810040	537830060	537830060
10	BOTTOM FRONT PANEL POST F480123	537810045	537810045	537830065	537830065
11	ADJUSTABLE LEG	531750110	531750110	531750110	531750110
12	OUTER SIDE PANEL L.H.	531750120	531750120	531750120	531750120
13	OUTER SIDE PANEL R.H.	531750130	531750130	531750130	531750130
14	REAR HOBB RAIL	537810090	537810090	537830030	537830030
15	PAN SIDE PANEL L.H.	537810010	537810010	537810010	537810010
16	PAN SIDE PANEL R.H.	537810020	537810020	537810020	537810020
17	LID HINGE BLOCK L.H.	531750180	531750180	531750180	531750180
18	LID HINGE BLOCK R.H.	531750560	531750560	531750560	531750560
19	LID HINGE SPRING L.H.	531750190	531750190	531750190	531750190
20	LID HINGE SPRING R.H.	531750200	531750200	531750200	531750200
21	LID HINGE ARM L.H.	531750210	531750210	531750210	531750210
22	LID HINGE ARM R.H.	531750220	531750220	531750220	531750220
23	LID HINGE BAR	531750240	531750240	531750240	531750240
24	SIGHT GLASS ASSEMBLY	531750230	531750230	531750230	531750230

All dimensions in millimetres, Tolerance- Linear  $\pm 0.5\text{mm}$  Angular  $\pm 0.5^\circ$  (or as stated). All sharp edges to be removed from sheet metal parts.

B	6162	ITEMS 9 & 10 UPDATED	F GARVOCK	19/03/10		
A	5815	ISSUED FOR PRODUCTION	I. HAMILTON	19-06-07		
G	Issue	Mod No.	Alteration	Zone	Drawn by	Date

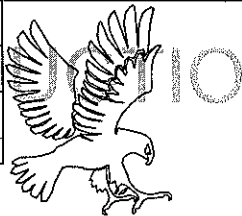

This part is common to the following units

Drawn	I. HAMILTON	Product	G2900 BRATT PANS	
Date	19-06-07	Title	SPARES DIAGRAM - FITMENTS	
Scale	----	Matl.	Drawing Number	Issue
No. off		Finish	AF45611	B
Bin No.	rnd16	Kraus No.	T111791	

No reproduction or publication of this drawing may be made and no article may be manufactured or assembled in accordance with this drawing without prior written consent. This prohibition is a term of any contract relating to this drawing. Rights reserved under the Copyright Act 1956 as amended by the Design Copyright Act 1968.

Falcon Foodservice Equipment. Wallace View Hillfoots Road Stirling Scotland

IF IN DOUBT ASK!!

DO NOT SCALE !!  
First Angle Projection

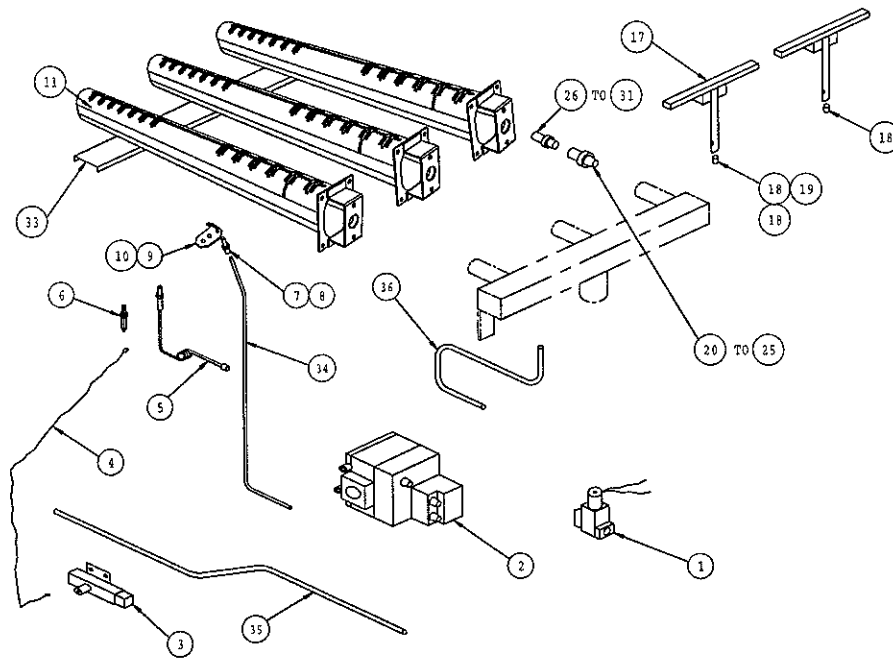
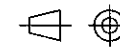

ITEM	DESCRIPTION	PARTS LIST			
		G2962 SPARES No.	G2965 SPARES No.	G2994 SPARES No.	G2995 SPARES No.
1	SOLENOID VALVE	531750320	531750320	531750320	531750320
2	MULTIFUNCTION CONTROL	531750330	531750330	531750330	531750330
3	SPARK IGNITER	531750340	531750340	531750340	531750340
4	IGNITER LEAD	531750350	531750350	531750350	531750350
5	THERMOCOUPLE	531750360	531750360	531750360	531750360
6	ELECTRODE	531750370	531750370	531750370	531750370
7	PILOT JET NAT GAS	531750380	531750380	531750380	531750380
8	PILOT JET LP GAS	531750390	531750390	531750390	531750390
9	PILOT BURNER NAT GAS	531750400	531750400	531750400	531750400
10	PILOT BURNER LP GAS	531750401	531750401	531750401	531750401
11	BURNER	531750420	531750420	531750420	531750420
12	CROSS LIGHTING BURNER	531750251	531750250	531790080	531790080
13	CROSS LIGHTING JET-NAT GAS	531750261	531750260		
14	CROSS LIGHTING JET LH-NAT GAS			531790090	531790090
15	CROSS LIGHTING JET RH-NAT GAS			531790095	531790095
16	CROSS LIGHTING JET-LP GAS	531750271	531750270	531790100	531790100
17	BURNER INJECTOR-NAT GAS-LH	531750280	531750280	531790120	531790120
18	BURNER INJECTOR-NAT GAS-RH	531750281	531750281	531790110	531790110
19	BURNER INJECTOR-NAT GAS-CENTRE			531790130	531790130
20	BURNER INJECTOR-LP GAS-LH	531750282	531750282	531790410	531790410
21	BURNER INJECTOR-LP GAS-RH	531750283	531750283	531790410	531790410
22	BURNER INJECTOR-LP GAS-CENTRE			531790410	531790410
23	INJECTOR JET-NAT GAS-LH	531750290	531750290	531790180	531790180
24	INJECTOR JET-NAT GAS-RH	531750291	531750291	531790170	531790170
25	INJECTOR JET-NAT GAS-CENTRE			531790190	531790190
26	INJECTOR JET-LP GAS-LH	531750300	531750300	531790420	531790420
27	INJECTOR JET-LP GAS-RH	531750301	531750301	531790420	531790420
28	INJECTOR JET-LP GAS-CENTRE			531790420	531790420
29	BURNER SUPPORT CHANNEL	531750410	531750410	531790240	531790240
30	PILOT PIPE	531790290	531790290	531790290	531790290
31	INLET SUPPLY PIPE	531790300	531790300	531790300	531790300
32	FPD TO MANIFOLD PIPE	531750640	531750640	537830050	537830050

All dimensions in millimetres, Tolerance- Linear  $\pm 0.5\text{mm}$  Angular  $\pm 0.5^\circ$  (or as stated). All sharp edges to be removed from sheet metal parts.

CLEARED FOR PRODUCTION



Drawn	I. HAMILTON	Product	G2900 BRATT PANS	
Date	19-06-07	Title	SPARES DIAGRAM - PIPEWORK	
Scale	----			
Matl.		Drawing Number	AF45612	Issue
No. off		Finish		A
Bin No.		Kraus No.		

Issue	Mod No.	Alteration	Zone	Drawn by	Date
A	5815	ISSUED FOR PRODUCTION		I. HAMILTON	19-06-07

This part is common to the following units

© No reproduction or publication of this drawing may be made and no article may be manufactured or assembled in accordance with this drawing without prior written consent. This prohibition is a term of any contract relating to this drawing. Rights reserved under the Copyright Act 1956 as amended by the Design Copyright Act 1988.

Falcon Foodservice Equipment. Wallace View Hillfoots Road Stirling Scotland

IF IN DOUBT ASK!!

DO NOT SCALE !!  
First Angle Projection

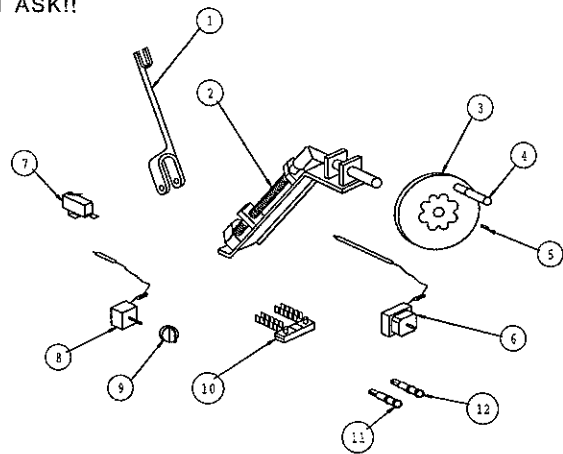
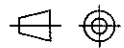

ITEM	DESCRIPTION	G2962 SPARES No.	G2994 SPARES No.
1	JACK ARM	531750430	531750430
2	SCREW JACK	531750440	531750440
3	HANDWHEEL ASSY	531750510	531750510
4	FOLDING HANDLE	531750511	531750511
5	LOCKING PIN	531750512	531750512
6	SAFETY THERMOSTAT	531750502	531750502
7	MICROSWITCH	531750540	531750540
8	CONTROL THERMOSTAT	537810100	537810100
9	CONTROL THERMOSTAT KNOB	537810070	537810070
10	TERMINAL BLOCK	537810110	537810110
11	INDICATOR LAMP-AMBER	537810050	537810050
12	INDICATOR LAMP-RED	537810060	537810060

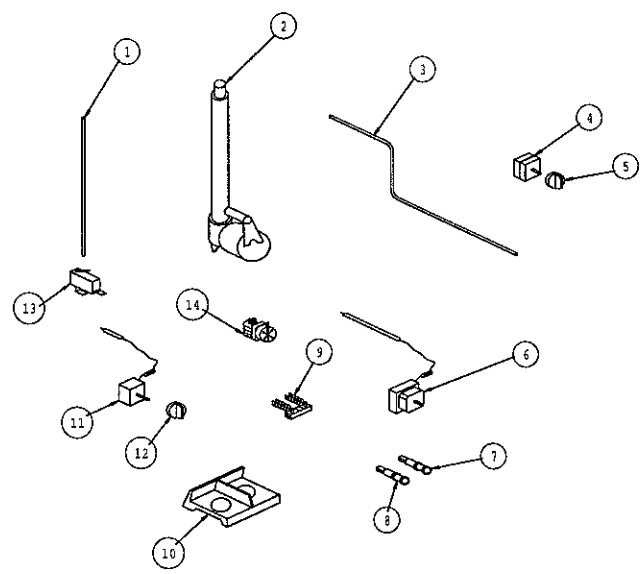

ITEM	DESCRIPTION	G2965 SPARES No.	G2995 SPARES No.
1	MICROSWITCH ROD	531860010	531860010
2	LINEAR POWER PACK	531860020	531860020
3	WINDING HANDLE	531860030	531860030
4	CHANGEOVER SWITCH	537820020	537820020
5	CHANGEOVER SWITCH KNOB	537850030	537850030
6	SAFETY THERMOSTAT	531750502	531750502
7	INDICATOR LAMP-AMBER	537810050	537810050
8	INDICATOR LAMP-RED	537810060	537810060
9	TERMINAL BLOCK	537810110	537810110
10	FOOT BELLOWS	531860070	531860070
11	CONTROL THERMOSTAT	537810100	537810100
12	CONTROL THERMOSTAT KNOB	537810070	537810070
13	MICROSWITCH	531750540	531750540
14	AIR SWITCH	531860080	531860080

All dimensions in millimetres, Tolerance- Linear  $\pm 0.5\text{mm}$  Angular  $\pm 0.5^\circ$  (or as stated). All sharp edges to be removed from sheet metal parts.

CLEARED FOR PRODUCTION



Drawn	I. HAMILTON	Product	G2900 BRATT PANS		
Date	19-06-07	Title	SPARES DIAGRAM-MECHANISM & ELECTRICS		
Scale	----				
Mail.		Drawing Number	AF45613	Issue	A
No. off		Finish			
Bin No.		Kraus No.			

Issue	Mod No.	Alteration	Zone	Drawn by	Date
A	5815	ISSUED FOR PRODUCTION		I. HAMILTON	19-06-07

© No reproduction or publication of this drawing may be made and no article may be manufactured or assembled in accordance with this drawing without prior written consent. This prohibition is a term of any contract relating to this drawing. Rights reserved under the Copyright Act 1956 as amended by the Design Copyright Act 1968.

This part is common to the following units

Falcon Foodservice Equipment. Wallace View Hillfoots Road Stirling Scotland