

SKT40G SKT60G SKT80G

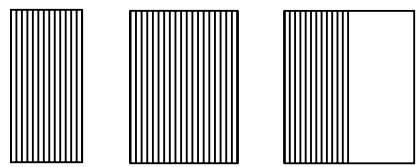

SKT40GR SKT60GR SKT80GLR

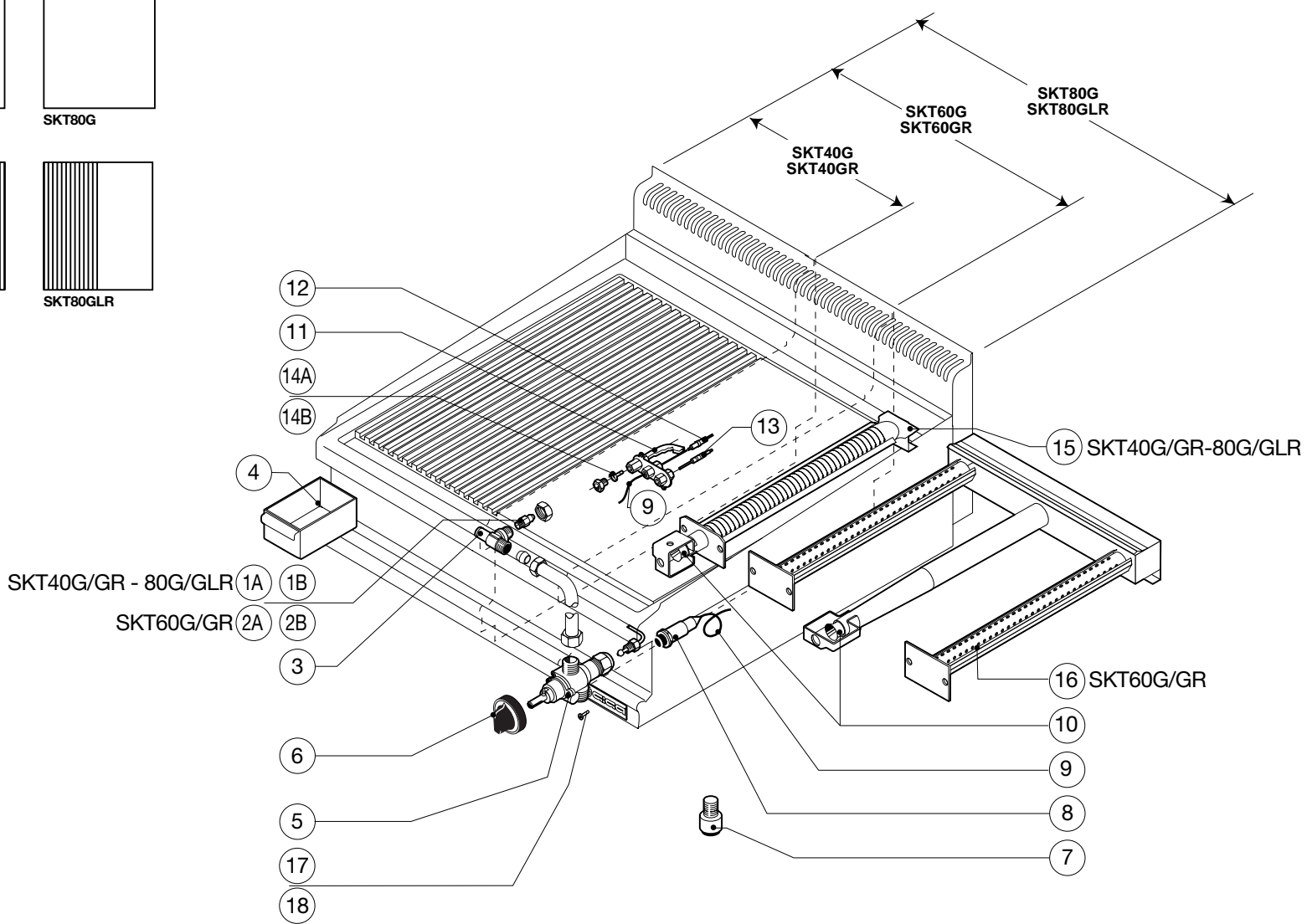

A = GPL / LP gas / Gaz liquide / Flüssiggas  
B = Gas metano / Natural gas / Gaz naturel / Erdgas



3E07-066

SKT40G-SKT40GR  
SKT60G-SKT60GR  
SKT80G-SKT80GLR

| Pezzi/Pieces<br>Pieces/Anzahl |         |        |         |        |        | Pos. | Validità dalla<br>matricola<br>Validité du<br>numéro matricule<br>Validity from<br>serial number<br>Gültigkeit ab der<br>(Seriennummer) | Validità alla<br>matricola<br>Validity up to<br>serial number<br>Validité au<br>numéro matricule<br>Gültigkeit bis zur<br>(Seriennummer) | Codice<br>Code<br>Artikel<br>Nummer | Descrizione               | Description                      | Description                  | Beschreibung                  |
|-------------------------------|---------|--------|---------|--------|--------|------|---|--|-------------------------------------|---------------------------|----------------------------------|------------------------------|-------------------------------|
| SKT40G                        | SKT40GR | SKT60G | SKT60GR | SKT80G | SKT80G |      |   |  |                                     |                           |                                  |                              |                               |
| 1                             | 1       |        |         | 2      | 2      | 1A   |   |  | X34000                              | Iniettore GPL             | LPG injector                     | Injecteur GPL                | Gasdüse GPL                   |
| 1                             | 1       |        |         | 2      | 2      | 1B   |   |  | X35200                              | Iniettore metano          | Natural gas injector             | Injecteur methane            | Gasdüse Methan                |
|                               |         | 1      | 1       |        |        | 2A   |   |  | X34700                              | Iniettore GPL             | LPG injector                     | Injecteur GPL                | Gasdüse GPL                   |
|                               |         | 1      | 1       |        |        | 2B   |   |  | X36000                              | Iniettore metano          | Natural gas injector             | Injecteur methane            | Gasdüse Methan                |
| 1                             | 1       | 1      | 1       | 2      | 2      | 3    |   |  | 0000X16100                          | Porta iniettore           | Injector-holder                  | Porte-injecteur              | Düsenträger                   |
| 1                             | 1       | 1      | 1       | 1      | 1      | 4    |   |  | B12100                              | Cassetto raccogliughi     | Deep fat tray                    | Tiroir de recueil des jus    | Fettauffangwanne              |
| 1                             | 1       |        |         | 2      | 2      | 5    |   |  | X08100                              | Rubinetto gas             | Gas cock                         | Robinet gaz                  | Gashahn                       |
| 1                             | 1       | 1      | 1       | 2      | 2      | 6    |   |  | 0000Y65103                          | Manopola fuoco con pilota | Gas ring knob with pilot         | Cle de comm. feu avec veill. | Drehknopf kochst. mit Zündfl. |
| 4                             | 4       | 4      | 4       | 4      | 4      | 7    |   |  | M06400                              | Piedino                   | Foot                             | Pied                         | Fuss                          |
| 1                             | 1       | 1      | 1       | 2      | 2      | 8    |   |  | M02100                              | Piezo elettrico           | Piezo-electric ignition          | Piezo électrique             | Piezoelektrischer Zünder      |
| 1                             | 1       | 1      | 1       | 2      | 2      | 9    |   |  | X40100                              | Cavo per piezo            | Piezoelectric cable              | Cable pour piezo             | Kabel für Piezozünder         |
| 1                             | 1       | 1      | 1       | 2      | 2      | 10   |   |  | X20200                              | Boccola registro aria     | Air-regulation bush              | Douille de réglage de l'air  | Luftreglerbuchse              |
| 1                             | 1       | 1      | 1       | 2      | 2      | 11   |   |  | X13000                              | Pilota                    | Pilot                            | Veilleuse d'allumage         | Zündflammenbrenner            |
| 1                             | 1       | 1      | 1       | 2      | 2      | 12   |   |  | X13001                              | Candeletta                | Ignition plug                    | Bougie                       | Glühkerze                     |
| 1                             | 1       | 1      | 1       | 2      | 2      | 13   |   |  | X14200                              | Termocoppia               | Thermocouple                     | Thermocouple                 | Thermoelement                 |
| 1                             | 1       | 1      | 1       | 2      | 2      | 14A  |   |  | X30000                              | Iniettore pilota GPL      | LPG plate pilot injector         | Injecteur veill. d'all. Gpl  | Gasdüse Zündflamm. GPL        |
| 1                             | 1       | 1      | 1       | 2      | 2      | 14B  |   |  | X30100                              | Iniettore pilota Metano   | Natural gas plate pilot injector | Injecteur Methane            | Gasdüse Zündflamm. Herdgas    |
| 1                             | 1       |        |         | 2      | 2      | 15   |   |  | X20000                              | Brucciato                 | Burner                           | Bruleur                      | Brenner                       |
|                               |         | 1      | 1       |        |        | 16   |   |  | X20100                              | Brucciato                 | Burner                           | Bruleur                      | Brenner                       |
| 1                             | 1       |        |         | 2      | 2      | 17   |   |  | X10600                              | By pass d. 0,90           | By pass d. 0,90                  | By pass d. 0,90              | By pass d. 0,90               |
|                               |         | 1      | 1       |        |        | 18   |   |  | X10700                              | By pass d. 1,30           | By pass d. 1,30                  | By pass d. 1,30              | By pass d. 1,30               |