

SUPERLOTUS 70 TOP

GAS / GAS / GAS / GAZ

F13T-74G-F2/13T-78G

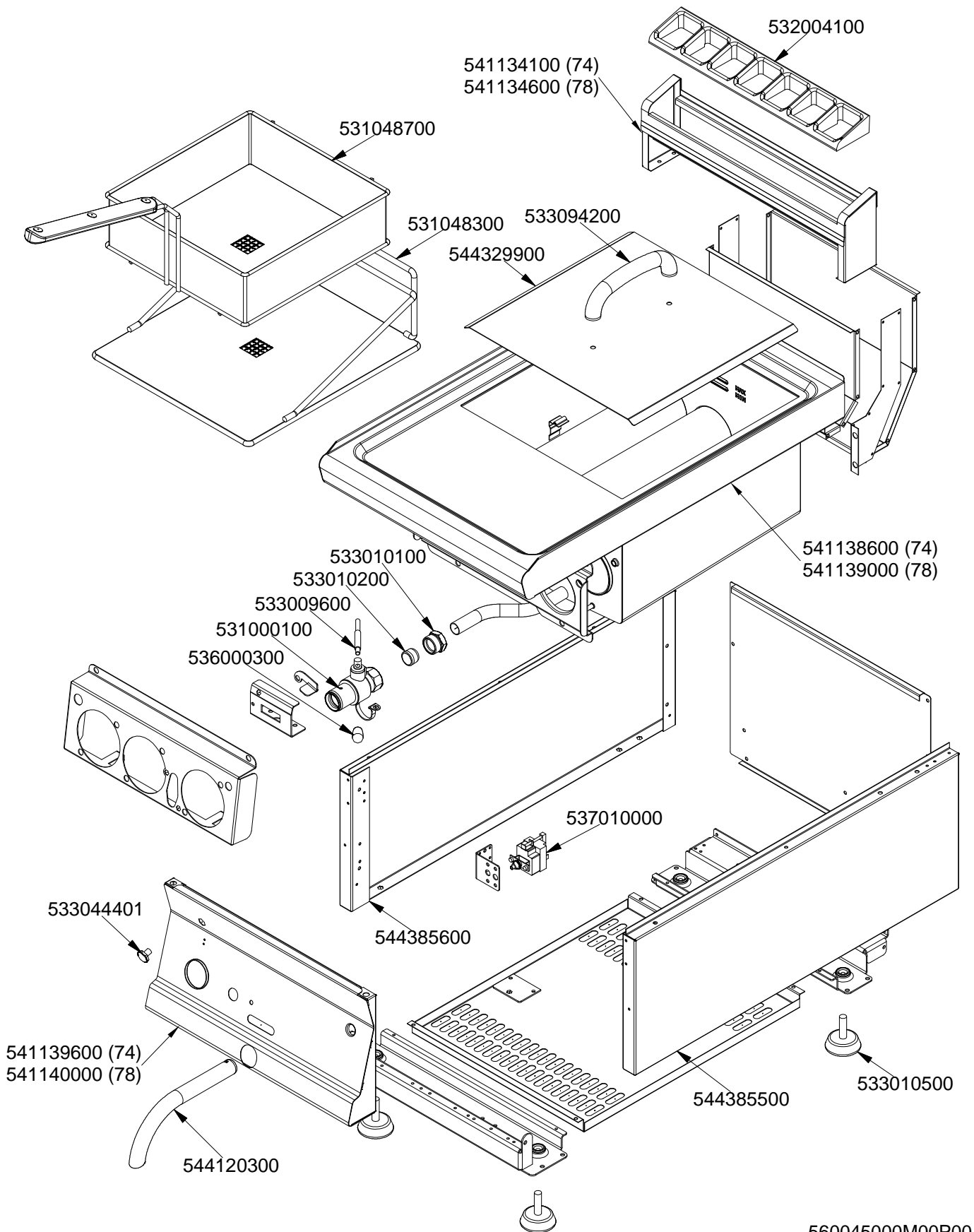

SUPERLOTUS 70 TOP

GAS / GAS / GAS / GAZ

F13T-74G-F2/13T-78G

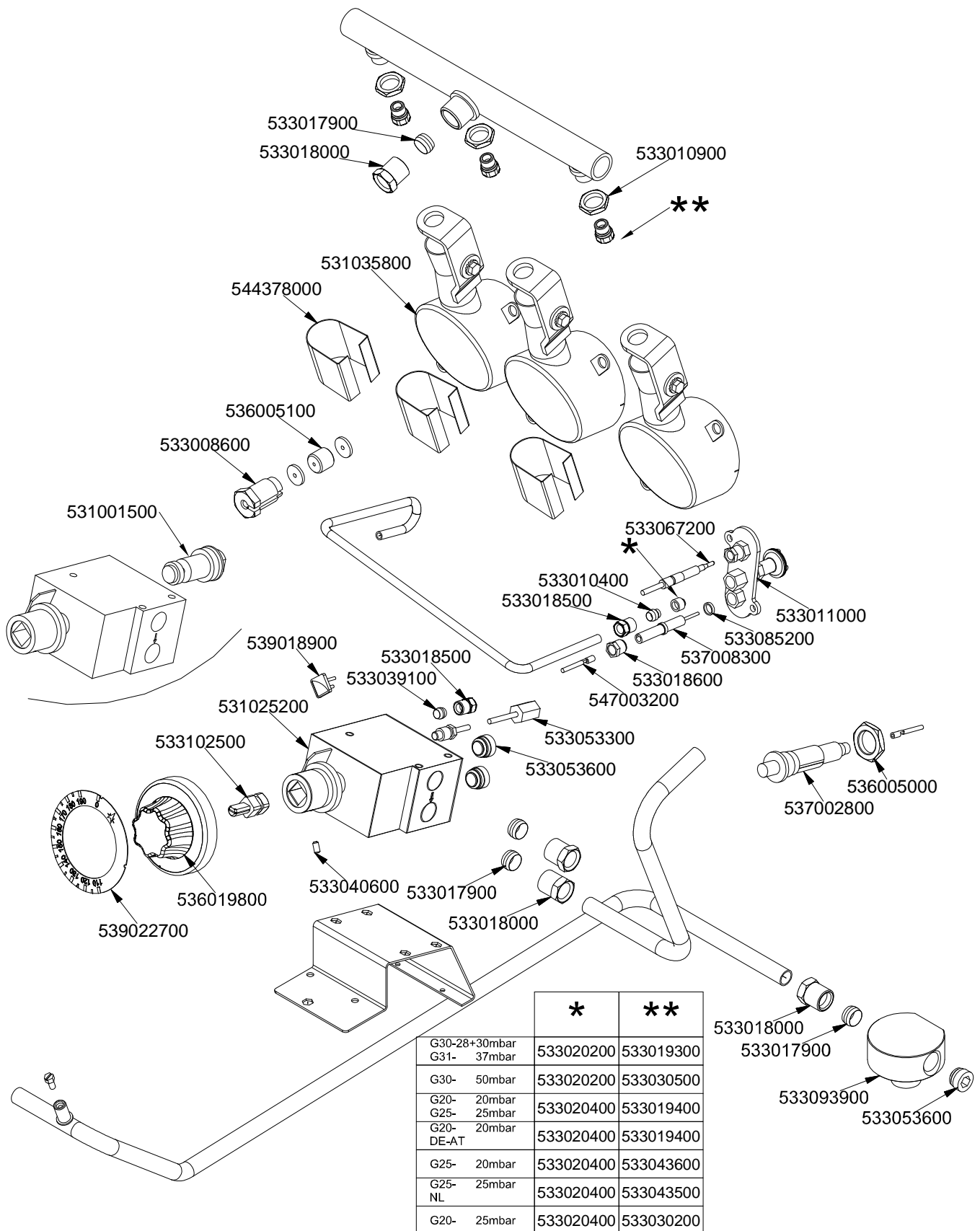

560045100M00P00

Page	Pos	Code	Description
001		541134600	LOW SPACER 78 2 GRIDS
001		541139000	UPPER PLATE S70 F2/13T-78G
001		533010100	3/4 D. 18 PIPE UNION
001		533010200	BICONE 18S
001		533009600	DRAIN COCK HANDLE
001		531000100	DRAIN COCK 3/4"
001		536000300	FIXED GRIP D.15*25*M6
001		541140000	CONTROL PANEL S70/90 F2/13T-78G
001		537010000	SAFETY THERMOSTAT 220°C SINGLEPHASE
001		533044401	M8 THREADED CAP FOR SEC.THERMOSTAT
001		544385600	LEFT SIDE OF 70T LINE
001		533094200	S/S HANDLE FOR 70/90 SERIES
001		532004100	FLUE GRID L=370 70LINE (RAF)
001		531048700	BASKET F13T 280X290X095
001		531048300	TANK FILTER/BASKET SUPPORT F13T-G
001		544385500	RIGHT SIDE OF 70T LINE
001		533010500	LEG M10*25 D.40
001		544120300	DRAIN PIPE 22 FOR COCK 3/4"G
001		544329900	
002		539022700	ADHESIVE GRADUATED DISC FOR KNOB
002		533020200	PILOT JETS 0160 FOR LPG §30
002		533020400	NOZZLE 0160 (NATURAL GAS) 51
002		533019300	NOZZLE §100 G-FQ5 F-CW
002		533030500	NOZZLE §90 CH12X14 G30/CE
002		533019400	NOZZLE §180 CH12*14 L-FQ5
002		533043600	NOZZLE §200 CH12*14 L-PC4 UR
002		533043500	NOZZLE §190 CH12*14 G25 PC4R
002		533030200	NOZZLE §170 CH12*14 MH-FG L-FP/CW
002		531001500	MAGNET FOR EUROSIT VALVE
002		533102500	
002		537002800	PIEZOELECTRIC IGNITION M18
002		536005000	NUT M18 FOR PIEZOELECTRIC IGNITION
002		533039100	BICONE §6
002		533018500	FITTING FOR BICONE D.6 M10*1
002		539018900	INDEX FOR KNOB
002		533053600	EUROSIT VALVE PLUG
002		533053300	THERMOCOUPLE EXTENSION M9*1
002		547003200	HIGH-VOLTAGE CABLE TUBE.§2 L=500
002		533018600	PLUG FITTING
002		537008300	ROUND PLUG §2,4- LONG ELECTRODE
002		533085200	
002		533010400	BICONE D.6
002		533067200	THERMOCOUPLE 220+500 M9*1 CUT-OFF
002		533011000	PILOT BURNER 3 FLAMES 320
002		533008600	STUFFING BOX M9*1
002		536005100	GRAPHITE §07,4 GASKET
002		531025200	EUROSIT VALVE FQ 110-190°C
002		533018000	ELBOW FOR BICONE D.12 3/8 RS L20
002		533010900	NUT M14*1 H.4
002		533017900	BICONE D.12
002		544378000	

Page	Pos	Code	Description
002		531035800	BURNER FOR FRYER F13T
002		536019800	BLACK KNOB \$70 PIN \$8*6,5
002		533040600	HEADLESS SCREW M4*8
002		533093900	FITTING GAS ENTRY 1/2G 2OUT 3/8G