



cookmax 

Snackgeräte Induktions-Kochfläche

Artikel-Nr.
70246029 (2224)

Explosionszeichnung / Ersatzteile

Bitte bei Ersatzteilbestellung immer Artikelnummer und Seriennummer mit angeben!

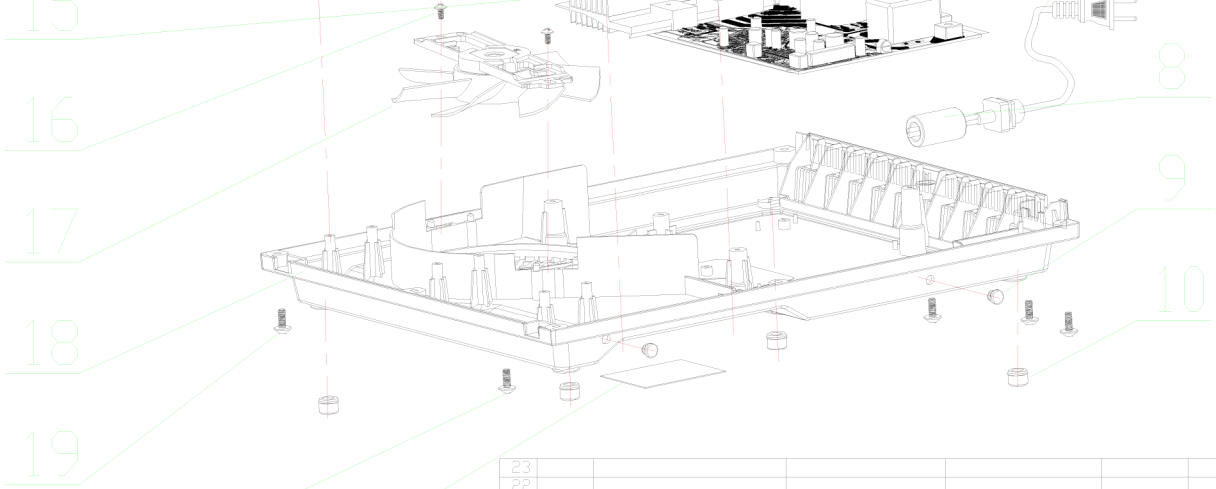

23										
22										
21	name plate (后铭牌)			(镀锌) ST16x14	1					
20	Screw (H螺钉)			(镀锌) ST16x14	1					
19	Screw (十字螺钉)	SUS304		ST4x14	5					
18	Bottom enclosure (底壳)	PP (Rohs)			1					
17	Fan motor (风机)			18VDC-43A ①18.2200R/min.	1					
16	Screw (螺钉)			nickelating (镀锌) ST3x10	2					
15	Power PCB (主电路板)				1					
14	control PCB (控制电路板)				1					
13	Screw (螺钉)			nickelating (镀锌) ST3x7	7					
12	Induction coil (电磁发热器)	Copper Rosh (铜)		Φ31*22支*26隔 L=110mm 180° C	1					
11	Screw (螺钉)			nickelating (镀锌) M4x6	8					
10	Rubber foot (字脚)	silicon gel (硅胶)			4					
9	rubber stopper (柱塞)	silicon gel (硅胶)			2					
8	magnet ring (磁环)			Φ7*Φ10*8.5mm	1					
7	power cord (电源线)	PVC		230V-16A1 19mm ² L=12M	1					
6	Plug (插头)			FE-102P	1					
5	Screw (螺钉)			镀锌 ST3x6	4					
4	NTC enclosure (NTC壳体)	silicon gel (硅胶)		DC732	1					
3	NTC sensor (热敏电阻)			100K +/-1% 3950K +/-1%	1					
2	Lid enclosure (上盖)	ABS-(Rohs)			1					
1	Glass plain Plate (液晶玻璃板)	glass ceramics (液晶玻璃)		356*275*4	1					

NO.	Drw No.	Name (名称)	Material (材料)	Spec (规格)	Quantity (数量)	W/Ht	Remarks(备注)
△							
△							
NO.	DATE	SIGN	CHECK	REVISION		CONTENTS	
	UNIT	mm	DRAWN	Teng-2016-4-20		PART NAME	exploded view
	SCALE	1/1	DESIGNED	Teng-2016-4-20		MODEL	VP1-21A-4(全黑款)
	TOLERANCE		CHECKED	Teng-2016-4-20			
			APPROVED			PART NO.	