

Kühlung Büffet-Element

Artikel-Nr. 651129 (9BESS4FIVCA93 / ES-PLAT4C+RIPINFC4 mit
Entnahmeklappen)

Explosionszeichnung / Ersatzteile

Bitte bei Ersatzteilbestellung immer Artikelnummer und Seriennummer
mit angeben!

| Code | Description | Notes |
|----------------|--------------------------------|-------|
| 9BESS4FIVCA93E | EXPLODED VIEW 1 | |
| 9BESS4FIVCA93E | EXPLODED VIEW 2 | |
| 73688954 | FULL EVAPORATOR KIT | 5 |
| 74837184 | FAN PROTECTION FILTER | 2 |
| 74700708 | LIQUID RECEIVER | 2 |
| 74865634 | COMPRESSOR | 4 |
| 74837119 | CONDENSER | 5 |
| 73669674 | DOOR KIT | |
| 73669444 | DOOR | |
| 74867018 | COMPRESSOR ELECTRICAL PARTS | 2 |
| 74839104 | EVAPORATOR | 5 |
| 74848160 | FAN | 2 |
| 74848118 | FAN BLADE | 2 |
| 74845036 | TANGENTIAL FAN | 2 |
| 74776568 | SIDE GLASS | |
| 74776534 | CURVED TOP GLASS | |
| 74776644 | GLASS TOP MIDDLE SHELF | |
| 74776634 | BOTTOM GLASS MIDDLE SHELF | |
| 74776664 | AIR-CONVEYOR PER DOOR LATERALE | |
| 74776665 | CENTRAL DOOR AIR-CONVEYOR | |
| 74776567 | PLEXIGLASS DOOR | |
| 74776565 | PLEXIGLASS STRUCTURE | |
| 74776535 | DEFLETTORE | |
| 74845124 | FAN GRID | |
| 74847194 | EVAPORATOR GRID | |
| 74742008 | MAIN ON/OFF SWITCH | 2 |
| 74742017 | LIGHT ON/OFF SWITCH | 2 |
| 75956088 | POWER RELAY | 2 |
| 72539281 | CONDENSING UNIT SUPPORT | |
| 72539288 | CONDENSING UNIT GRID | |
| 72556044 | PAN SUPPORT | |
| 72538764 | EVAPORATOR COVERING | |
| 72538684 | EVAPORATOR FRONT AIR-CONVEYOR | |
| 72538674 | EVAPORATOR REAR AIR-CONVEYOR | |

9BESS4FIVCA93-ESSENCE PLATINUM 4 FLAPS INCORPORATO

| PARAM. | OPTIONAL |
|--------|----------|
| ICE001 | |
| TWR001 | |
| OPT | |

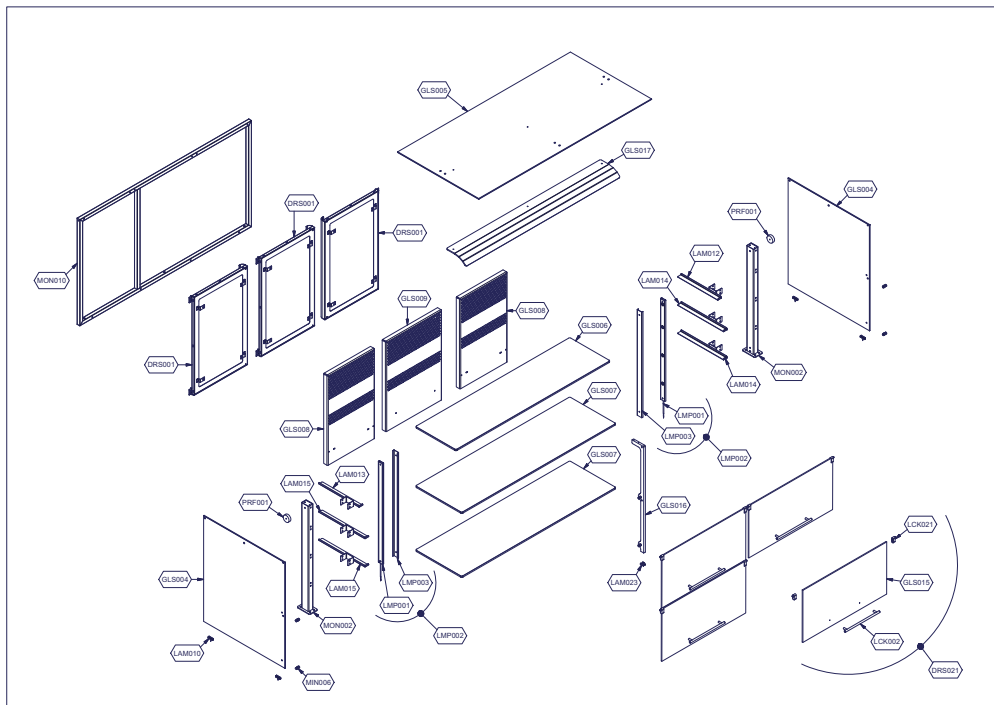
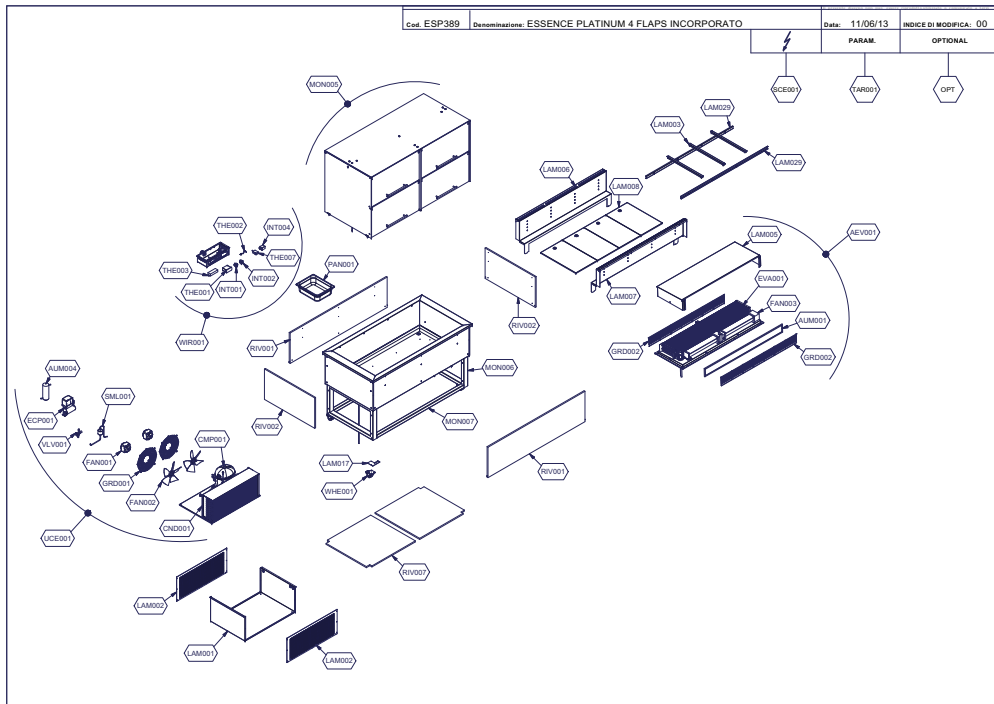

| Code | Description | Notes |
|-------------|-----------------------------------|-------|
| 74707262 | WELL TRAY | |
| 72557114 | GLASS SUPPORT | |
| 72538730 | TOP RIGHT SUPPORT | |
| 72538732 | TOP LEFT SUPPORT | |
| 72538734 | BOTTOM RIGHT SUPPORT | |
| 72538736 | BOTTOM LEFT SUPPORT | |
| 72539674 | FRAME FIXING KIT | |
| 72538800 | S/S SIDE SUPPORT | |
| 72539484 | PANS SUPPORTS | |
| 74701602 | HANDLE | 3 |
| 74702300 | HINGE | 5 |
| 72539020 | LED LIGHTING | |
| 72539028 | LAMP WITH PROTECTION | |
| 72539026 | LED LIGHTING PROTECTION | |
| 72540437 | SUPPORT | |
| 72538990 | SUPERSTRUCTURE SIDE SUPPORT | |
| 73669434 | GLASS SUPERSTRUCTURE W/O FLAPS | |
| 72539682 | SIDE FRAME | |
| 72539694 | FRONT BOTTOM FRAME | |
| 72538954 | DOOR SUPPORT FRAME | |
| 74707120 | PAN | 3 |
| 72538992 | SPACER | |
| 72546814 | FOOD ISLAND TOP LONGER SIDE PANEL | |
| 72546794 | FOOD ISLAND TOP SIDE PANEL | |
| 72546894 | BOTTOM SHELF | |
| SC850 | ELECTRICAL WIRING | 1 |
| 73670196 | DRIER FILTER | 2 |
| RIF.TAR.B08 | CONTROLLER PRESETTING SERVICE | 1 |
| 74700881 | UNSETTED ELECTRONIC CONTROLLER | 1 |
| 74700916 | PROBE | 1 |
| 74700892 | LED POWER PACK | 1 |
| 74700954 | SPEED FAN CONTROLLER | 1 |
| 74861586 | FULL CONDENSING UNIT | |
| 74877107 | VALVE | 4 |

9BESS4FIVCA93-ESSENCE PLATINUM 4 FLAPS INCORPORATO

| Code | Description | Notes |
|-------------|--------------------|--------------|
| 74708007 | CASTOR/FEET | |
| 73669908 | POWER BOX | |