

MAGICLOTUS 60

CUCINE / RANGES / HERDE / CUISINIÈRES

CWT-64G CWT-66G CWT-68G

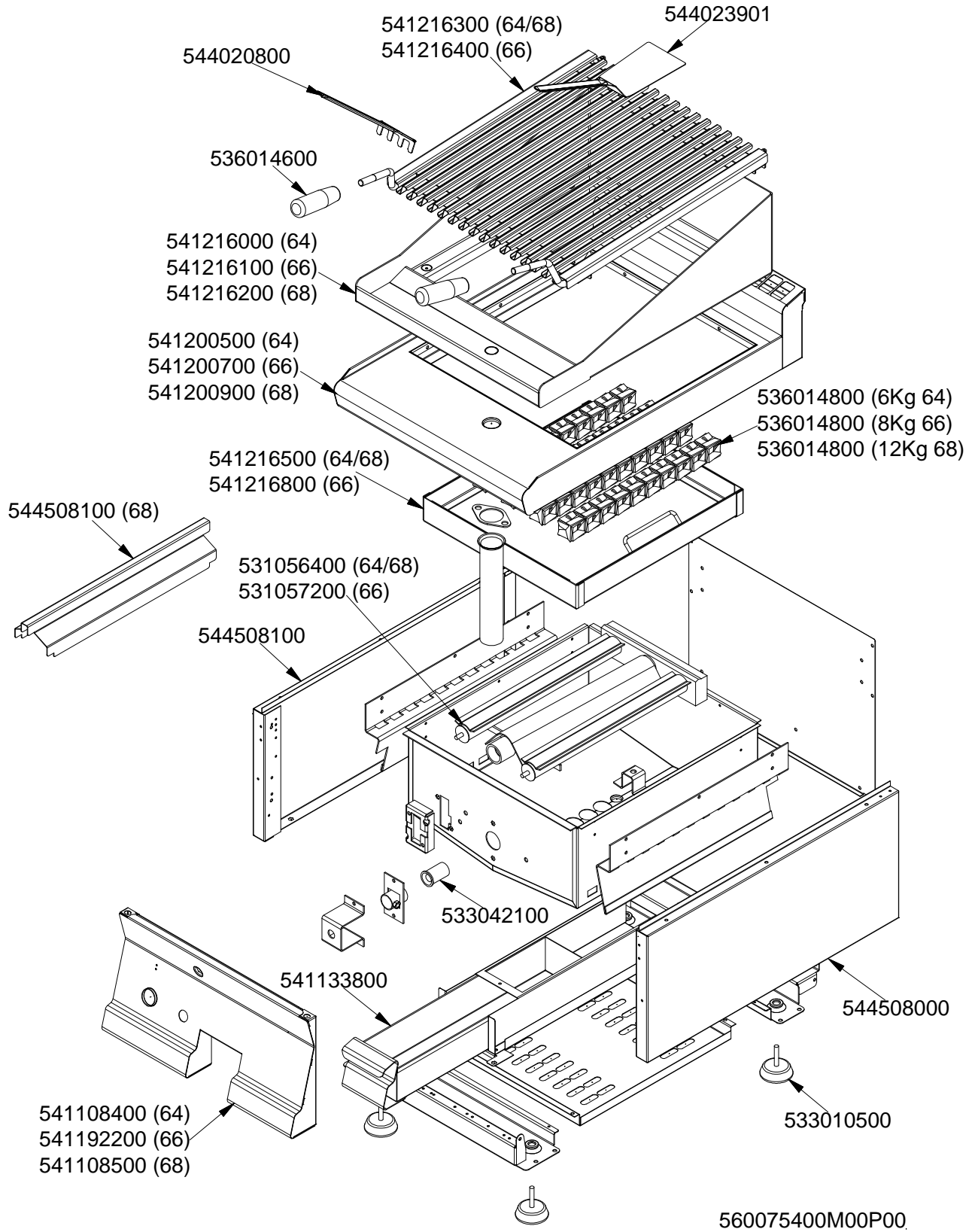

MAGICLOTUS 60

CUCINE / RANGES / HERDE / CUISINIÈRES

CWT-64G CWT-66G CWT-68G

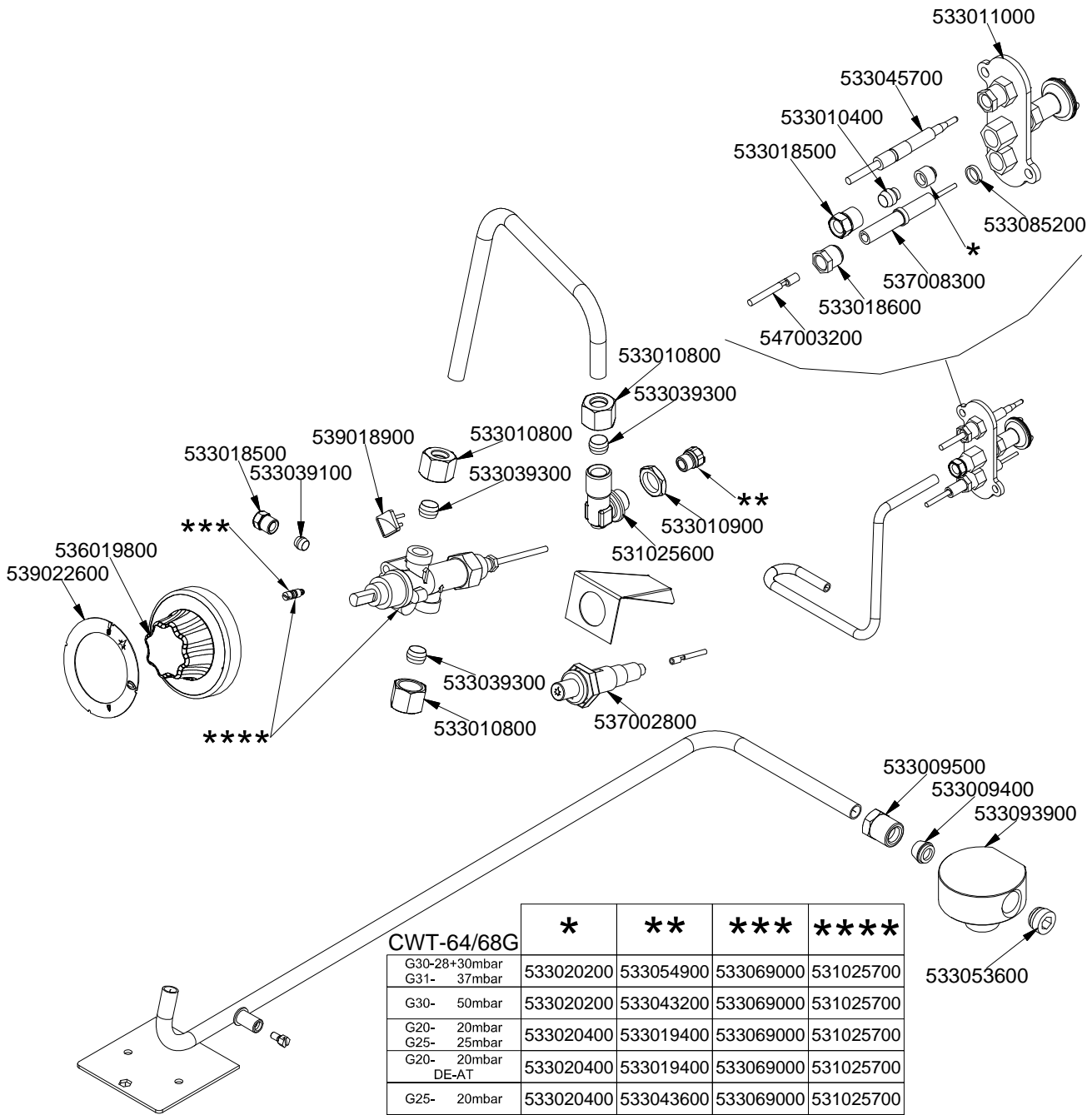

CWT-64/68G	*	**	***	****
G30-28+30mbar G31- 37mbar	533020200	533054900	533069000	531025700
G30- 50mbar	533020200	533043200	533069000	531025700
G20- 20mbar G25- 25mbar	533020400	533019400	533069000	531025700
G20- 20mbar DE-AT	533020400	533019400	533069000	531025700
G25- 20mbar	533020400	533043600	533069000	531025700
G25- 25mbar NL	533020400	533043100	533069000	531025700
CWT-66G	*	**	***	****
G30-28+30mbar G31- 37mbar	533020200	533014900	533047900	531032100
G30- 50mbar	533020200	533120000	533047900	531032100
G20- 20mbar G25- 25mbar	533020400	533056100	533047900	531032100
G20- 20mbar DE-AT	533020400	533056100	533047900	531032100
G25- 20mbar	533020400	533056300	533047900	531032100
G25- 25mbar NL	533020400	533056200	533047900	531032100

560075500M00P00

Page	Pos	Code	Description
001		544023901	SPATTLE FOR FRY-TOP
001		541216300	GRID CWT-64
001		544020800	SPATTLE FOR CW S70 S90
001		536014600	GRIP D.28*90*M10 CW
001		541216200	SPLASH GUARD CWT-68
001		541200900	UPPER PLATE CWT-68G
001		536014800	LAVASTONE
001		541216500	STONE SUPPORTING FRAME CWT-64G
001		544508100	
001		531056400	BURNER CWT-64G 5,0KW
001		533010500	LEG M10*25 D.40
001		533042100	AIR ADJUSTMENT BUSHING CW-G
001		541133800	DRIP TRAY FT-55
001		544508000	
001		541108500	CONTROL PANEL CW-78/98G
002		533011000	PILOT BURNER 3 FLAMES 320
002		533045700	THERMOCOUPLE M9*1 500
002		533010400	BICONE D.6
002		533018500	FITTING FOR BICONE D.6 M10*1
002		533085200	
002		537008300	ROUND PLUG §2,4- LONG ELECTRODE
002		533018600	PLUG FITTING
002		547003200	HIGH-VOLTAGE CABLE TUBE.§2 L=500
002		533010800	TUBE NUT D.10 M16*1,5
002		533039300	BICONE §10
002		539018900	INDEX FOR KNOB
002		533039100	BICONE §6
002		536019800	BLACK KNOB §70 PIN §8*6,5
002		539022600	GRADUATED STICKER FOR KNOB
002		533010900	NUT M14*1 H.4
002		531025600	ELBOW 90° NOZZLE-HOLDER §10 PIPE
002		537002800	PIEZOELECTRIC IGNITION M18
002		533009500	NIPPLE FOR BICONE 10S
002		533009400	BICONE 10S
002		533093900	FITTING GAS ENTRY 1/2G 2OUT 3/8G
002		533053600	EUROSIT VALVE PLUG
002		533020200	PILOT JETS 0160 FOR LPG §30
002		533054900	NOZZLE §120 CH12*14
002		533069000	BY PASS COCK §70 20S-21S
002		531025700	SAFETY TAP 21S-B PEL21S22070
002		533043200	NOZZLE §110 G30 (LPG) CH12X14
002		533020400	NOZZLE 0160 (NATURAL GAS) 51
002		533019400	NOZZLE §180 CH12*14 L-FQ5
002		533043600	NOZZLE §200 CH12*14 L-PC4 UR
002		533043100	NOZZLE §185 G25 CH12X14