

MAGIC SNACK 60

GAS / GAS / GAS / GAZ

FP-62G

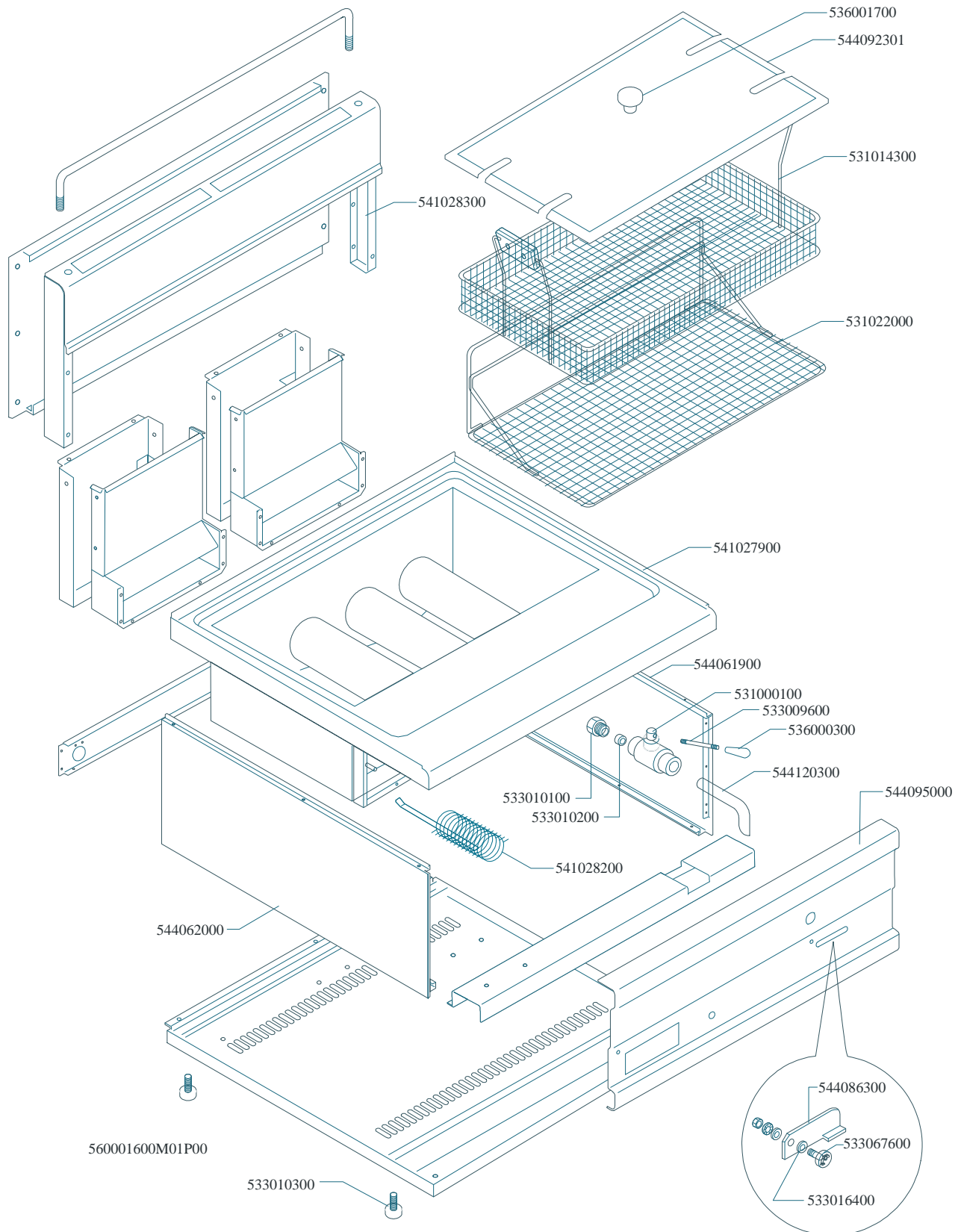

MAGIC SNACK 60

GAS / GAS / GAS / GAZ

FP-62G

| | * | ** | *** |
|-------------------------------|-----------|-----------|-----------|
| G30- 28+30mbar G31- 37mbar | 533020200 | 533030100 | 531006400 |
| G30- 50mbar | 533020200 | 533015100 | 531030600 |
| G20- 20mbar G25- 25mbar | 533020400 | 533014800 | 531006400 |
| G20- 20mbar DE-AT | 533020400 | 533014800 | 531030600 |
| G25- 20mbar | 533020400 | 533030800 | 531030600 |
| G25- 25mbar NL | 533020400 | 533015200 | 531006400 |

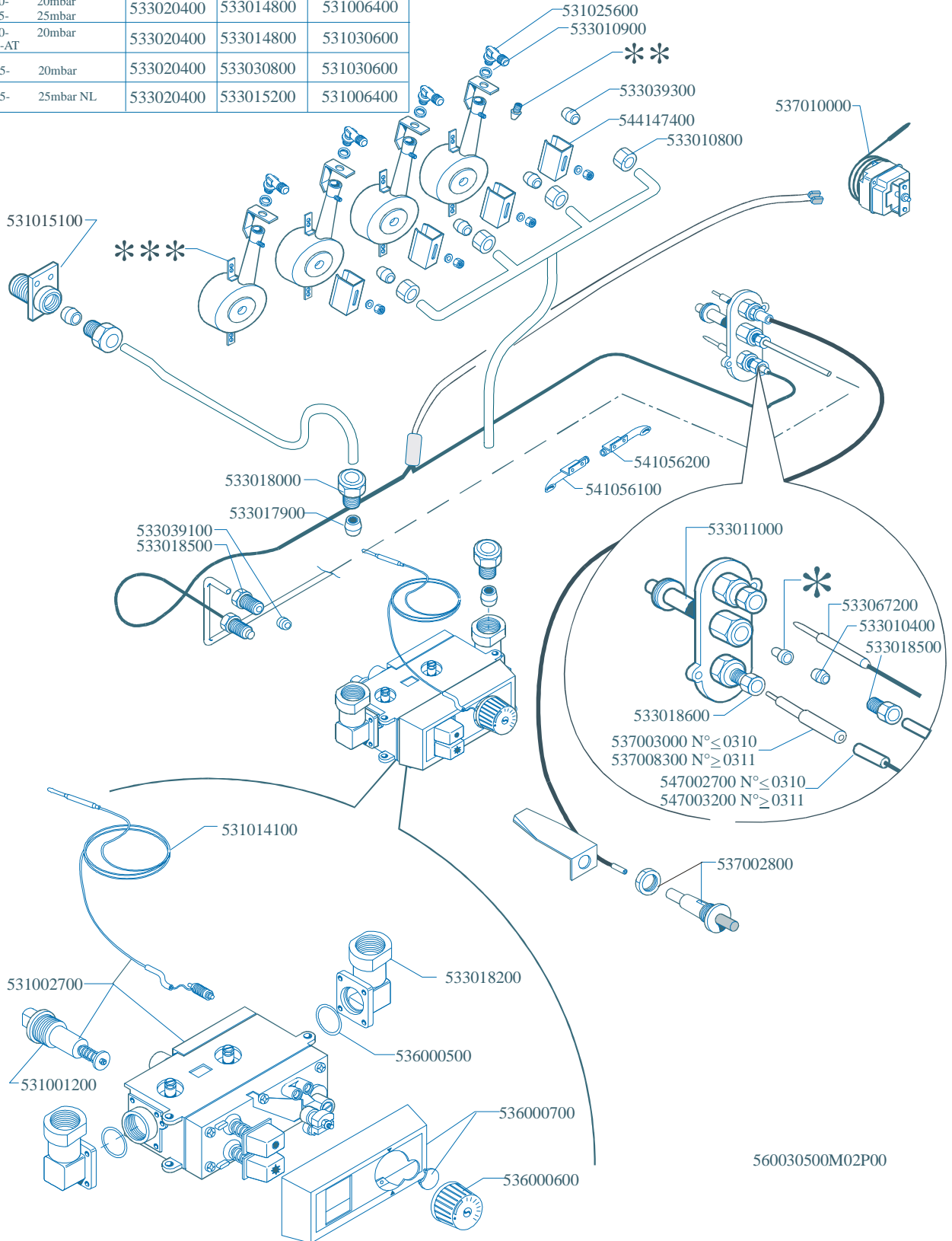

| Page | Pos | Code | Description |
|------|-----|-----------|-------------------------------------|
| 001 | | 536001700 | GRIP D.25*19*M6 |
| 001 | | 544092301 | TANK LID FP-62/6ET |
| 001 | | 531014300 | FRYER BASKET FP-62E/G |
| 001 | | 541028300 | SPACER FP/CP-62G |
| 001 | | 531022000 | TANK FILTER/BASKET SUPPORT*FP-62G |
| 001 | | 541027900 | UPPER PLATE FP-62G |
| 001 | | 544061900 | RIGHT SIDE PANEL 60 LINE |
| 001 | | 531000100 | DRAIN COCK 3/4" |
| 001 | | 533009600 | DRAIN COCK HANDLE |
| 001 | | 536000300 | FIXED GRIP D.15*25*M6 |
| 001 | | 544120300 | DRAIN PIPE 22 FOR COCK 3/4"G |
| 001 | | 544095000 | CONTROL PANEL FP-62G |
| 001 | | 533010100 | 3/4 D. 18 PIPE UNION |
| 001 | | 533010200 | BICONE 18S |
| 001 | | 541028200 | HEAT ACCUMULATOR FQ-61G |
| 001 | | 544062000 | LEFT SIDE PANEL 60 LINE |
| 001 | | 533010300 | ADJUSTABLE FOOT M10*20 D.23 |
| 001 | | 544086300 | COCK FIXING BRACKET |
| 001 | | 533067600 | PIN FOR GRADUATED COCK BUSHING |
| 001 | | 533016400 | COCK BUSHING |
| 002 | | 531025600 | ELBOW 90° NOZZLE-HOLDER §10 PIPE |
| 002 | | 533010900 | NUT M14*1 H.4 |
| 002 | | 533039300 | BICONE §10 |
| 002 | | 544147400 | AIR ADJUSTMENT BUSHING FMG-FQ |
| 002 | | 533010800 | TUBE NUT D.10 M16*1,5 |
| 002 | | 537010000 | SAFETY THERMOSTAT 220°C SINGLEPHASE |
| 002 | | 531015100 | FITTING 1/2"G - 3/8" G |
| 002 | | 541056200 | RIGHT IGNITION TUBE FP-62G |
| 002 | | 541056100 | LEFT IGNITION TUBE FP-62G |
| 002 | | 533018000 | ELBOW FOR BICONE D.12 3/8 RS L20 |
| 002 | | 533017900 | BICONE D.12 |
| 002 | | 533039100 | BICONE §6 |
| 002 | | 533018500 | FITTING FOR BICONE D.6 M10*1 |
| 002 | | 533011000 | PILOT BURNER 3 FLAMES 320 |
| 002 | | 533067200 | THERMOCOUPLE 220+500 M9*1 CUT-OFF |
| 002 | | 533010400 | BICONE D.6 |
| 002 | | 533018600 | PLUG FITTING |
| 002 | | 537003000 | PLUG M4 - LONG ELECTRODE |
| 002 | | 537008300 | ROUND PLUG §2,4- LONG ELECTRODE |
| 002 | | 547002700 | HIGH-VOLTAGE CABLE L=500 |
| 002 | | 547003200 | HIGH-VOLTAGE CABLE TUBE.§2 L=500 |
| 002 | | 537002800 | PIEZOELECTRIC IGNITION M18 |
| 002 | | 531014100 | VALVE CAPILLARY PROBE FOR FG §6 |
| 002 | | 533018200 | ELBOW OR GJ 3/8 |
| 002 | | 536000500 | O-RING FOR MINISIT FITTING |
| 002 | | 536000700 | PLASTIC COVER FOR MINISIT + SCREW |
| 002 | | 536000600 | BLACK LHD KNOB OP. FOR MINISIT |
| 002 | | 531002700 | MINISIT VALVE 100-190°C FQ/FG |
| 002 | | 531001200 | MAGNET AC/2-MINISIT |
| 002 | | 533020200 | PILOT JETS 0160 FOR LPG §30 |
| 002 | | 533030100 | NOZZLE §95 CH12*14 G-FP |

| Page | Pos | Code | Description |
|-------------|------------|-------------|------------------------------|
| 002 | | 531006400 | FRYER BURNER FQ-61G |
| 002 | | 533015100 | NOZZLE §80 CH12*14 F-FP/CP6 |
| 002 | | 531030600 | BURNER "S" FQ-61G |
| 002 | | 533020400 | NOZZLE 0160 (NATURAL GAS) 51 |
| 002 | | 533014800 | NOZZLE §135 CH12*14,0 |
| 002 | | 533030800 | NOZZLE §155 CH12X14 M-CW |
| 002 | | 533015200 | NOZZLE §145 CH12*14 F-FP/CP6 |