

CFTG4 TT40G    CFTG6 - TT60G    CFTG8 - TT80G

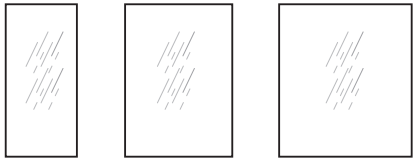

CFTG4C TT40GC    CFTG6C - TT60GC    CFTG8C - TT80GC

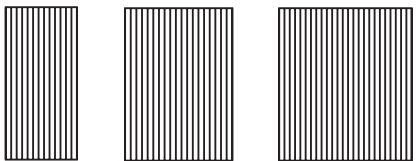

CFTG4R TT40GR    CFTG6R - TT60GR    CFTG8R

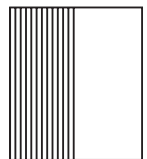

CFTG8LR - TT80GLR

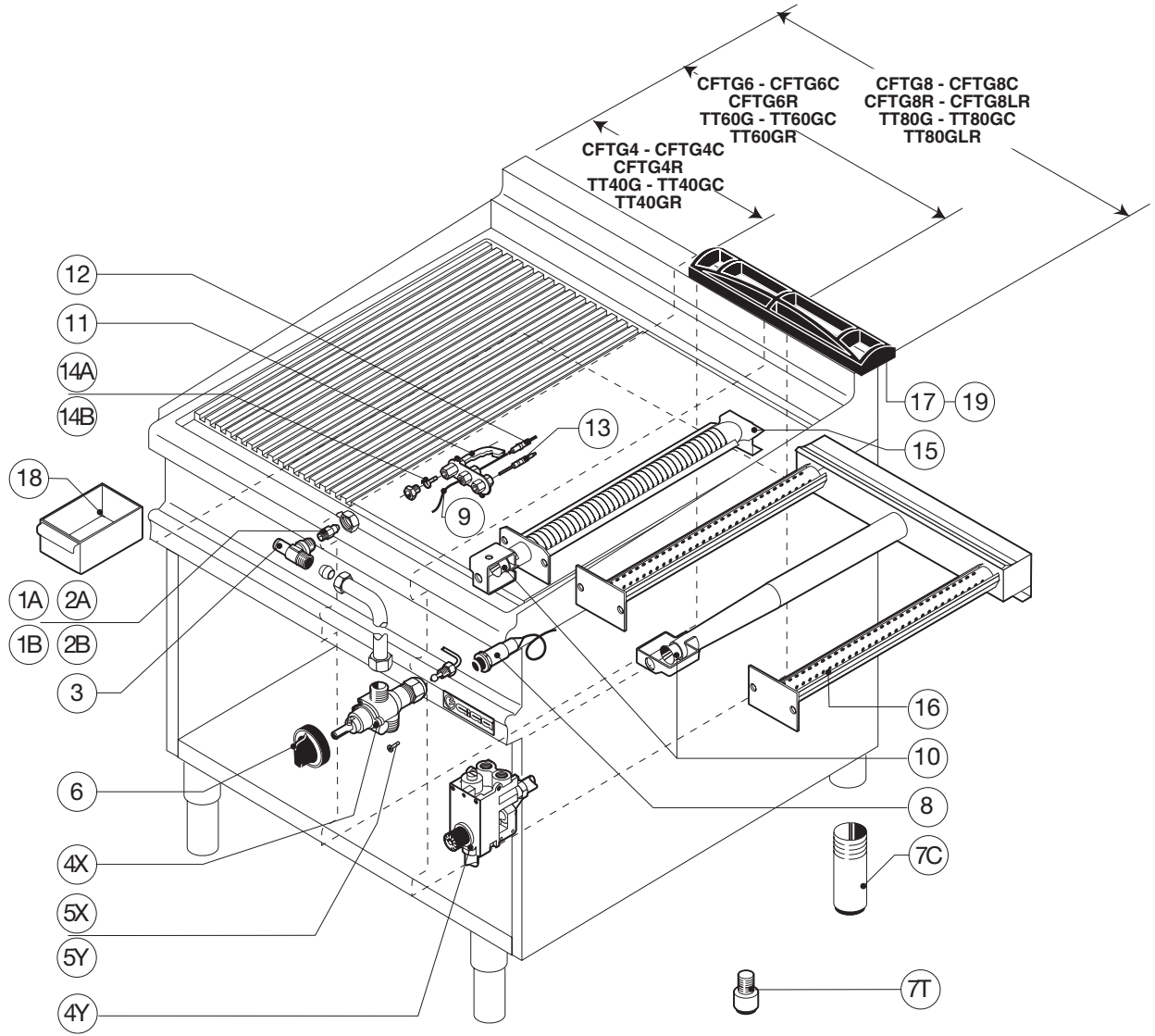

A = GPL / LP gas / Gaz liquide / Flüssiggas (2H)  
 B = Gas metano / Natural gas / Gaz naturel / Erdgas (3+)



**3E05-059**

CFTG4 - CFTG4C - CFTG4R - TT40G - TT40GC - TT40GR  
 CFTG6 - CFTG6C - CFTG6R  
 TT60G - TT60GC - TT60GR  
 CFTG8 - CFTG8C - CFTG8R - CFTG8LR  
 TT80G - TT80GC - TT80GLR

Pezzi/Pieces Pieces/Anzahl							Pos.	Validità dalla matricola Validity from serial number Validité du numéro matricule Gültigkeit ab der (Seriennummer)	Validità alla matricola Validity up to serial number Validité au numéro matricule Gültigkeit bis zur (Seriennummer)	Codice Code Artikel Nummer	Descrizione	Description	Description	Beschreibung
CFTG4/G4R TT40G/40GR*	CFTG4C TT40GC*	CFTG6/G6R TT60G/60GR*	CFTG6C TT60GC*	CFTG8/G8R/ G8LR TT80G/80GLR*	CFTG8C TT80GC*									
1	1			2	2	1A			X34000	Iniettore GPL	LPG injector	Injecteur GPL	Gasdüse GPL	
1	1			2	2	1B			X35200	Iniettore metano	Natural gas injector	Injecteur methane	Gasdüse methan	
		1	1			2A			X34700	Iniettore GPL	LPG injector	Injecteur GPL	Gasdüse GPL	
		1	1			2B			X36000	Iniettore metano	Natural gas injector	Injecteur methane	Gasdüse methan	
1	1	1	1	2	2	3			0000X16100	Porta iniettore	Injector-holder	Porte-injecteur	Düsenräger	
1		1		2		4X			X08100	Rubinetto fuoco	Gas ring cock	Robinet feu	Gashahn kochstelle	
	1		1		2	4Y			0000X13400	Vavola gas	Gas valve	Vanne gaz	Gashahn Klappe	
1				2		5X			X09700	By Pass 0,70	By Pass 0,70	By Pass 0,70	By Pass 0,70	
		1				5Y			X10600	By Pass 0,90	By Pass 0,90	By Pass 0,90	By Pass 0,90	
1		1		2		6			0000Y65103	Manopola fuoco	Gas ring knob	Cie de commande pour feu	Drehknopf für kochstelle	
4/0*	4/0*	4/0*	4/0*	4/0*	4/0*	7C			X61000	Piedino	Foot	Pied	Fuss	
0/4*	0/4*	0/4*	0/4*	0/4*	0/4*	7T			M06400	Piedino	Foot	Pied	Fuss	
1	1	1	1	2	2	8			M02100	Piezo elettrico	Piezo-electric ignition	Piezo électrique	Piezoelektrischer Zünder	
1	1	1	1	2	2	9			X40100	Cavo A.T. L. 400	H.T. Cable l. 400	Cable H.T. L. 400	Hochspannungsk. Länge 400	
1	1	1	1	2	2	10			X20200	Boccola registro aria	Air-regulation bush	Douille de réglage de l'air	Luftreglerbuchse	
1	1	1	1	2	2	11			X13000	Pilota	Pilot	Veilleuse d'allumage	Zündflammenbrenner	
1	1	1	1	2	2	12			X13001	Candeletta	Ignition plug	Bougie	Glühkerze	
1	1	1	1	2	2	13			X14200	Termocoppia	Thermocouple	Thermocouple	Thermoelement	
1	1	1	1	2	2	14A			X30000	Iniettore pilota GPL	LPG pilot injector	Injecteur pilote GPL	Pilotdüse GPL	
1	1	1	1	2	2	14B			X30100	Iniettore pilota metano	Natural gas pilot injector	Injecteur pilote methane	Pilotdüse methan	
1	1			2	2	15			X20000	Bruciatore	Burner	Bruleur	Brenner	
		1	1			16			X20100	Bruciatore	Burner	Bruleur	Brenner	
		1	1			17			1550Y63600	Griglietta scarico fumi	Smoke discharge grid	Grille évacuation des fumées	Rauchblassgitter	
1	1	1	1	1	1	18			B12100	Cassetto raccogliughi	Deep fat tray	Tiroir de recueil des jus	Fettauffangwanne	
1	1			2	2	19			1550Y63500	Griglietta scarico fumi	Smoke discharge grid	Grille évacuation des fumées	Rauchblassgitter	