

CP-4ET CP-6ET CP-4ETX CP-6ETX

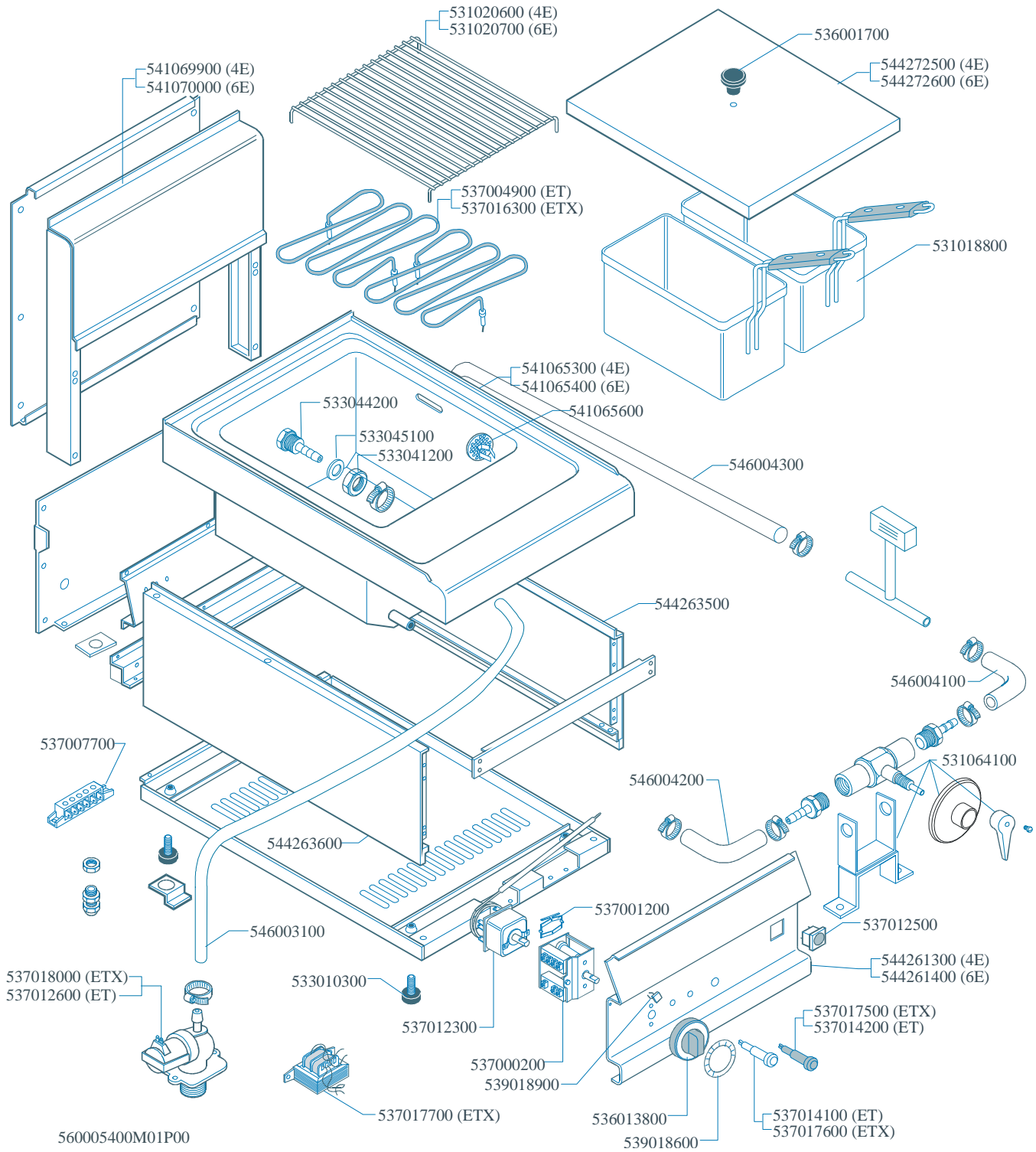

Page	Pos	Code	Description
001		536001700	GRIP D.25*19*M6
001		537016300	HEATING ELEMENT 2000W 440V CP65
001		531018800	PASTACOOKER BASKET 150X292X150H
001		533044200	H.20 INPUT FITTING
001		541065600	DRAIN FILTER CP-E 65
001		533045100	GASKET §E24*§I18*SP.1,5
001		533041200	HEXAGONAL NUT 3/8" G
001		546004300	RUBBER TUBE §I.19*§E.27*1300
001		544263500	RIGHT SIDE S.65
001		546004100	RUBBER TUBE §I.19*§E.27*L266
001		537012500	BUTTON 1POLE
001		537007700	TERMINAL BLOCK THREEPHASE 40A
001		531064100	BALL VALVE 3/4"G F-F (1320PEL)
001		546004200	RUBBER TUBE §I.19*§E.27*L156
001		544263600	LEFT SIDE S.65
001		537001200	FIXING BRACKET FOR THERMOSTAT/COMM.
001		546003100	RUBBER TUBE §I.10*§E.18*950
001		533010300	ADJUSTABLE FOOT M10*20 D.23
001		537017700	TRANSFORMER 440V/100V 10VA
001		537017500	GREEN WARNING LIGHT LOW BUD 110V
001		536013800	KNOB D.70 BLACK 6*5 WITH SPRING
001		539018600	ADHESIVE GRADUATED DISC FOR KNOB
001		537017600	WHITE WARNING LIGHT LOW BUD 110V
001		537018000	ONE-WAY SOLENOID VALVE 180°100V
001		537012300	THERMOSTAT 30/110°C THREEPHASE
001		537000200	COMMUTATOR 1 POS. 3PHASE S.49 16A
001		539018900	INDEX FOR KNOB
001		541070000	NEUTRAL SPACER 6
001		544261400	CONTROL PANEL CP-6E
001		531020700	GRID FOR CP-6E
001		544272600	TANK LID CP-6E
001		541065400	UPPER PLATE CP-6E