

# MAGICLOTUS 60

CUCINE / RANGES / HERDE / CUISINIÈRES

PCT-63G PCT-66G

	1
Vedi Pagina See Page Siehe Seite Voir Page Ver Página	101

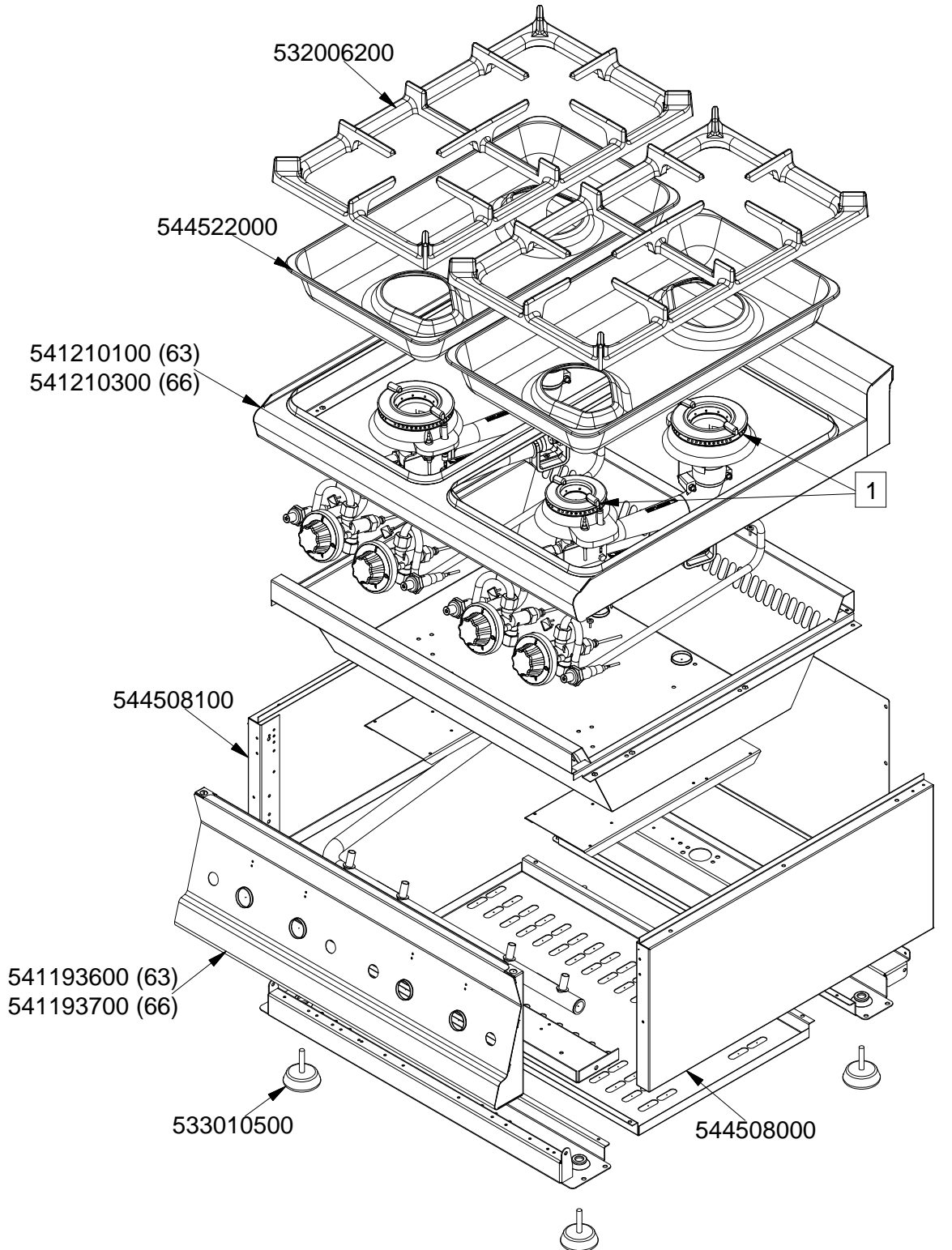

560078600M00P00

# MAGICLOTUS 60

CUCINE / RANGES / HERDE / CUISINIÈRES

COMPONENTI COMUNI / STANDARDS PARTS / UEBLICHE TEILE / COMPOSANTS COMMUNS

## PCT-G

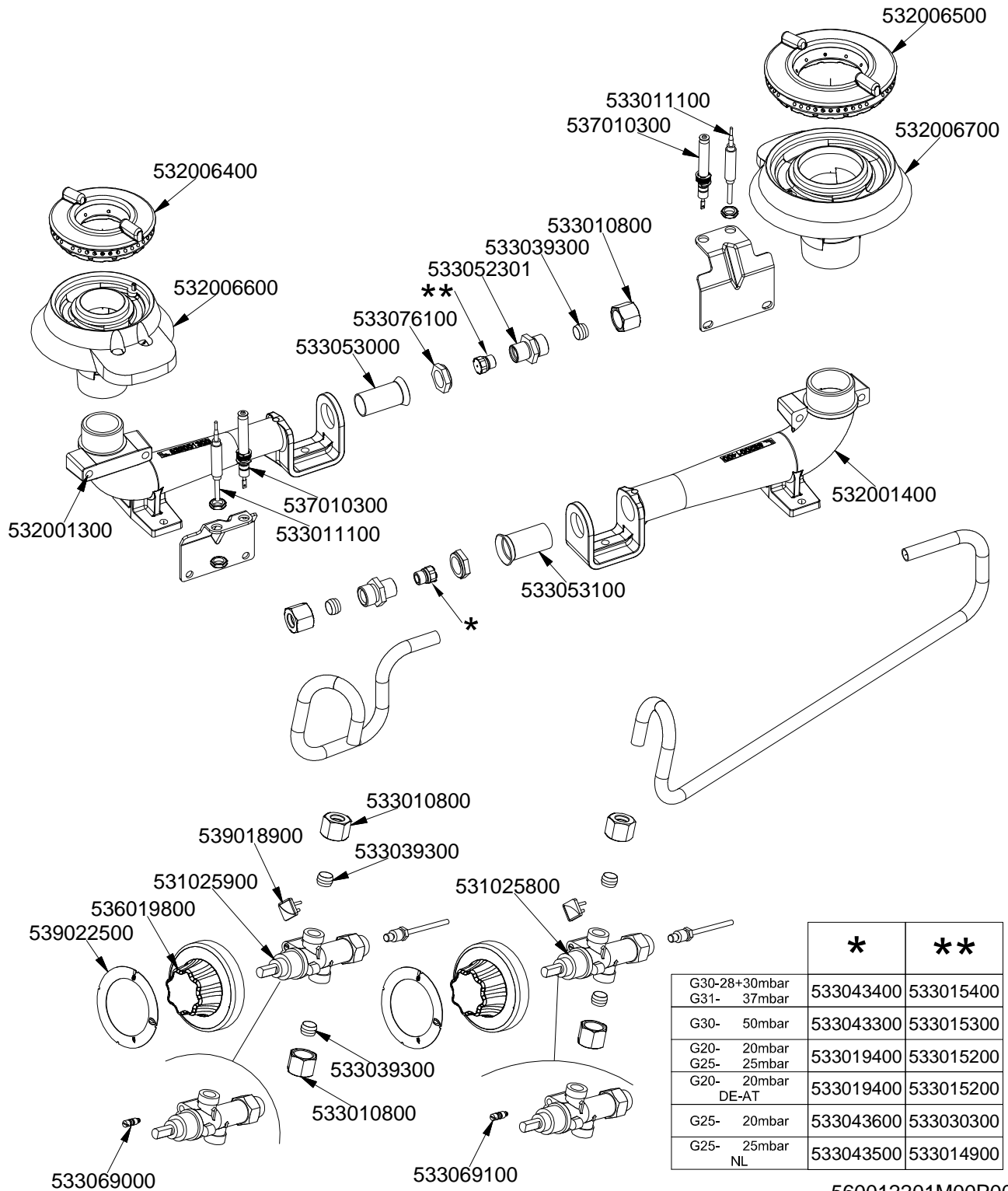

	*	**
G30-28+30mbar G31- 37mbar	533043400	533015400
G30- 50mbar	533043300	533015300
G20- 20mbar G25- 25mbar	533019400	533015200
G20- 20mbar DE-AT	533019400	533015200
G25- 20mbar	533043600	533030300
G25- 25mbar NL	533043500	533014900

560012201M00P00

Page	Pos	Code	Description
001		532006200	2 BURNERS GRID 290X505 60T RAF
001		544522000	BURNER DRIP PAN OF PCT-60
001		541210300	UPPER PLATE FOR PCT-6 6G
001		544508100	
001		541193700	CONTROL PANEL 607090 PCT-66G
001		533010500	LEG M10*25 D.40
001		544508000	
002		532006500	QUICKBURNER 2 RING Ø102 3 Z
002		532006700	BURNER BODY 5,5 KW WITH PLUG
002		533011100	THERMOCOUPLE 600 M8*1
002		537010300	PLUG IGNITION WITH SPRING PC65
002		532006400	QUICKBURNER 2 RING Ø082 3 Z
002		533010800	TUBE NUT D.10 M16*1,5
002		533039300	BICONE §10
002		533052301	JOINT FOR NOZZLE HOLDER
002		532006600	BURNER BODY 3,5 KW WITH PLUG
002		533076100	HEXAGONAL NUT M14X1 H4 + BUSHING
002		533053000	AIR ADJUSTMENT BUSHING §18
002		532001400	BURNER VENTURI 5,5 KW
002		532001300	BURNER VENTURI 3,5 KW
002		533053100	AIR ADJUSTMENT BUSHING §20
002		539018900	INDEX FOR KNOB
002		533069000	BY PASS COCK §70 20S-21S
002		533069100	BY PASS COCK §60 20S
002		531025800	SAFETY TAP 20S-B PEL20S2160
002		531025900	SAFETY TAP 20S-B PEL20S21070
002		536019800	BLACK KNOB §70 PIN §8*6,5
002		539022500	ADHESIVE GRADUATED DISC FOR KNOB
002		533043400	NOZZLE §117 CH12*14 G-PC4 UR
002		533015400	NOZZLE §93 CH12*14 G-PC4 R
002		533043300	NOZZLE §103 CH12*14 F-PC4 UR
002		533015300	NOZZLE §82 CH12*14 F-PC4 R
002		533019400	NOZZLE §180 CH12*14 L-FQ5
002		533015200	NOZZLE §145 CH12*14 F-FP/CP6
002		533043600	NOZZLE §200 CH12*14 L-PC4 UR
002		533030300	NOZZLE §160 CH12*14 M-FPG
002		533043500	NOZZLE §190 CH12*14 G25 PC4R
002		533014900	NOZZLE §150 CH12*14 F-FQ5 L-FQ6