



Organismo Notificado 0370

Organismo Notificado 0099



TOLERANCIAS GENERALES: ±0.5 mm

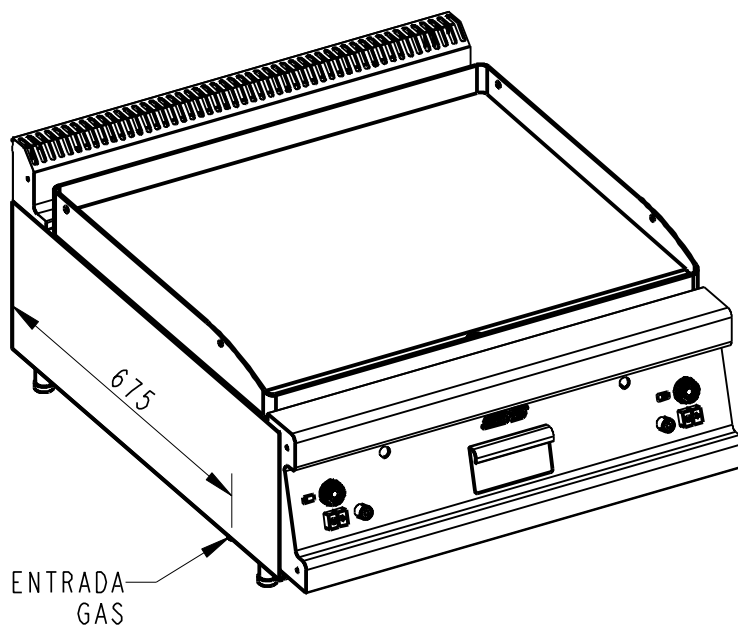
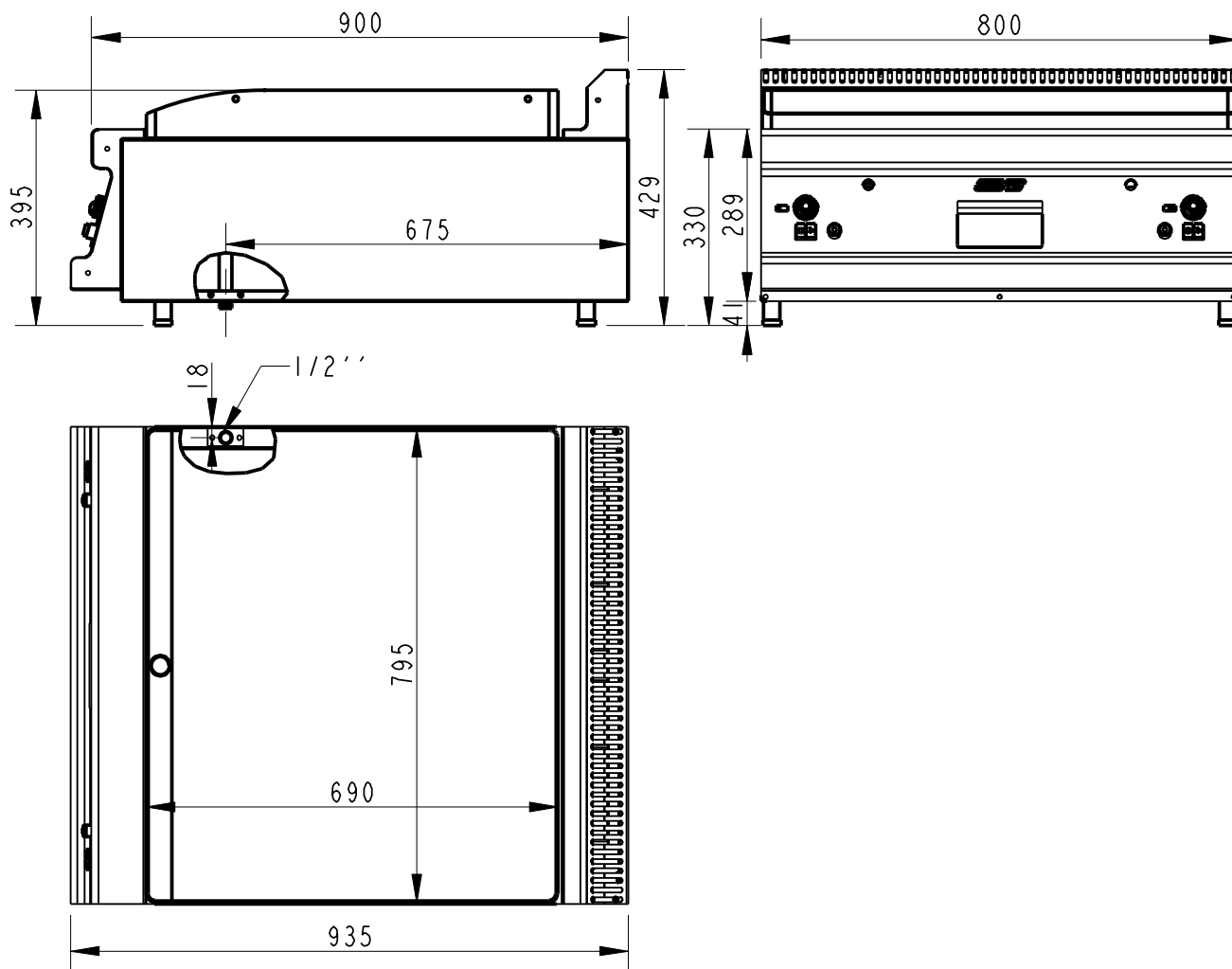

POTENCIA: 17.25 KW



FAMILIA: COCINAS 2008

FECHA: 28/01/11

MODELO: 3614S

PESO(Kg): 96.492

DENOMINACION: FRYTOP SOBREMESA GAS CR.D.800X900

ESCALA: 1/12

MATERIAL: INOX

CODIGO: 3614S



Organismo Notificado
0370

Organismo Notificado
0099



TOLERANCIAS GENERALES: ± 0.5 mm

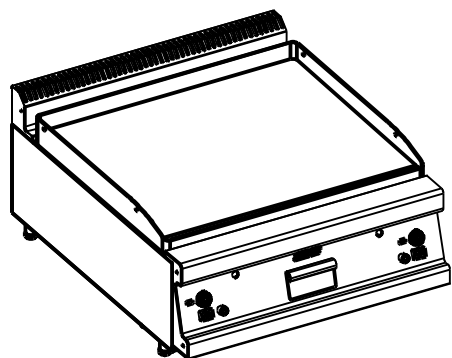

| QT | COD | DESCRIPCION |
|----|----------|---------------------------------|
| 2 | 3739 | ENCENDIDO PIEZOELECTRICO |
| 4 | 6038 | PATA REGULABLE AP. SNACK |
| 1 | 300133 | RAMPA CAÍDA ACEITE |
| 1 | 330613 | TRASERO HORNILLO 800 |
| 1 | 350565 | FRONTAL INFERIOR 800 |
| 2 | 362476 | SOPORTE VALV. MINISIT-CONTACTOR |
| 1 | 300385PC | BATERIA COMPLETA 2 VALVULAS 800 |
| 2 | 3103M | VALVULA SIT COMPLETA |
| 1 | 340122C | CONJUNTO PETO 800 |
| 1 | 340208M | CONJ. LAT. SUPERIOR 900 DCH |
| 1 | 340209M | CONJ. LAT. SUPERIOR 900 IZQ |
| 1 | 361406P | PLANCHA CR LISA 795X690 |
| 1 | 361416M | DEFLECTOR MONTADO 800X900 |
| 1 | 362149C | CONJUNTO CUBETA / CAJON FT |
| 1 | 362439C | CONJUNTO FRONTAL FT. GAS 800 |
| 2 | T06030 | TUBO AL D.6 L.300 |
| 1 | T10030 | TUBO AL D.10 L.300 |
| 1 | T10075 | TUBO AL D.10 L.750 |

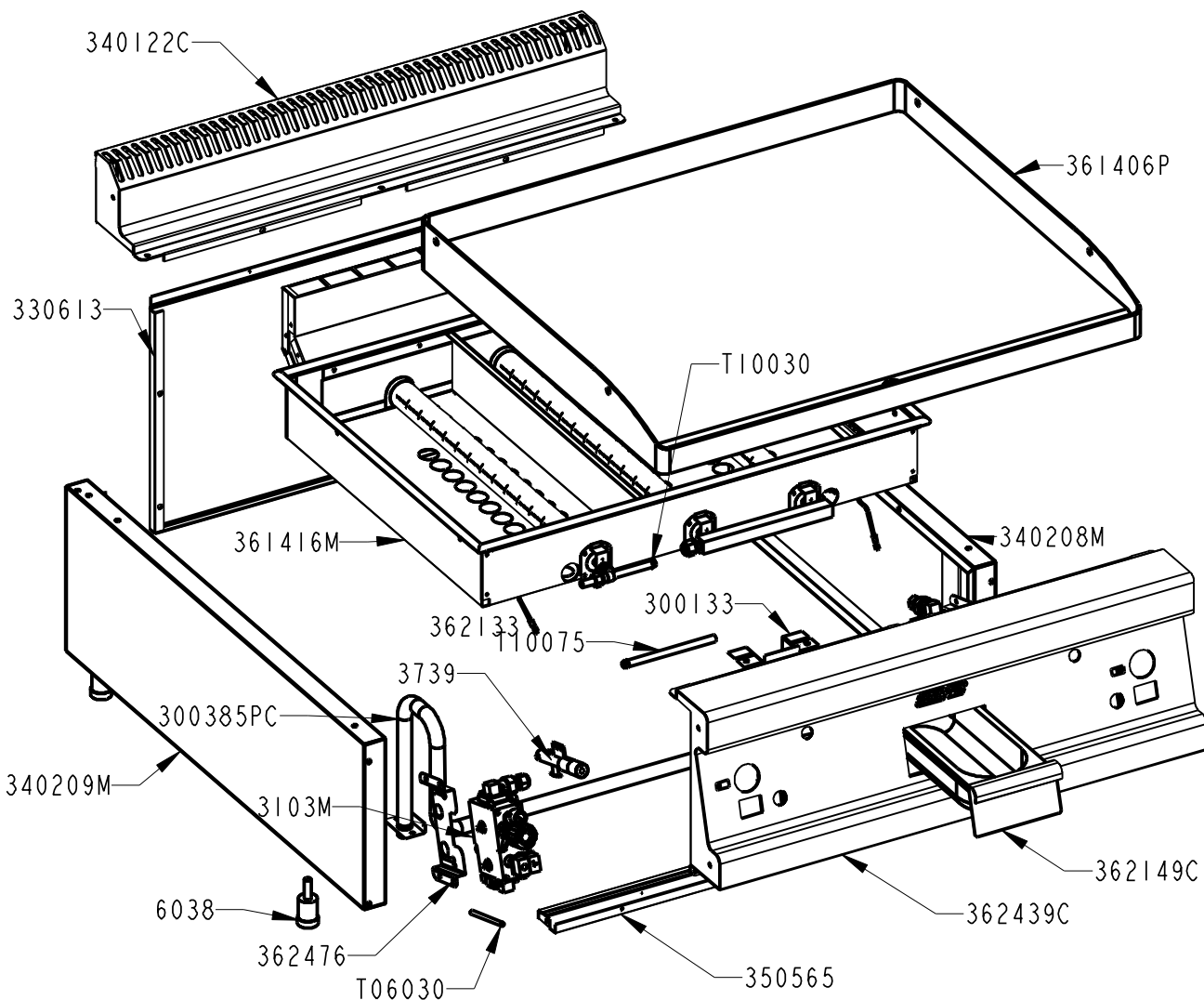

FAMILIA: COCINAS 2008

FECHA: 28/01/11

MODELO: 3614S

PESO(Kg): 96.492

DENOMINACION:
FRYTOP SOBREMESA GAS CR.D.800X900

ESCALA:
1/10

MATERIAL:
INOX

CODIGO:
3614S



Organismo Notificado
0370

Organismo Notificado
0099



TOLERANCIAS GENERALES: ±0.5 mm

| QT | COD | DESCRIPCION | FAB. | MATERIAL | DATA | PESO |
|----|----------|---------------------------------|------|------------|----------|-------|
| 1 | 300133 | RAMPA CAÍDA ACEITE | SÍ | INOFER 0.8 | 18/07/08 | 0.118 |
| 1 | 300388 | CORRELLAMAS | SÍ | INOFER 0.8 | 05/02/09 | 0.106 |
| 1 | 300399 | TAPA 20X20 C/AGUJERO D.12 | SÍ | FE 1.2 | 02/09/08 | 0.003 |
| 1 | 301399 | TAPA 20X20 | SÍ | FE 1.2 | 02/09/08 | 0.004 |
| 1 | 330294 | PLETINA BASE BATERÍA | SÍ | FE 1.5 | 03/11/08 | 0.021 |
| 1 | 330613 | TRASERO HORNILLO 800 | SÍ | i441 0.8 | 11/12/08 | 1.923 |
| 3 | 330675 | REFUERZO PATA | SÍ | GALVA 1.5 | 11/12/08 | 0.429 |
| 1 | 340122 | PETO SOBRE 800X750/900 | SÍ | INOX 1.2 | 07/04/08 | 1.597 |
| 1 | 340178 | TAPETA DERECHA PETO 750/900 | SÍ | INOFER 1.2 | 30/11/07 | 0.135 |
| 1 | 340179 | TAPETA IZQ. PETO 750/900 | SÍ | INOFER 1.2 | 30/11/07 | 0.135 |
| 1 | 340208 | LATERAL SUPERIOR 900 DCHO | SÍ | INOFER 0.8 | 10/03/09 | 2.168 |
| 1 | 340209 | LATERAL SUPERIOR 900 IZQ. | SÍ | INOFER 0.8 | 10/03/09 | 2.168 |
| 1 | 350178 | TAPETA LATERAL DERECHA FRONTAL | SÍ | INOX 1.2 | 26/06/07 | 0.109 |
| 1 | 350179 | TAPETA LATERAL IZQUIEDA FRONTAL | SÍ | INOX 1.2 | 26/06/07 | 0.109 |
| 1 | 350565 | FRONTAL INFERIOR 800 | SÍ | i441 0.8 | 15/06/10 | 0.394 |
| 1 | 361410 | SEPARADOR QUEMADORES 900 | SÍ | INOFER 1.2 | 05/05/09 | 0.623 |
| 1 | 361416 | DEFLECTOR FRYTOP 800X900 | SÍ | INOFER 0.8 | 17/01/11 | 3.744 |
| 1 | 361426 | BURLETE CERAM.800X900-C6580179 | SÍ | FIBRA | 12/03/09 | 0.294 |
| 1 | 362148 | GUIA CAJON FT(GN 2/8-65) | SÍ | INOFER 0.8 | 24/10/08 | 0.280 |
| 1 | 362149 | TIRADOR CAJON FT (GN2/8-65) | SÍ | INOX 1.2 | 19/11/07 | 0.162 |
| 2 | 362176 | SOPORTE-ADAPT.PIEZO SIT-JUNK | SÍ | i441 0.8 | 18/05/11 | 0.035 |
| 1 | 362439 | FRONTAL MANDOS FRYTOP 800 | SÍ | INOX 1.2 | 02/05/11 | 3.999 |
| 1 | 362452 | SALIDA VAHOS FT800 | SÍ | GALVA 0.8 | 01/04/09 | 1.721 |
| 2 | 362476 | SOPORTE VALV.MINISIT-CONTACTOR | SÍ | GALVA 1.5 | 24/09/08 | 0.122 |
| 2 | 362478 | TAPETA LATERAL DEFLECTOR | SÍ | GALVA 0.8 | 01/04/09 | 0.046 |
| 2 | 490133 | PROTECTOR BULBO | SÍ | INOFER 0.8 | 14/03/08 | 0.060 |
| 1 | 3306751 | REFUERZO PATA C/ENCAJE BATERIA | SÍ | GALVA 1.5 | 09/01/09 | 0.361 |
| 1 | 3621491 | SOPORTE TIRADOR CAJON FT | SÍ | INOFER 1.2 | 27/06/08 | 0.058 |
| 1 | 340122C | CONJUNTO PETO 800 | SÍ | INOX | 16/09/08 | 1.892 |
| 1 | 340208M | CONJ. LAT.SUPERIOR 900 DCH | SÍ | INOX | 17/01/11 | 3.042 |
| 1 | 340209M | CONJ. LAT.SUPERIOR 900 IZQ | SÍ | INOX | 17/01/11 | 2.973 |
| 1 | 361416M | DEFLECTOR MONTADO 800X900 | SÍ | INOX | 30/03/09 | 8.875 |
| 1 | 362149C | CONJUNTO CUBETA / CAJON FT | SÍ | INOX | 27/06/08 | 0.775 |
| 1 | 362439C | CONJUNTO FRONTAL FT.GAS 800 | SÍ | INOX | 23/10/09 | 4.641 |
| 2 | TESTA140 | ANGULO TESTATINA 140 | SÍ | INOX 0.6 | 29/08/07 | 0.016 |
| 8 | TESTA35 | ANGULO TESTATINA 35 | SÍ | INOX 0.6 | 29/08/07 | 0.004 |
| 4 | TESTA70 | ANGULO TESTATINA 70 | SÍ | INOX 0.6 | 29/08/07 | 0.008 |
| 4 | 1014 | REMACHE ROSCADO M-10 | NO | ZN | 17/12/09 | 0.008 |
| 16 | 1051 | TORNILLO ZN M4X15 DIN 84 | NO | FE ZN | 01/01/09 | 0.003 |
| 2 | 2193 | CABLE PIEZO L=370 | NO | FIBRA/CU | 21/06/12 | 0.002 |
| 2 | 3103 | VALVULA MINI SIT | NO | AL | 01/01/09 | 1.406 |
| 2 | 3739 | ENCENDIDO PIEZOELECTRICO | NO | INOX | 29/04/11 | 0.098 |
| 2 | 3765 | MANDO VALV. SIT | NO | PLASTICO | 01/01/09 | 0.014 |
| 5 | 3781 | TUERCA M16X1.5 D.10 | NO | LATON | 05/09/08 | 0.015 |
| 5 | 3782 | BICONO D.10 LATON | NO | LATON | 01/01/09 | 0.001 |
| 4 | 3785 | JUNTA VALVULA MINISIT | NO | GOMA | 01/01/09 | 0.000 |
| 4 | 6038 | PATA REGULABLE AP.SNACK | NO | BAQUELITA | 01/12/93 | 0.068 |
| 1 | 330189 | MANGUITO M16X1.5 TUBO D.10 | NO | FE | 22/09/08 | 0.007 |



FAMILIA: COCINAS 2008

FECHA: 28/01/11

MODELO: 3614S

PESO(Kg): 96.492

DENOMINACION:
FRYTOP SOBREMESA GAS CR.D.800X900

ESCALA:
1/20

MATERIAL:
INOX

CODIGO:
3614S



Organismo Notificado
0370

Organismo Notificado
0099

AENOR



TOLERANCIAS GENERALES: ±0.5 mm

| | | | | | | |
|---|-----------|---------------------------------|----|------------|----------|--------|
| 1 | 300385P | BATERÍA 2 VALVULAS 800 | NO | FE 1/2" | 13/01/09 | 0.884 |
| 1 | 300385PC | BATERIA COMPLETA 2 VALVULAS 800 | NO | FE ZINCADO | 13/01/09 | 0.916 |
| 2 | 3103M | VALVULA SIT COMPLETA | NO | AL | 05/09/08 | 1.646 |
| 3 | 361187P | QUEMADOR TUBULAR D.40 L.550 | NO | INOX | 05/08/09 | 0.566 |
| 1 | 361406P | PLANCHA CR LISA 795X690 | NO | CR 15mm | 13/01/09 | 66.874 |
| 2 | 362189P | TUBO COBRE 10X8 L.25 | NO | CU 10X8 | 13/01/09 | 0.006 |
| 4 | 362489P | MACHON D.10 - 3/8" - M16X1.5 | NO | LATON | 01/10/08 | 0.029 |
| 1 | 493086P | COLECTOR HGR | NO | FE | 07/10/08 | 0.124 |
| 1 | 493086PC | COLECTOR 2 SALIDAS HGR | NO | FE ZN. | 07/10/08 | 0.000 |
| 2 | A1018996 | RACORD BUJIA | NO | LATON | 01/01/09 | 0.004 |
| 2 | A1018997 | RACORD PILOTO | NO | LATON | 01/01/09 | 0.004 |
| 2 | A1018998 | RACORD TERMOPAR | NO | LATON | 01/01/09 | 0.004 |
| 2 | A1018999 | BICONO PILOTO | NO | LATON | 01/01/09 | 0.002 |
| 2 | C5810129 | PILOTO POLIDORO | NO | FE | 01/01/09 | 0.053 |
| 2 | C5810129M | PILOTO POLIDORO COMPLETO | NO | FE | 28/01/11 | 0.074 |
| 2 | C5810139 | BUJIA | NO | CER | 01/01/09 | 0.004 |
| 2 | C5810159 | INY.PILOTO GN (27.2) 2 AGUJ. | NO | LATON | 01/01/09 | 0.002 |
| 2 | C5810169 | INY.PILOTO GLP (22) 1 AGUJ. | NO | LATON | 01/01/09 | 0.002 |
| 4 | C5810419 | CODO 90° -3/8" SIT S/R.0906252 | NO | AL | 01/01/09 | 0.054 |
| 3 | C5812659 | INY.D.120GLP.L.550/GN.L.300 | NO | LATON | 04/09/08 | 0.012 |
| 3 | C5812679 | INY.D.180 GN QUEMADOR L.550 | NO | LATON | 04/09/08 | 0.012 |
| 1 | C5815159 | PORTAINYECTOR COMPLETO | NO | LATON | 01/01/09 | 0.058 |
| 2 | C5815359 | TUERCA+BICONO D.6 M10X1 | NO | LATON | 01/01/09 | 0.006 |
| 2 | C5820049 | TERMOPAR LISO M9X1 L 320 | NO | CU | 01/01/09 | 0.018 |
| 1 | C6440489 | CUBETA GN 2/8-65 | NO | INOX | 19/11/07 | 0.555 |
| 2 | T06030 | TUBO AL D.6 L.300 | NO | AL 99.7% | 13/05/09 | 0.009 |
| 1 | T10030 | TUBO AL D.10 L.300 | NO | AL 99.7% | 13/05/09 | 0.031 |
| 1 | T10075 | TUBO AL D.10 L.750 | NO | AL 99.7% | 13/05/09 | 0.013 |



FAMILIA: COCINAS 2008

FECHA: 28/01/11

MODELO: 3614S

PESO(Kg): 96.492

DENOMINACION:
FRYTOP SOBREMESA GAS CR.D.800X900

ESCALA:
1/20

MATERIAL:
INOX

CODIGO:
3614S



Organismo Notificado 0370

Organismo Notificado 0099



TOLERANCIAS GENERALES: ±0.5 mm

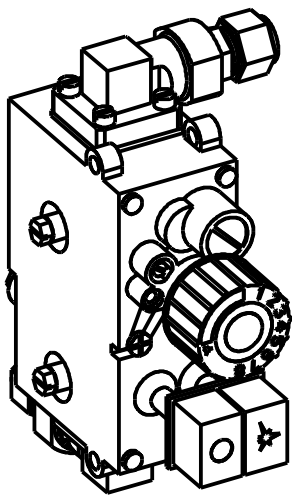

| QT | COD | DESCRIPCION |
|----|----------|---------------------------------|
| 8 | 1051 | TORNILLO ZN M4X15 DIN 84 |
| 1 | 3103 | VALVULA MINI SIT |
| 1 | 3765 | MANDO VALV. SIT |
| 2 | 3781 | TUERCA M16X1.5 D.10 |
| 2 | 3782 | BICONO D.10 LATON |
| 2 | 3785 | JUNTA VALVULA MINISIT |
| 2 | 362489P | MACHON D.10 - 3/8" - M16X1.5 |
| 2 | C5810419 | CODO 90° - 3/8" SIT S/R.0906252 |
| 1 | C5815359 | TUERCA+BICONO D.6 M10X1 |

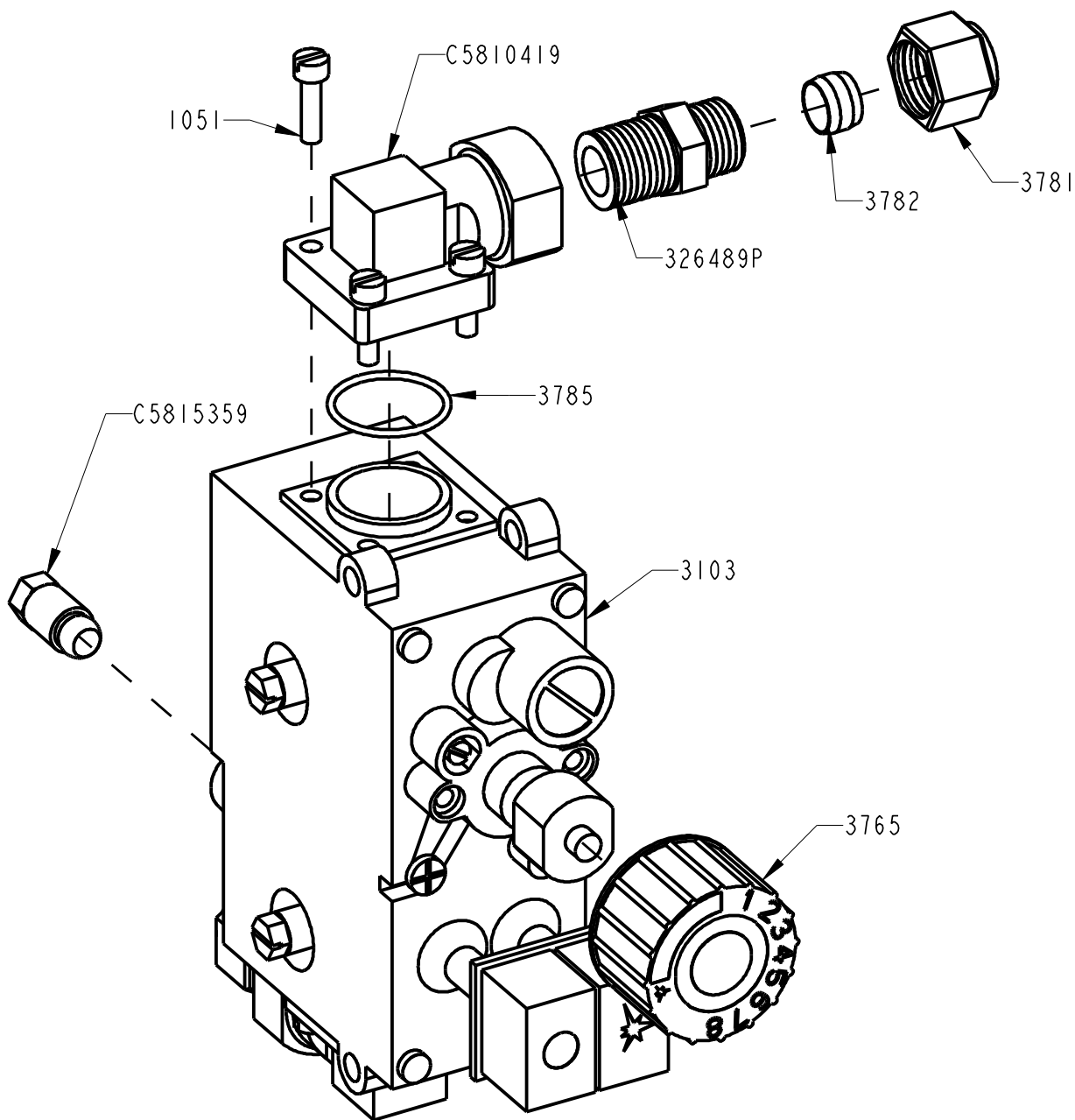

FAMILIA: COCINAS 2008

FECHA: 05/09/08

MODELO: 3611

PESO(Kg): 1.646

DENOMINACION:
VALVULA SIT COMPLETA

ESCALA:
1/2

MATERIAL:
AL

CODIGO:
3103M



Organismo Notificado
0370

Organismo Notificado
0099



TOLERANCIAS GENERALES: ±0.5 mm

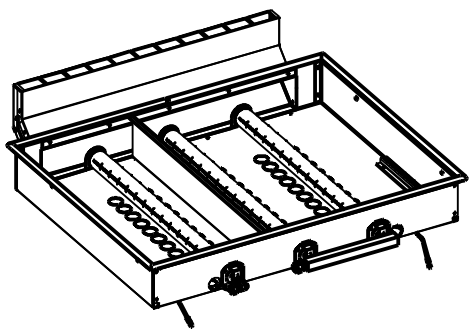

| QT | COD | DESCRIPCION |
|----|-----------|--------------------------------|
| 2 | 2193 | CABLE PIEZO L=370 |
| 1 | 3781 | TUERCA M16X1.5 D.10 |
| 1 | 3782 | BICONO D.10 LATON |
| 1 | 300388 | CORRELLAMAS |
| 1 | 361410 | SEPARADOR QUEMADORES 900 |
| 1 | 361416 | DEFLECTOR FRYTOP 800X900 |
| 1 | 361426 | BURLETE CERAM.800X900-C6580179 |
| 1 | 362452 | SALIDA VAHOS FT800 |
| 2 | 362478 | TAPETA LATERAL DEFLECTOR |
| 2 | 490133 | PROTECTOR BULBO |
| 3 | 361187P | QUEMADOR TUBULAR D.40 L.550 |
| 1 | 493086PC | COLECTOR 2 SALIDAS HGR |
| 2 | C5810129M | PILOTO POLIDORO COMPLETO |
| 3 | C5812659 | INY.D.120GLP.L.550/GN.L.300 |
| 3 | C5812679 | INY.D.180 GN QUEMADOR L.550 |
| 1 | C5815159 | PORTAINYECTOR COMPLETO |
| 2 | C5820049 | TERMOPAR LISO M9XI L 320 |

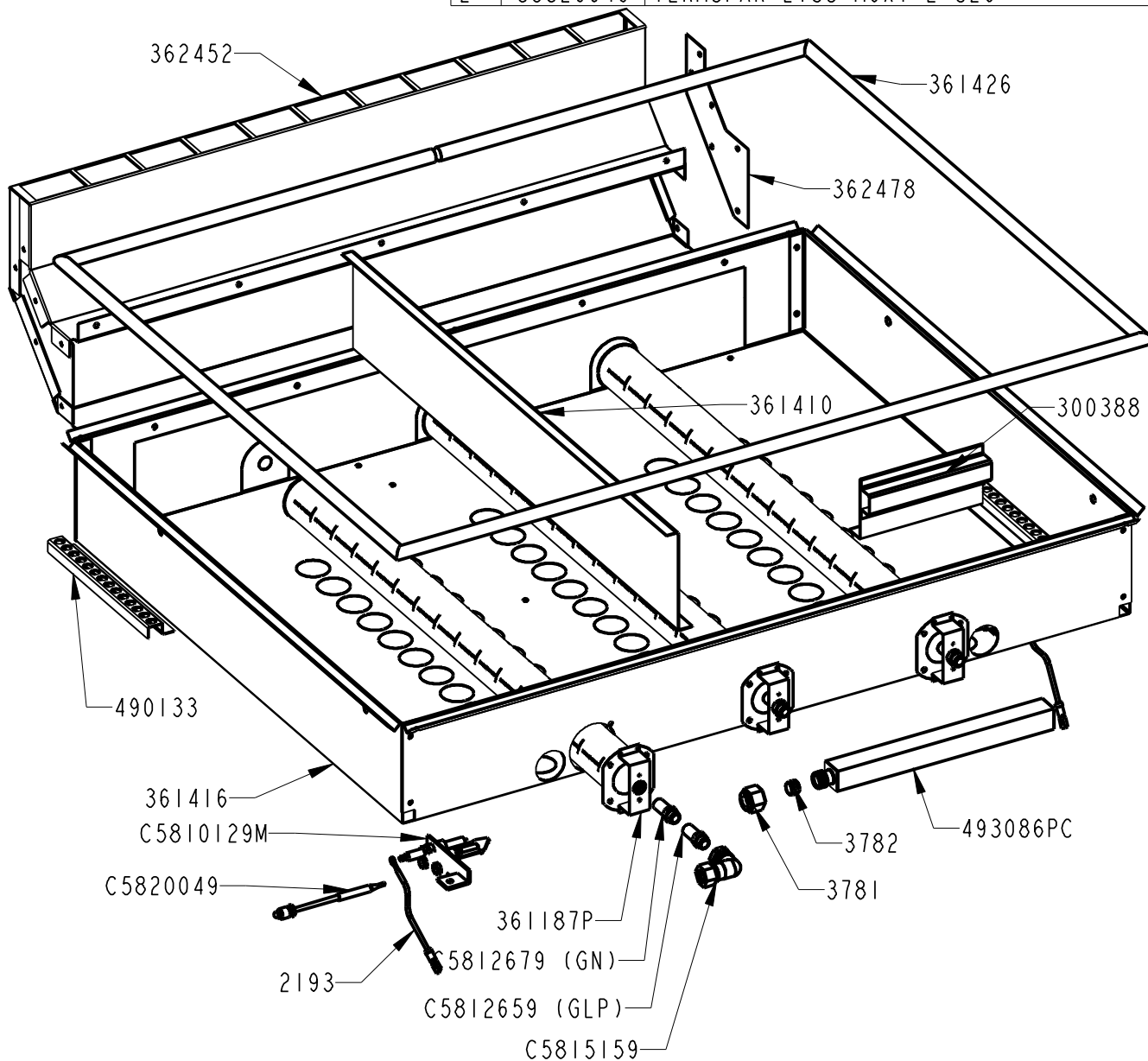

FAMILIA: COCINAS 2008

FECHA: 30/03/09

MODELO: 3614

PESO(Kg): 8.875

DENOMINACION:
DEFLECTOR MONTADO 800X900

ESCALA:
1/5

MATERIAL:
INOX

CODIGO:
361416M



Organismo Notificado 0370

Organismo Notificado 0099



TOLERANCIAS GENERALES: ±0.5 mm

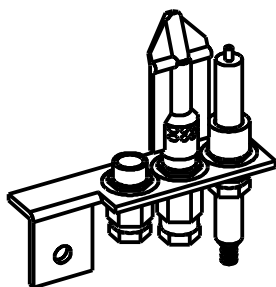

ESCALA 1/2

| QT | COD | DESCRIPCION |
|----|----------|------------------------------|
| 1 | A1018999 | BICONO PILOTO |
| 1 | C5810139 | BUJIA |
| 1 | C5810169 | INY.PILOTO GLP (22) 1 AGUJ. |
| 1 | C5810159 | INY.PILOTO GN (27.2) 2 AGUJ. |
| 1 | C5810129 | PILOTO POLIDORO |
| 1 | A1018996 | RACORD BUJIA |
| 1 | A1018997 | RACORD PILOTO |
| 1 | A1018998 | RACORD TERMOPAR |

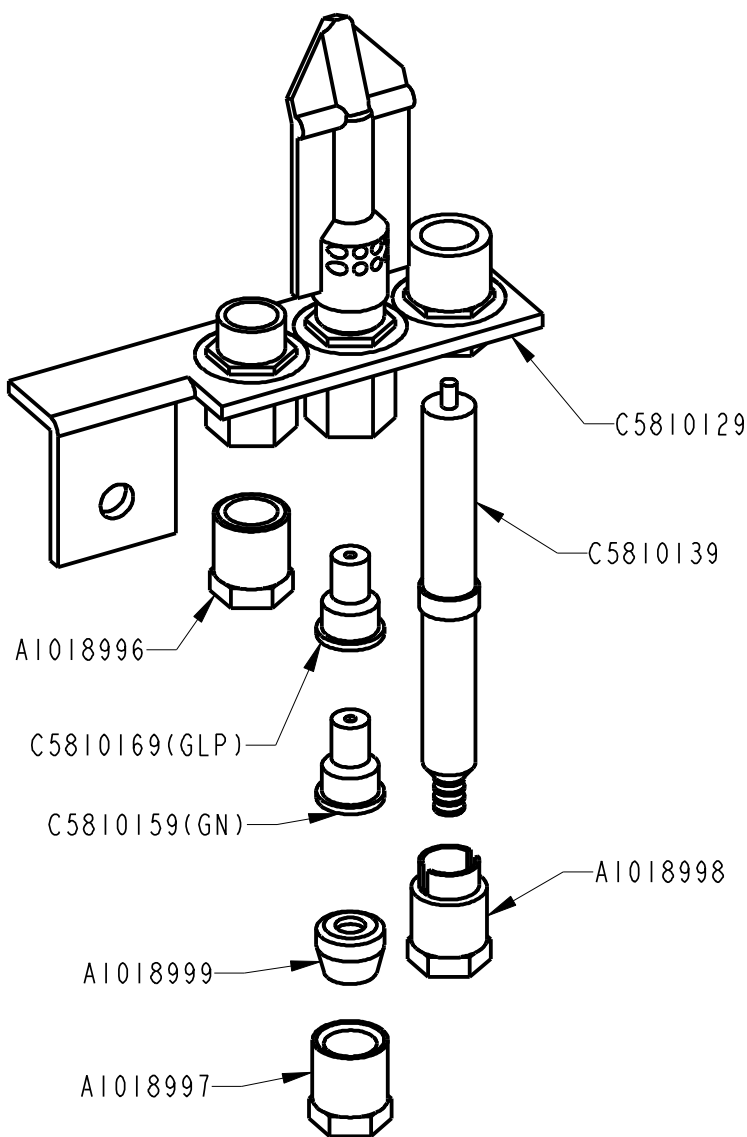

FAMILIA: COCINAS 2008

FECHA: 28/01/11

MODELO: 3611

PESO(Kg): 0.074

DENOMINACION:
PILOTO POLIDORO COMPLETO

ESCALA:
1/1

MATERIAL:
FE

CODIGO:
C5810129M



4785/ER/11/05



MUY IMPORTANTE:
PONER FIBRA ENTRE:
361410-361416E
361415-361416E
361433E-361416E

| CANT. | CODIGO | DESCRIPCION |
|-------|---------|--|
| 1 | 361410 | LATERAL IZQ. DEFLECTOR 900 |
| 2 | 361415 | LATERAL DCHO. DEFLECTOR 900 |
| 4 | 361187P | QUEMADOR TUBULAR D.40 L.550 |
| 1 | 361416E | DEFLECTOR FRYTOP 800X900 ESP. |
| 1 | 361433E | PROTECTOR INTERIOR SUPERIOR FT.800 |
| 1 | 362439E | FRONTAL MANDOS FRYTOP 800x750/900 ESP. |

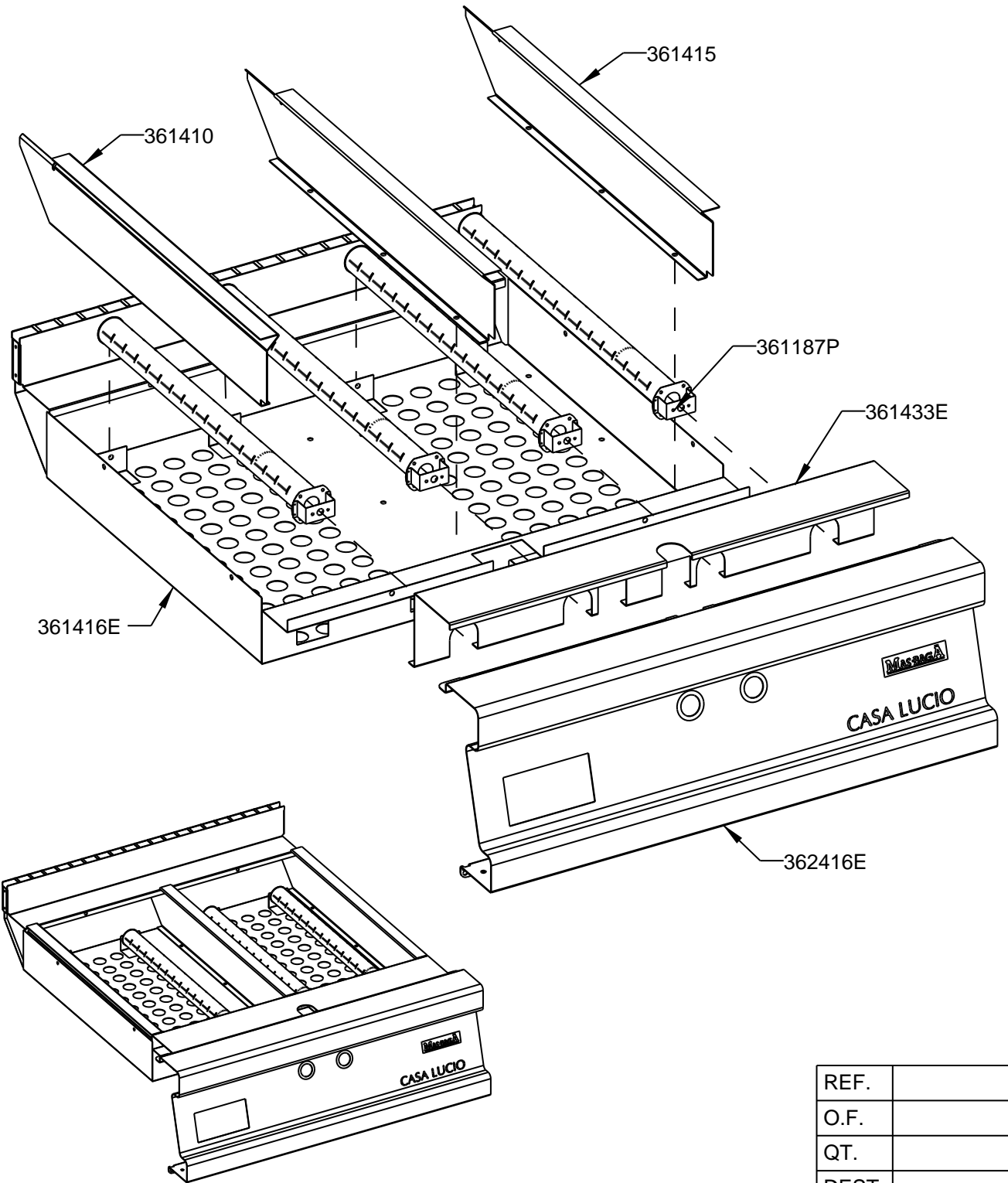

TOLERANCIAS GENERALES: ±0.1 mm

macfrin
group
COOKING SYSTEMS,SL

FAMILIA: COCINAS 2008

MODELO: 3614E

| | |
|-------|--|
| REF. | |
| O.F. | |
| QT. | |
| DEST. | |

DATA:
13/05/08

DENOMINACION:
CONJDEFLECTOR-FRONTAL FT.800X900 ESP.

ESCALA:
1/8

MATERIAL:
INOFER

PROGRAMA:
3614-16-E-M



Applus®
LGA1
Organismo
Notificado
0370

AENOR
Organismo
Notificado
0099



TOLERANCIAS GENERALES: ±0.5 mm

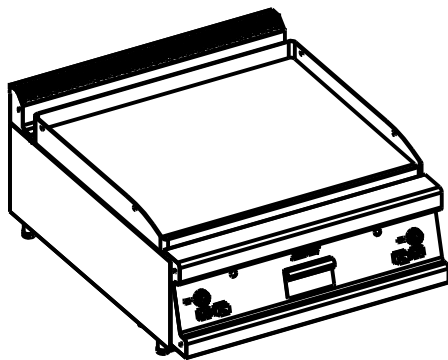

| QT | COD | DESCRIPCION |
|----|----------|---------------------------------|
| 2 | 3747 | PIEZO ELECTRICO SIT |
| 4 | 6038 | PATA REGULABLE AP.SNACK |
| 1 | 300133 | RAMPA CAÍDA ACEITE |
| 1 | 330613 | TRASERO HORNILLO 800 |
| 1 | 350565 | FRONTAL INFERIOR 800 |
| 2 | 362133 | PROTECTOR PIEZO ELECTRICO |
| 2 | 362476 | SOPORTE VALV.MINISIT-CONTACTOR |
| 1 | 300385PC | BATERIA COMPLETA 2 VALVULAS 800 |
| 2 | 3103M | VALVULA SIT COMPLETA |
| 1 | 340122C | CONJUNTO PETO 800 |
| 1 | 340208M | CONJ. LAT.SUPERIOR 900 DCH |
| 1 | 340209M | CONJ. LAT.SUPERIOR 900 IZQ |
| 1 | 361406P | PLANCHA CR LISA 795X690 |
| 1 | 361416M | DEFLECTOR MONTADO 800X900 |
| 1 | 362149C | CONJUNTO CUBETA / CAJON FT |
| 1 | 362439C | CONJUNTO FRONTAL FT.GAS 800 |
| 2 | T06030 | TUBO AL D.6 L.300 |
| 1 | T10030 | TUBO AL D.10 L.300 |
| 1 | T10075 | TUBO AL D.10 L.750 |

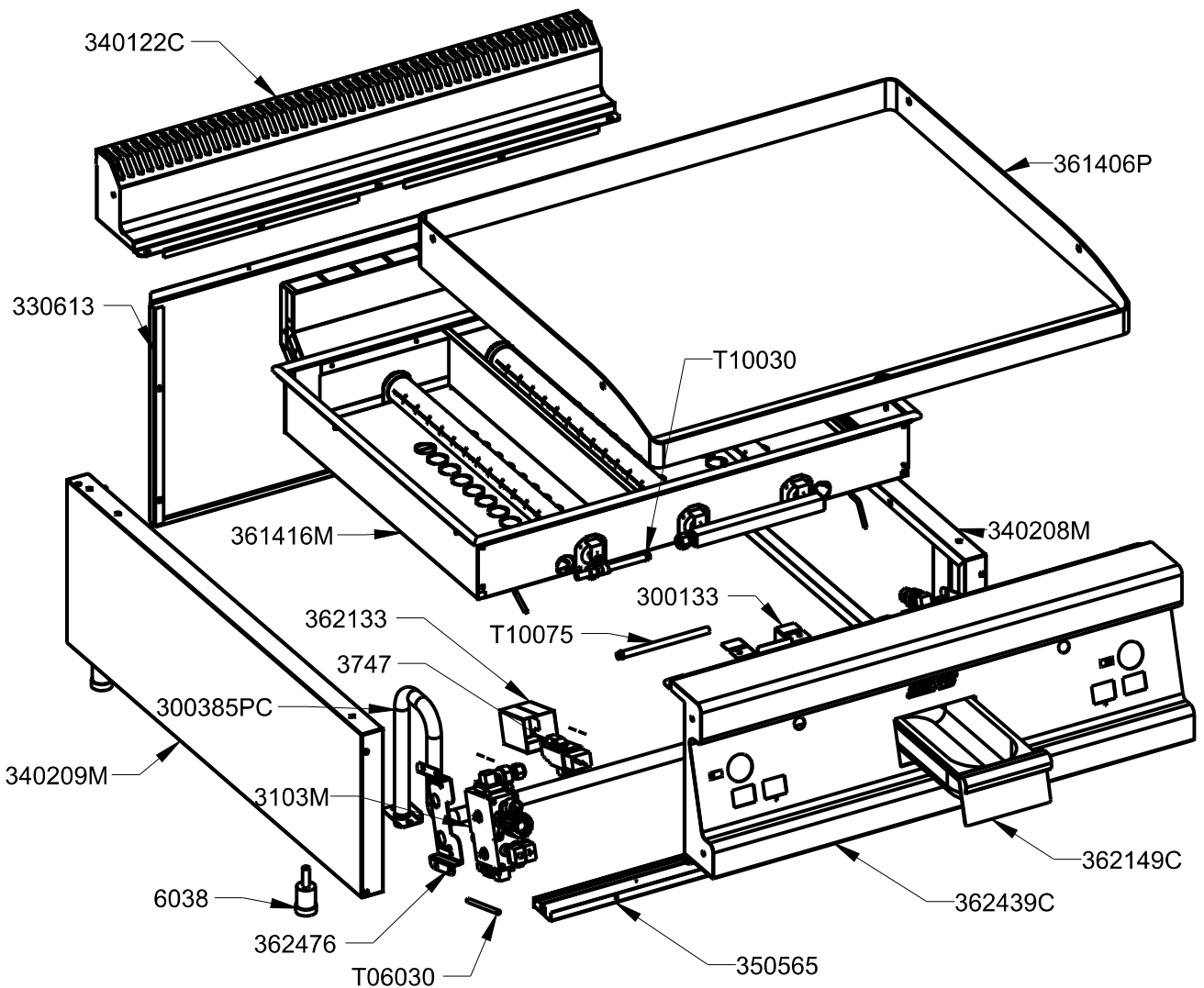

FAMILIA: COCINAS 2008

FECHA: 28/01/11

MODELO: 3614S

PESO(Kg): 95.107

DENOMINACION:
FRYTOP SOBREMESA GAS CR.D.800X900

ESCALA:
1/10

MATERIAL:
INOX

CODIGO:
3614S