

MAGIC SNACK 60

GAS / GAS / GAS / GAZ

FT...-61G... FT...-62G... FT...-63G... FT...-64G...

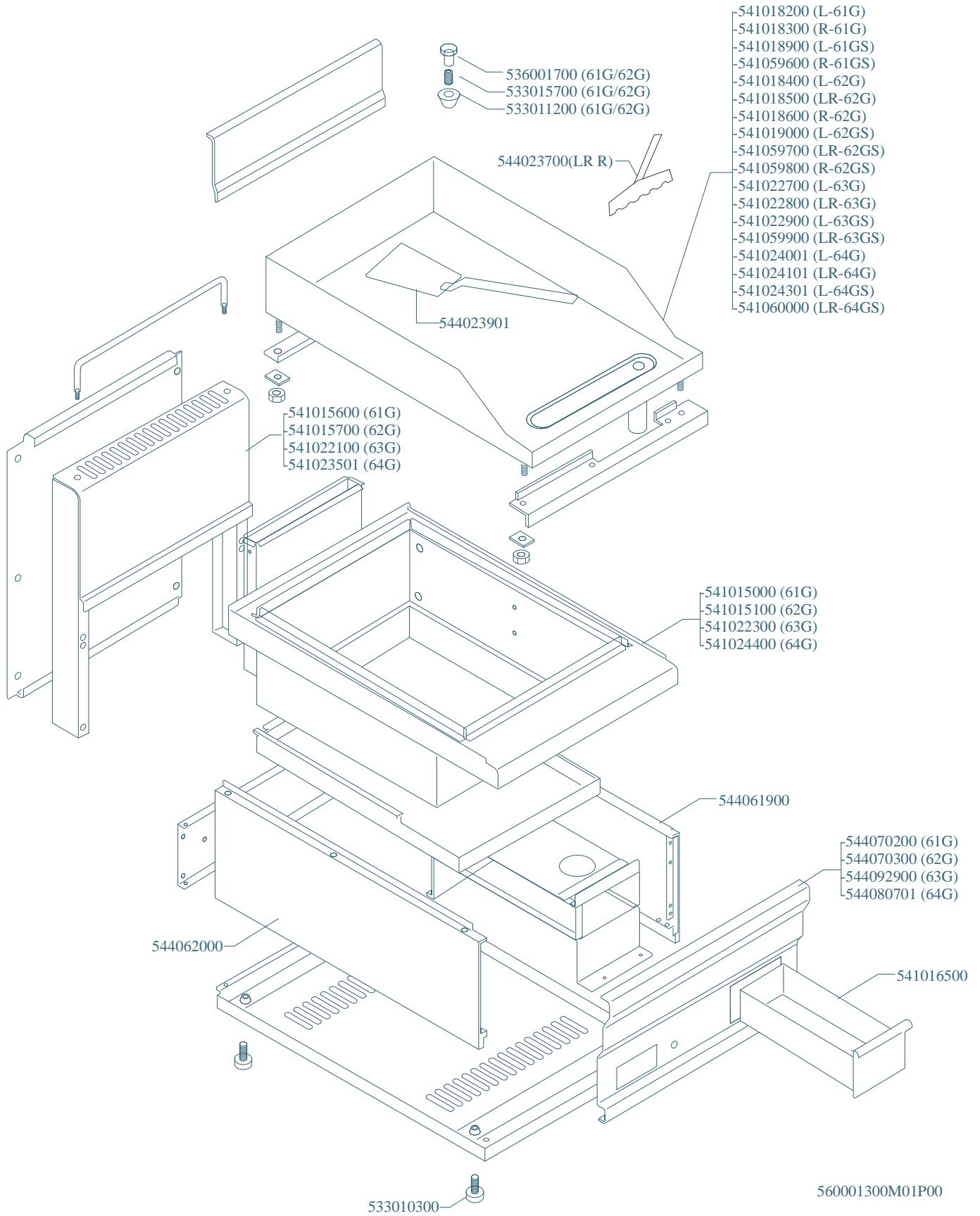

MAGIC SNACK 60

GAS / GAS / GAS / GAZ

FT...-61G... FT...-62G... FT...-63G... FT...-64G...

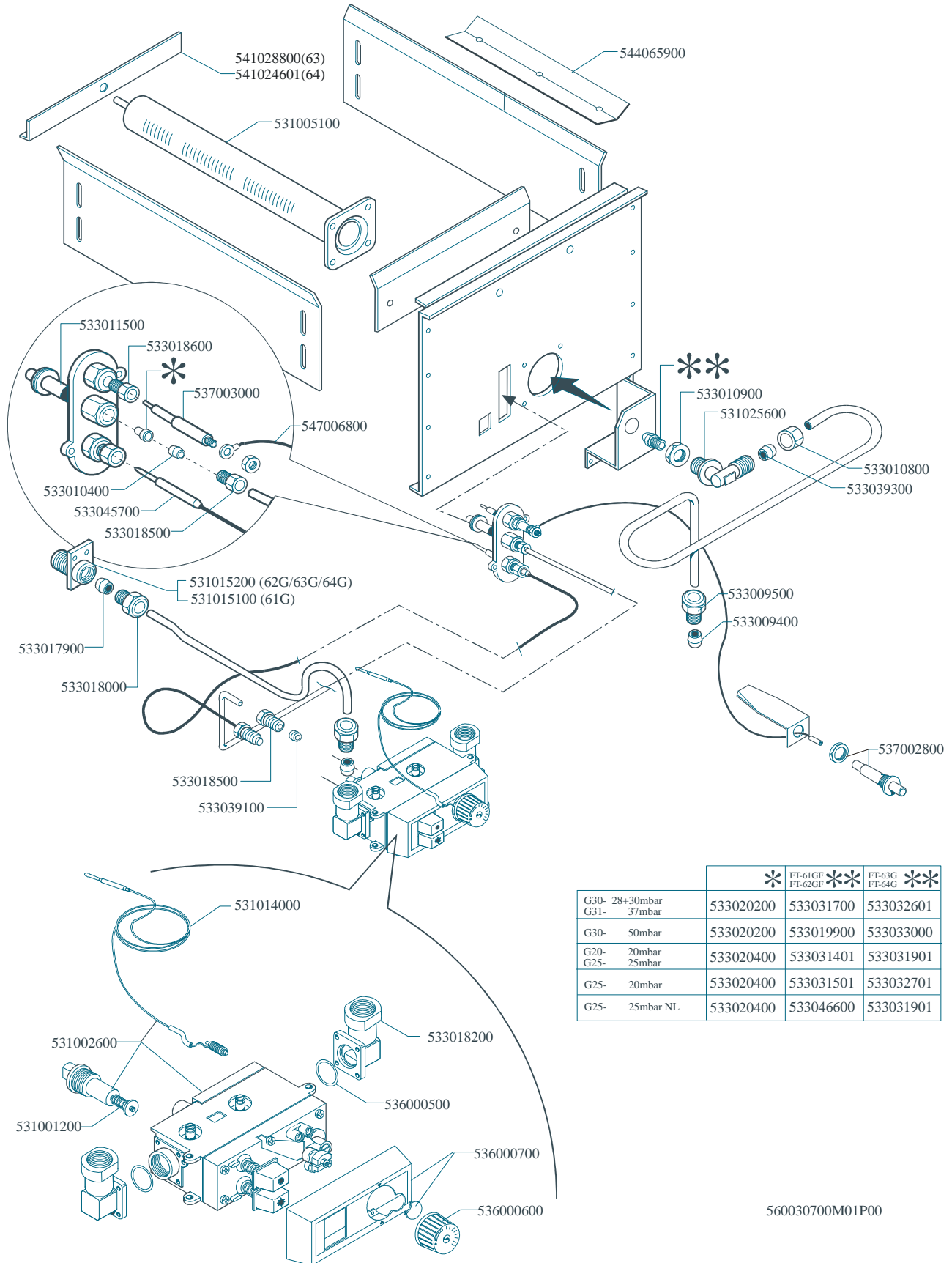

		* FT-61GF FT-62GF *	FT-63G FT-64G *
G30- 28+30mbar G31- 37mbar	533020200	533031700	533032601
G30- 50mbar	533020200	533019900	533033000
G20- 20mbar G25- 25mbar	533020400	533031401	533031901
G25- 20mbar	533020400	533031501	533032701
G25- 25mbar NL	533020400	533046600	533031901

560030700M01P00

Page	Pos	Code	Description
001		541018900	CHROME SMOOTH PLATE FTL-61G
001		536001700	GRIP D.25*19*M6
001		533015700	HEADLESS SCREW M6*20
001		533011200	SCREW PLUG FOR DRAIN FT-61
001		544023901	SPATTLE FOR FRY-TOP
001		541015600	PERFORATED SPACER 61
001		541015000	UPPER PLATE FT-61G
001		544061900	RIGHT SIDE PANEL 60 LINE
001		544070200	CONTROL PANEL FT-61G
001		541016500	DRIP TRAY FT-61
001		544062000	LEFT SIDE PANEL 60 LINE
001		533010300	ADJUSTABLE FOOT M10*20 D.23
002		544065900	
002		531005100	BURNER 511/11
002		533011500	PILOT BURNER 2 FLAMES 220
002		533018600	PLUG FITTING
002		537003000	PLUG M4 - LONG ELECTRODE
002		547006800	HIGH-VOLTAGE CABLE OCC.§4-TUBE§2 L7
002		533010400	BICONE D.6
002		533045700	THERMOCOUPLE M9*1 500
002		533018500	FITTING FOR BICONE D.6 M10*1
002		533010900	NUT M14*1 H.4
002		531025600	ELBOW 90° NOZZLE-HOLDER §10 PIPE
002		533010800	TUBE NUT D.10 M16*1,5
002		533039300	BICONE §10
002		533009500	NIPPLE FOR BICONE 10S
002		533009400	BICONE 10S
002		537002800	PIEZOELECTRIC IGNITION M18
002		531015100	FITTING 1/2"G - 3/8" G
002		533017900	BICONE D.12
002		533018000	ELBOW FOR BICONE D.12 3/8 RS L20
002		533039100	BICONE §6
002		531014000	VALVE CAPILLARY PROBE - FT
002		533018200	ELBOW OR GJ 3/8
002		536000500	O-RING FOR MINISIT FITTING
002		536000700	PLASTIC COVER FOR MINISIT + SCREW
002		536000600	BLACK LHD KNOB OP. FOR MINISIT
002		531002600	MINISIT VALVE FO S/RP
002		531001200	MAGNET AC/2-MINISIT
002		533020200	PILOT JETS 0160 FOR LPG §30
002		533020400	NOZZLE 0160 (NATURAL GAS) 51
002		533031700	NOZZLE §105 CH-12*30 G30 CE GFT6
002		533019900	NOZZLE §90 G-FT3 F-FT-B2
002		533031401	NOZZLE §155 CH12X30 G20 MH-B2/FT
002		533031501	NOZZLE §170 CH12X30,0
002		533046600	NOZZLE §161 G25